

MATRIX

AURA SERIES

G3-MS20  
G3-MS24

G3-MS40  
G3-MS50

G3-MS51  
G3-MS52

G3-MS53  
G3-MS80

G3-MS00





# PRODUCT INFORMATION

## IMPORTANT SAFETY INFORMATION

It is the sole responsibility of the purchaser of MATRIX products to instruct all individuals, whether they are the end user or supervising personnel on proper usage of the equipment.

It is recommended that all users of MATRIX exercise equipment be informed of the following information prior to its use.

Do not use any equipment in any way other than designed or intended by the manufacturer. It is imperative that MATRIX equipment be used properly to avoid injury.

## INSTALLATION

1. **STABLE AND LEVEL SURFACE:** MATRIX exercise equipment must be installed on a stable base and properly leveled.
2. **SECURING EQUIPMENT:** **Manufacturer recommends that all stationary MATRIX strength equipment be secured to the floor to stabilize equipment and eliminate rocking or tipping over. This must be performed by a licensed contractor.**
3. Under no circumstances should you slide equipment across the floor due to risk of tipping. Use proper materials handling techniques and equipment recommended by OSHA.

All anchor points must be able to withstand 750 lbs. (3.3 kN) pull-out force.

## MAINTENANCE

1. DO NOT use any equipment that is damaged and or has worn or broken parts. Use only replacement parts supplied by your country's local MATRIX dealer.
2. **MAINTAIN LABELS AND NAMEPLATES:** Do not remove labels for any reason. They contain important information. If unreadable or missing, contact your MATRIX dealer for a replacement.
3. **MAINTAIN ALL EQUIPMENT:** Preventative maintenance is the key to smooth operating equipment as well as keeping your liability to a minimum. Equipment needs to be inspected at regular intervals.
4. Ensure that any person(s) making adjustments or performing maintenance or repair of any kind is qualified to do so. MATRIX dealers will provide service and maintenance training at our corporate facility upon request.

## ADDITIONAL NOTES

This equipment should only be used in supervised areas where access and control is specifically regulated by the owner. It is up to the owner to determine who is allowed access to this training equipment. The owner should consider a user's: degree of reliability, age, experience, etc.

This training equipment meets industry standards for stability when used for its intended purpose in accordance with the instructions provided by the manufacturer.

This equipment is for indoor use only. This training equipment is a Class S product (designed for use in a commercial environment such as a fitness facility). This training equipment is in compliance with EN 957-1 and the relevant portions of EN 957-2 and EN 957-4.

## UNPACKING

Thank you for purchasing a MATRIX Fitness product. It is inspected before it is packaged. It is shipped in multiple pieces to facilitate the compact packaging of the machine. Prior to assembly, confirm all the components by matching them with the exploded diagrams. Carefully unpack the unit from this box and dispose of the packing materials in accordance with your local laws. Exercise device must be assembled by a trained assembly team or be pre-assembled prior to delivery.

## CAUTION

To avoid injury to yourself and prevent damage to the frame components, be sure to have proper assistance removing the frame pieces from this box. Please be sure to install the equipment on a stable base, and properly level the machine. Ensure a minimum clearance width of 0.6 meters (24") for access to and passage around MATRIX strength equipment. Please note, 0.91 meters (36") is the ADA recommended clearance width for individuals in wheelchairs.

## WARRANTY

For North America, please visit [matrixfitness.com](http://matrixfitness.com) for warranty information along with warranty exclusions and limitations.



## WARNING

**DEATH OR SERIOUS INJURY CAN OCCUR ON THIS EQUIPMENT. FOLLOW THESE PRECAUTIONS TO AVOID INJURY!**

1. Keep children under the age of 14 away from this strength training equipment. Teenagers must be supervised at all times while using this equipment.
2. This equipment is not intended for use by persons with reduced physical, sensory or mental capabilities, or lack of experience and knowledge, unless they have been given supervision or instruction concerning use of the equipment by a person responsible for their safety.
3. All warnings and instructions should be read and proper instruction obtained prior to use. Use this equipment for its intended purpose ONLY.
4. Inspect the machine before use. DO NOT use machine if it appears damaged or inoperable.
5. Do not exceed weight capacity of this equipment.
6. Check to see that the selector pin is completely inserted into the weight stack.
7. NEVER use the machine with the weight stack pinned in an elevated position.
8. NEVER use dumbbells or other means to incrementally increase the weight resistance. Only use the means provided directly from the manufacturer.
9. Injuries to health may result from incorrect or excessive training. Cease exercise if you feel faint or dizzy. Obtain a medical exam before beginning an exercise program.
10. Keep body, clothing, hair, and fitness accessories free and clear of all moving parts.
11. Adjustable stops, where provided, must be used at all times.
12. When adjusting any adjustable mechanism (stop position, seat position, pad location, range of motion limiter, pulley carriage, or any other type), make certain that the adjustable mechanism is fully engaged prior to use to prevent unintended motion.
13. Manufacturer recommends that this equipment be secured to the floor to stabilize and eliminate rocking or tipping over. Use a licensed contractor.
14. If equipment is NOT secured to floor: NEVER allow resistance straps, ropes or other means to be attached to this equipment, as this may result in serious injury. NEVER use this equipment for support during stretching, as this may result in serious injury.
15. DO NOT REMOVE THIS LABEL. REPLACE IF DAMAGED OR ILLEGIBLE.



## WARNING

**NOT a stand-alone unit.  
MUST be connected to  
other units in a  
Matrix-approved  
configuration for  
added stability.**



# PRODUCT INFORMATION

## PROPER USAGE

1. Do not exceed weight limits of the exercise device.
2. If applicable, set safety stops to appropriate height.
3. If applicable, adjust seat pads, leg pads, foot pads, range of motion adjustment, or any other type of adjustment mechanisms to a comfortable start position. Make certain that the adjusting mechanism is fully engaged to prevent unintentional movement and to avoid injury.
4. Sit on bench (if applicable) and get into appropriate position for exercise.
5. Exercise using no more weight than you can safely lift and control.
6. In a controlled manner, perform exercise.
7. Return weight to its fully-supported start position.

## TORQUE VALUES

M12 Bolt (Nyloc Nut & Flowdrill)	135 Nm / 100 ft-lbs
M10 Bolt (Nyloc Nut & Flowdrill)	77 Nm / 57 ft -lbs
M8 Bolts	25 Nm / 18 ft-lbs
M8 Plastic	15 Nm / 11 ft-lbs
M6 Bolts	15 Nm / 11 ft-lbs
Pad Bolts	10 Nm / 7 ft-lbs

## PRODUCT SPECIFICATIONS

	G3-MS24 Adjustable Pulley	G3-MS51 Lat Pulldown	G3-MS52 Triceps Pressdown	G3-MS53 Low Row	G3-MS20 Adjustable Cable Crossover	G3-MS40 4-Stack Multi-station	G3-MS50 5-Stack Multi-station	G3-MS80 8-Stack Multi-station	G3-MS00 Blank Station
Max User Weight	136 kg / 300 lbs								
Product Weight	181 kg / 398.5 lbs	252 kg / 556 lbs	171.5 kg / 377.5 lbs	260 kg / 573 lbs	399 kg / 880 lbs	998 kg / 2200 lbs	1197 kg / 2640 lbs	1996 kg / 4400 lbs	57.5 kg / 127 lbs
Overall Dimensions (L x W x H)*	68 x 70 x 240 cm / 27 x 28 x 94.5"	140 x 120 x 252 cm/ 55 x 47.5 x 99.5"	85 x 59 x 240 cm / 33.5 x 23.5 x 94.5"	230 x 71 x 240 cm / 91 x 28 x 94.5"	397.4 x 90 x 239.6 cm / 156.5 x 35.4 x 94.3"	167.8 x 369.8 x 252 cm / 66.1 x 145.6 x 99.2"	481.5 x 369.8 x 251.7 cm / 189.6 x 145.6 x 99.1"	561.3 x 369.8 x 251.7 cm / 221 x 145.6 x 99.1"	67.5 x 34.5 x 240 cm / 26.5 x 13.5 x 94.5"
Weight stack	91 kg / 200 lbs	134 kg / 295 lbs	91 kg / 200 lbs	134 kg / 295 lbs	2 x 91 kg / 2 x 200 lbs	2 x 91 kg, 2 x 134 kg / 2 x 200 lbs, 2 x 295 lbs	3 x 91 kg, 2 x 134 kg / 3 x 200 lbs, 2 x 295 lbs	4 x 91 kg, 4 x 134 kg / 4 x 200 lbs, 4 x 295 lbs	N/A

\* Ensure a minimum clearance width of 0.6 meters (24") for access to and passage around MATRIX strength equipment. Please note, 0.91 meters (36") is the ADA recommended clearance width for individuals in wheelchairs.

## MAINTENANCE CHECKLIST

ACTION	FREQUENCY
Clean Upholstery <sup>1</sup>	Daily
Inspect Cables <sup>2</sup>	Daily
Clean Guide Rods	Monthly
Inspect Hardware	Monthly
Inspect Frame	Bi-Annually
Clean Machine	As Needed
Clean Grips <sup>1</sup>	As Needed
Lubricate Guide Rods <sup>3</sup>	As Needed

<sup>1</sup> Upholstery & Grips should be cleaned with a mild soap and water or a non-ammonia based cleaner.

<sup>2</sup> Cables should be inspected for cracks or frays and immediately replaced if present. If excessive slack exists cable should be tightened without lifting the head plate.

<sup>3</sup> Guide rods should be lubricated with Teflon based lubricant. Apply the lubricant to a cotton cloth and then apply up and down the guide rods.



## G3-MS00

### TECH SPECS

Maximum Training Weight	–
Product Weight	57.5 kg / 127 lbs
Overall Dimensions (L x W x H)*	67.5 x 34.5 x 240 cm / 26.5 x 13.5 x 94.5"
* Ensure a minimum clearance width of 914 mm / 36" for access to and passage around MATRIX strength equipment.	

### BLANK STATION

This product is shipped fully assembled. No user assembly is required.

If a 4-stack includes a G3-MS00 Blank Station, it must follow one of these configurations to be a free-standing unit:

- At least 2 of the remaining 3 stations must be a G3-MS51 Lat Pulldown.
- At least 2 of the remaining 3 stations must be G3-MS53 Low Row.
- At least 2 of the remaining 3 stations must include a G3-MS51 Lat Pulldown & a G3-MS53 Low Row.

If a 5-stack includes a G3-MS00 Blank Station, it must follow one of these configurations to be a free-standing unit:

- The 2 remaining stations must be G3-MS51 Lat Pulldowns.
- The 2 remaining stations must be G3-MS53 Low Rows.
- The 2 remaining stations must be a G3-MS51 Lat Pulldown & a G3-MS53 Low Row.

If an 8-stack includes G3-MS00 Blank Stations, each pod of 4 stations containing the Blank Station must conform to one of the three configurations outlined in the 5-stack requirements to qualify as a free-standing unit.

**If any of the multi-station stacks do not follow one of these configurations, the unit will need to be bolted down.**





# G3-MS24

## TECH SPECS

Maximum Training Weight	91 kg / 200 lbs
Product Weight	90 kg / 199 lbs
Overall Dimensions (L x W x H)*	68 x 70 x 240 cm / 27 x 28 x 94.5"
* Ensure a minimum clearance width of 914 mm / 36" for access to and passage around MATRIX strength equipment.	

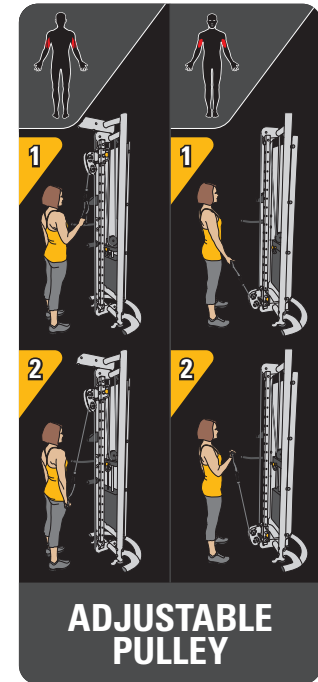
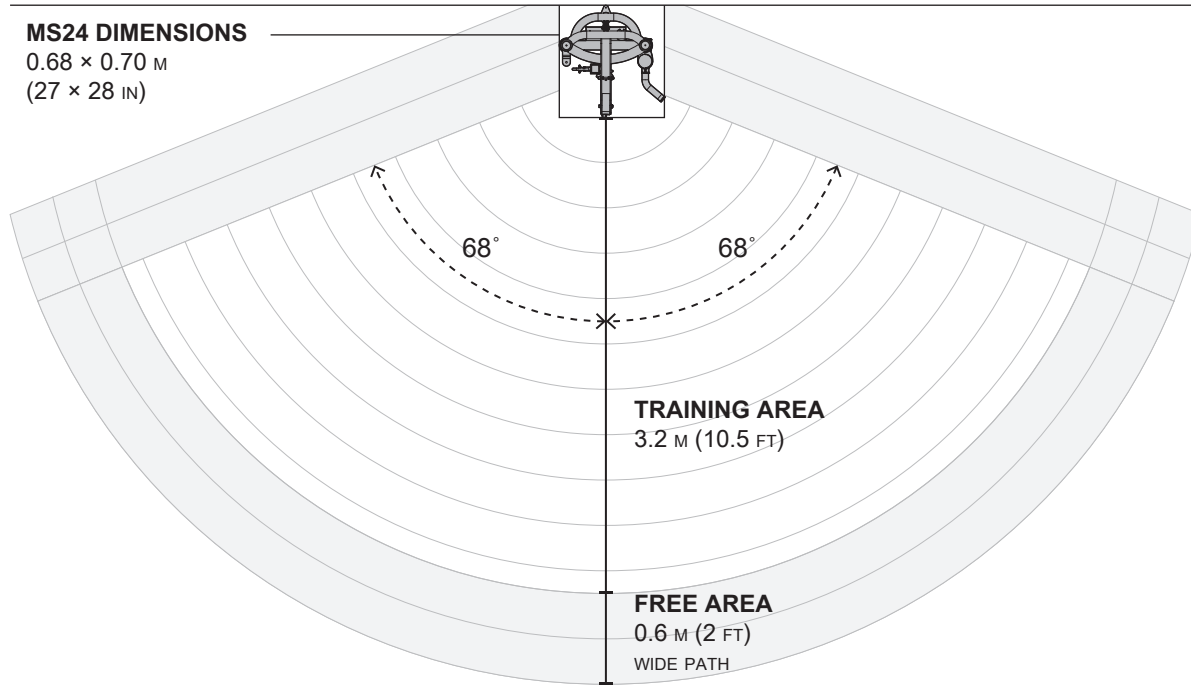



# G3-MS24

1	Hardware	Qty
Z04	Nut (M10)	4
B25	Bolt (M8x20L)	2
Z01	Bolt (M10x100L-20L)	4
Z02	Arc Washer	8

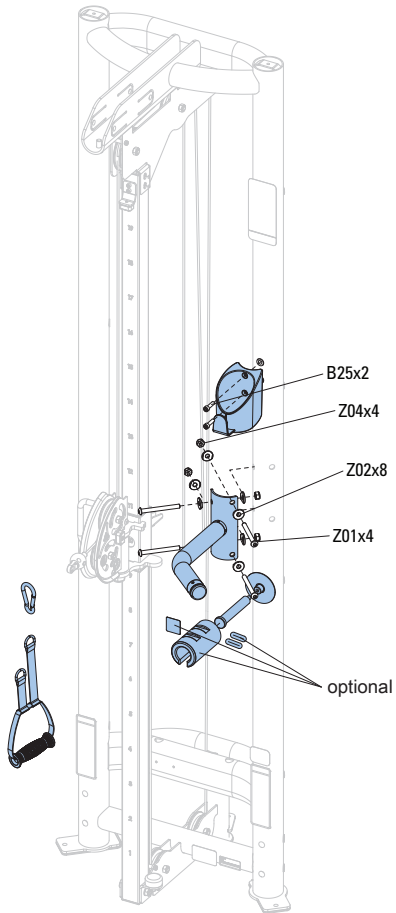

## 2

Front shroud is optional in various countries. Available upon request.

If no shroud is included, use plugs (8).

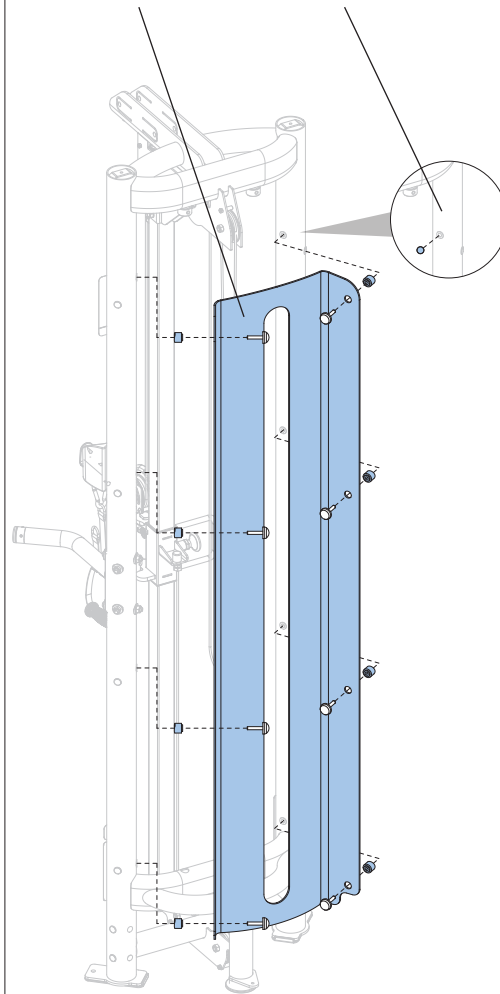

## 3

3	Hardware	Qty
Z11	Screw (M6x45L)	2
Z12	Nut (M6)	2
K19	Screw (M6x15L)	2

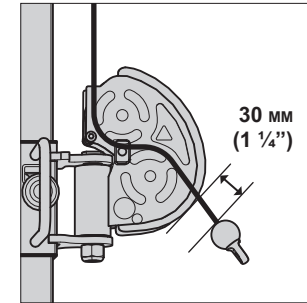
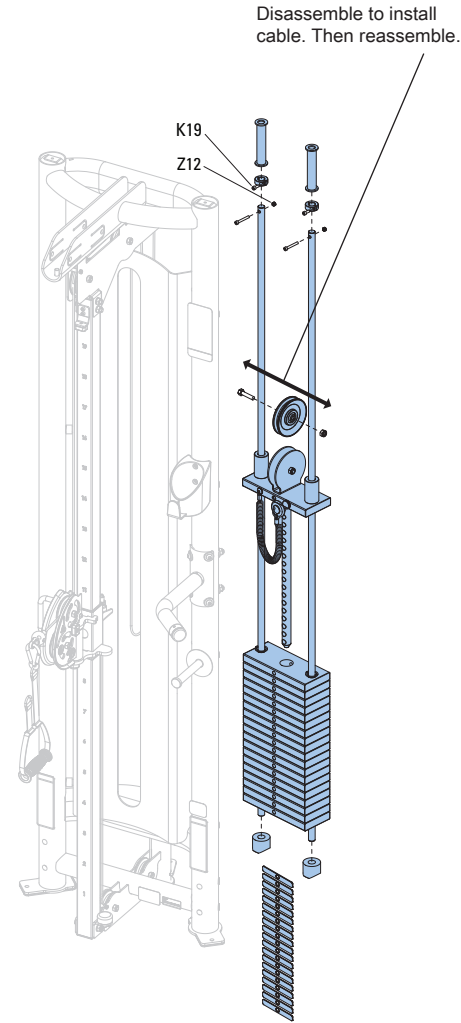

With front shroud

No front shroud

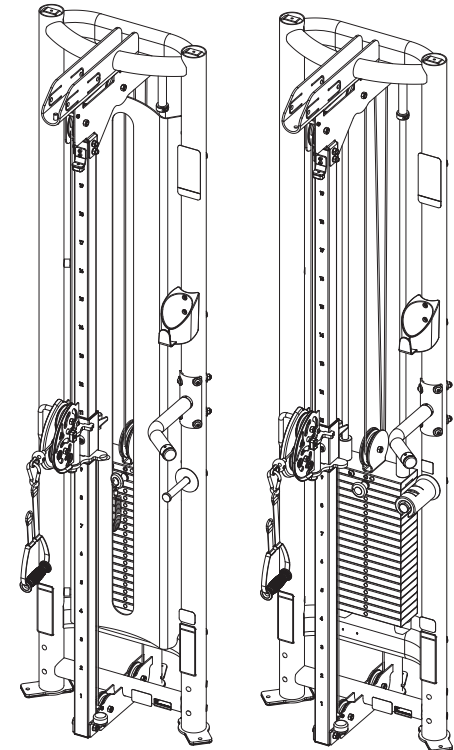

**ASSEMBLY COMPLETE**



# G3-MS51

## TECH SPECS

Maximum Training Weight	134 kg / 295 lbs
Product Weight	118 kg / 261 lbs
Overall Dimensions (L x W x H)*	140 x 120 x 252 cm / 55 x 47.5 x 99.5"
* Ensure a minimum clearance width of 914 mm / 36" for access to and passage around MATRIX strength equipment.	

**MS51  
TRAINING  
AREA**

1.4 M  
(55")

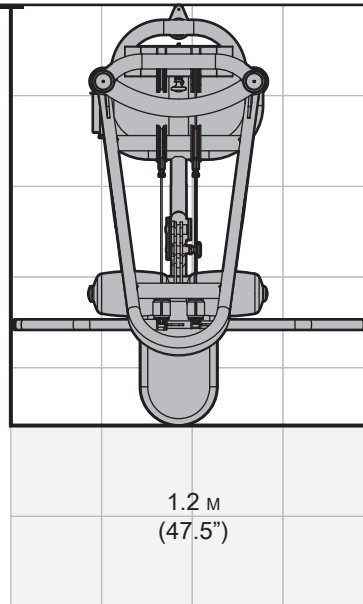

1.2 M  
(47.5")

**FREE AREA**  
0.6 M (2 FT)  
WIDE PATH

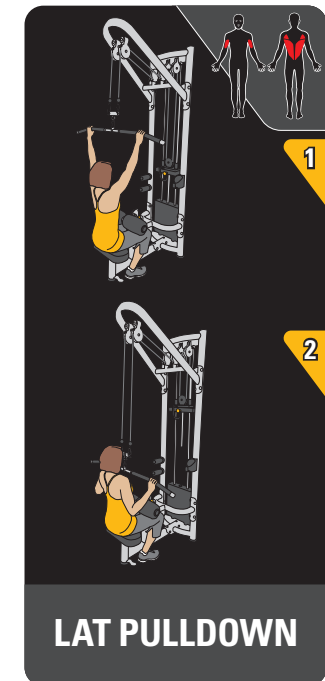

**LAT PULLDOWN**



# G3-MS51

1	Hardware	Qty
Z01	Bolt (M8x30L)	2
Z04	Bolt (M10x100L)	16
Z05	Flat Washer (M10)	4
Z07	Nut (M10)	18
Z08	Bolt (M10x80L)	2
Z17	Bolt (M10x25L)	2
Z18	Arc Washer	34

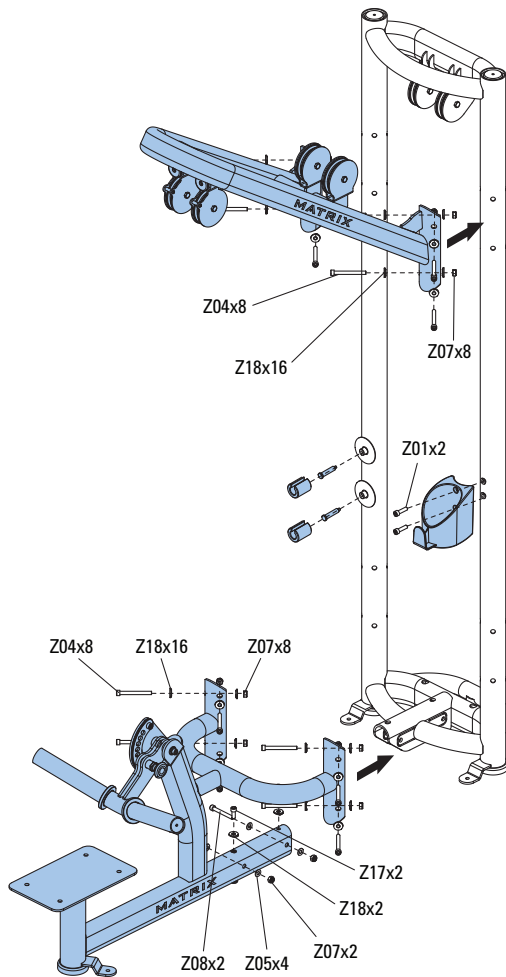

2	Hardware	Qty
Z13	Screw (M6x45L)	2
Z14	Nyloc Nut (M6)	2
K19	Screw (M6x15L)	2

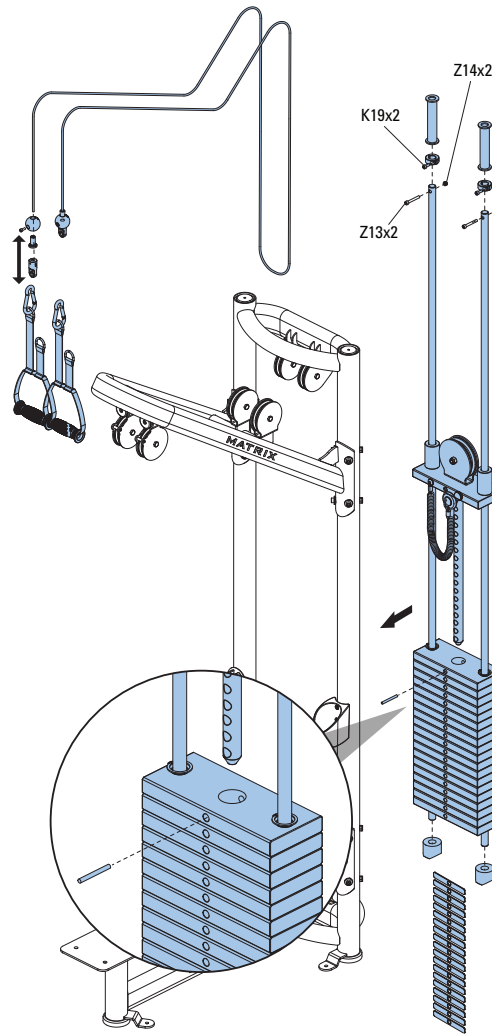

3	Hardware	Qty
Z06	Flat Washer (M8)	2
Z15	Bolt (M10x35L)	4
T13	Bolt (M8x20L)	2
H12	Large Flat Washer	2

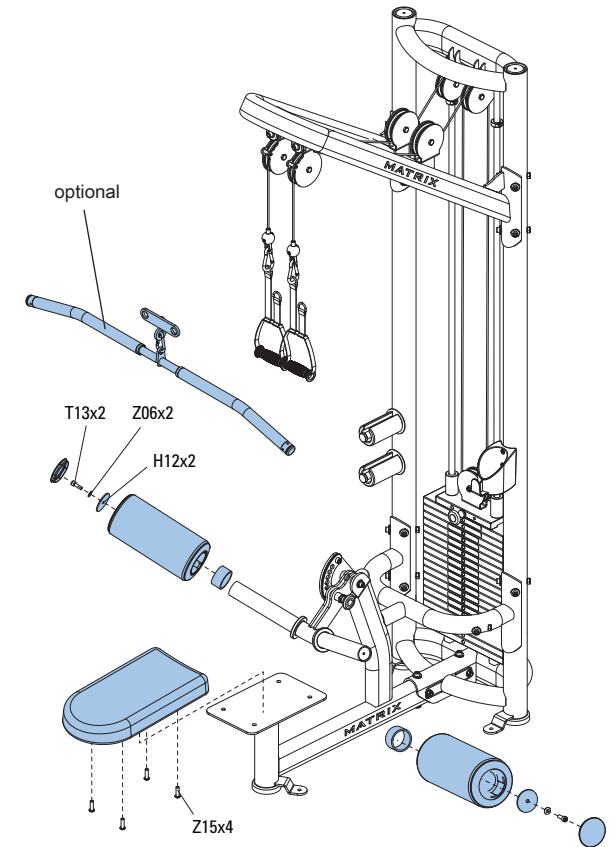

**ASSEMBLY COMPLETE**



# G3-MS52

## TECH SPECS

Maximum Training Weight	91 kg / 200 lbs
Product Weight	80.5 kg / 178 lbs
Overall Dimensions (L x W x H)*	85 x 59 x 240 cm / 33.5 x 23.5 x 94.5"
* Ensure a minimum clearance width of 914 mm / 36" for access to and passage around MATRIX strength equipment.	

**MS52  
TRAINING  
AREA**

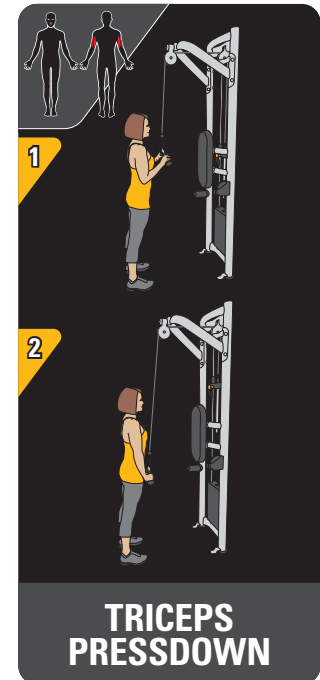
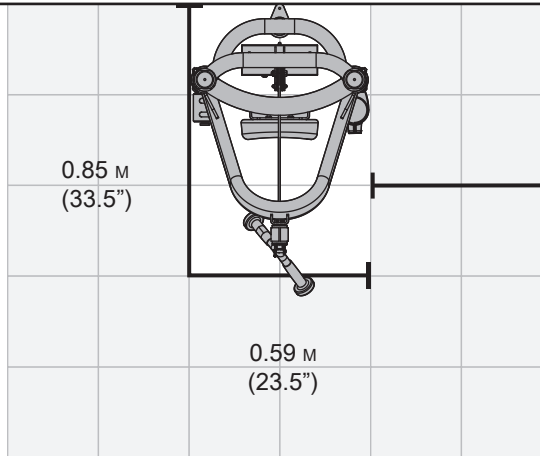



# G3-MS52

1	Hardware	Qty
Z01	Bolt (M8x30L)	2
Z02	Bolt (M10x35L)	2
Z09	Bolt (M10x100L)	8
Z10	Nut (M10)	16
Z18	Arc Washer	8

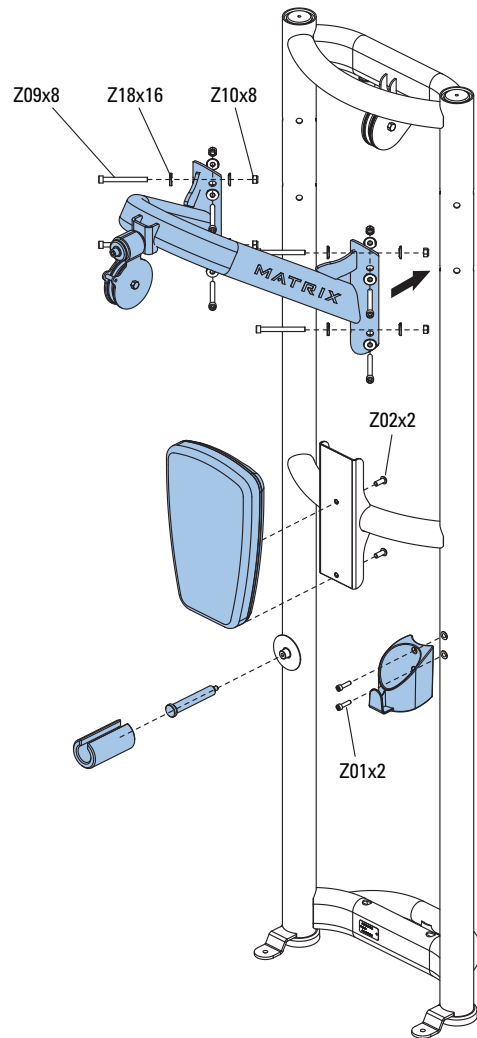

2	Hardware	Qty
Z05	Screw (M6x45L)	2
Z06	Nyloc Nut (M6)	2
K19	Screw (M6x15L)	2

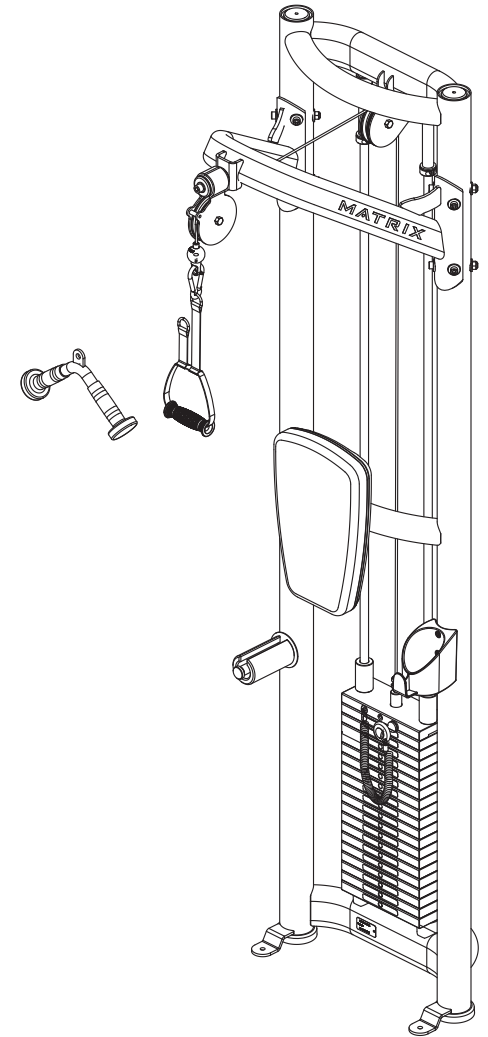
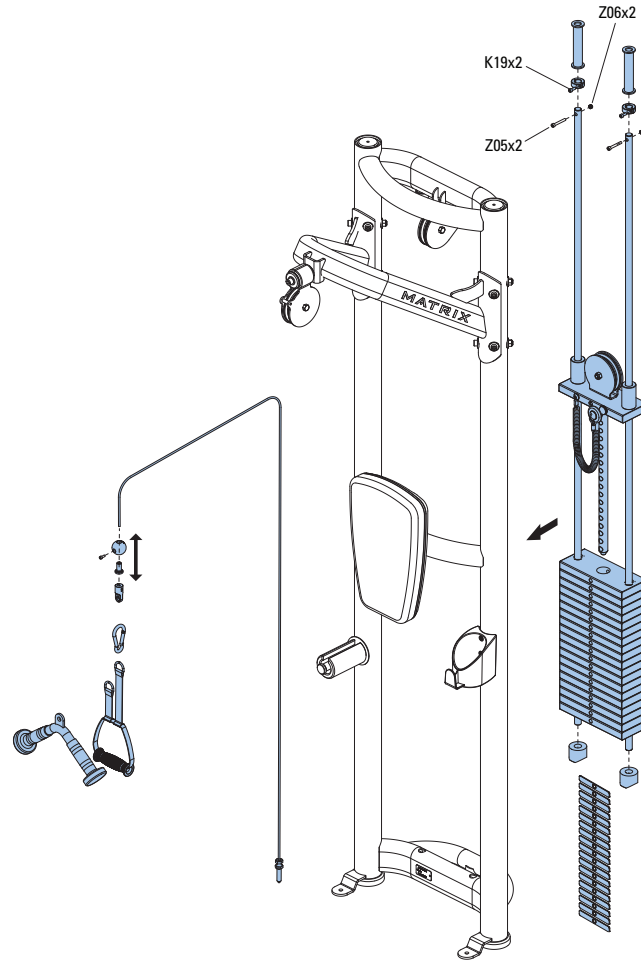

**ASSEMBLY COMPLETE**



# G3-MS53

## TECH SPECS

Maximum Training Weight	134 kg / 295 lbs
Product Weight	126 kg / 278 lbs
Overall Dimensions (L x W x H)*	230 x 71 x 240 cm / 91 x 28 x 94.5"
* Ensure a minimum clearance width of 914 mm / 36" for access to and passage around MATRIX strength equipment.	



### MS53 TRAINING AREA

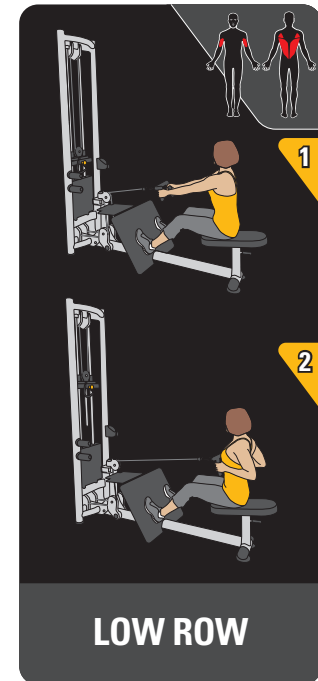
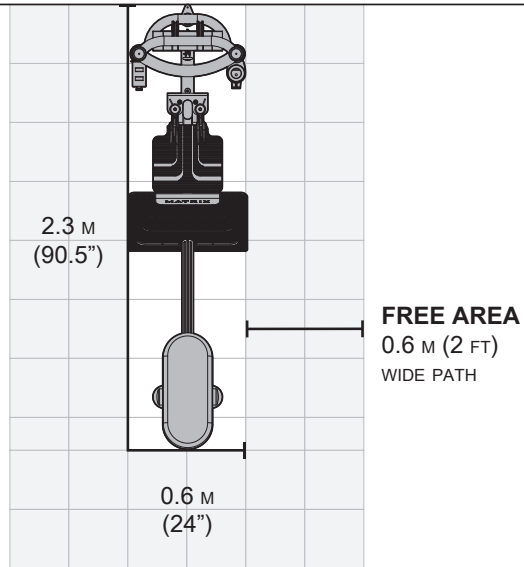



# G3-MS53

1	Hardware	Qty
Z02	Bolt (M10x35L)	4
Z07	Bolt (M10x25L)	4
Z10	Bolt (M10x25L)	2
Z11	Flat Washer (M10)	8
Z13	Bolt (M10x80L)	2
F23	Nyloc Nut (M10)	6
Z16	Arc Washer (M10)	2

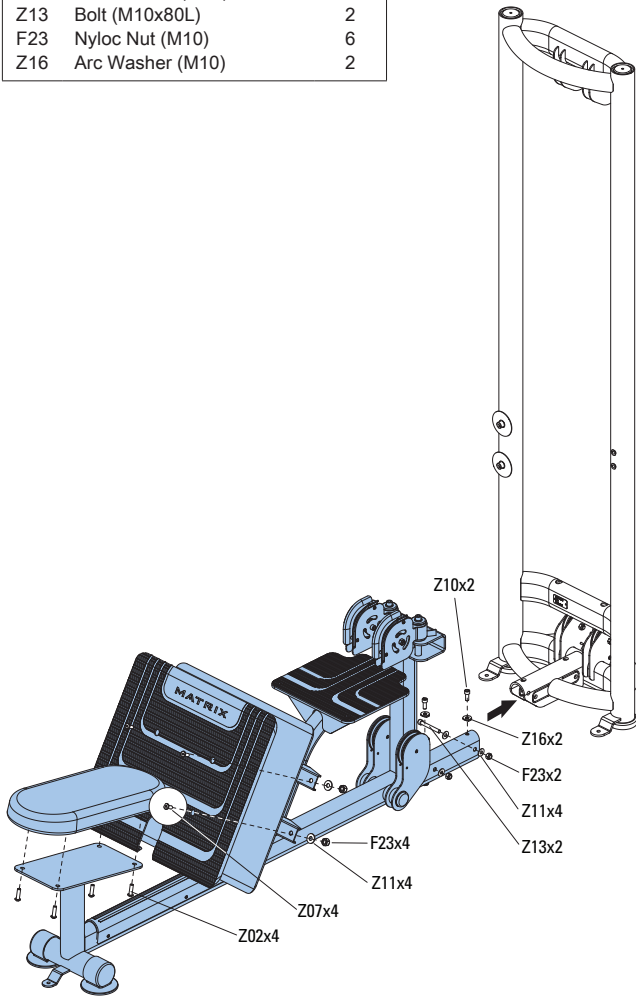

2	Hardware	Qty
Z01	Bolt (M8x30L)	2
Z05	Screw (M6x15L)	2
Z06	Nyloc Nut (M6)	2

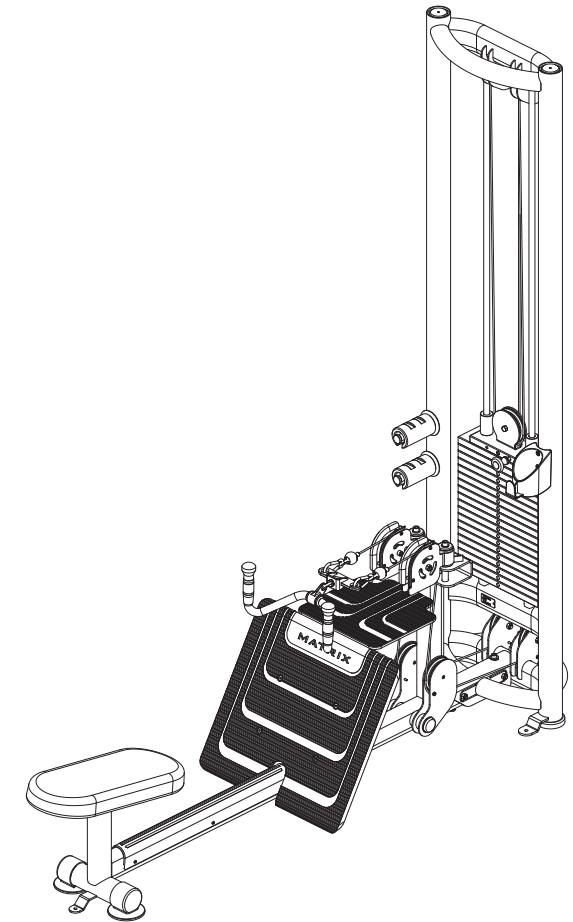
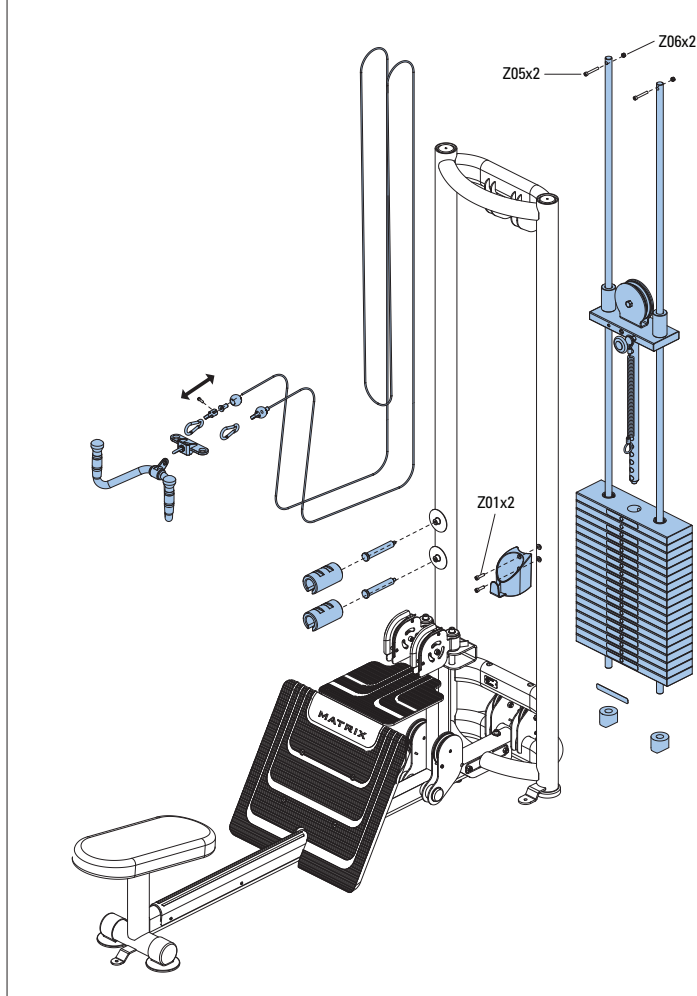

**ASSEMBLY COMPLETE**



# G3-MS20

## 2-STACK SAMPLE CONFIGURATION

Front shroud is optional in various countries. Available upon request.

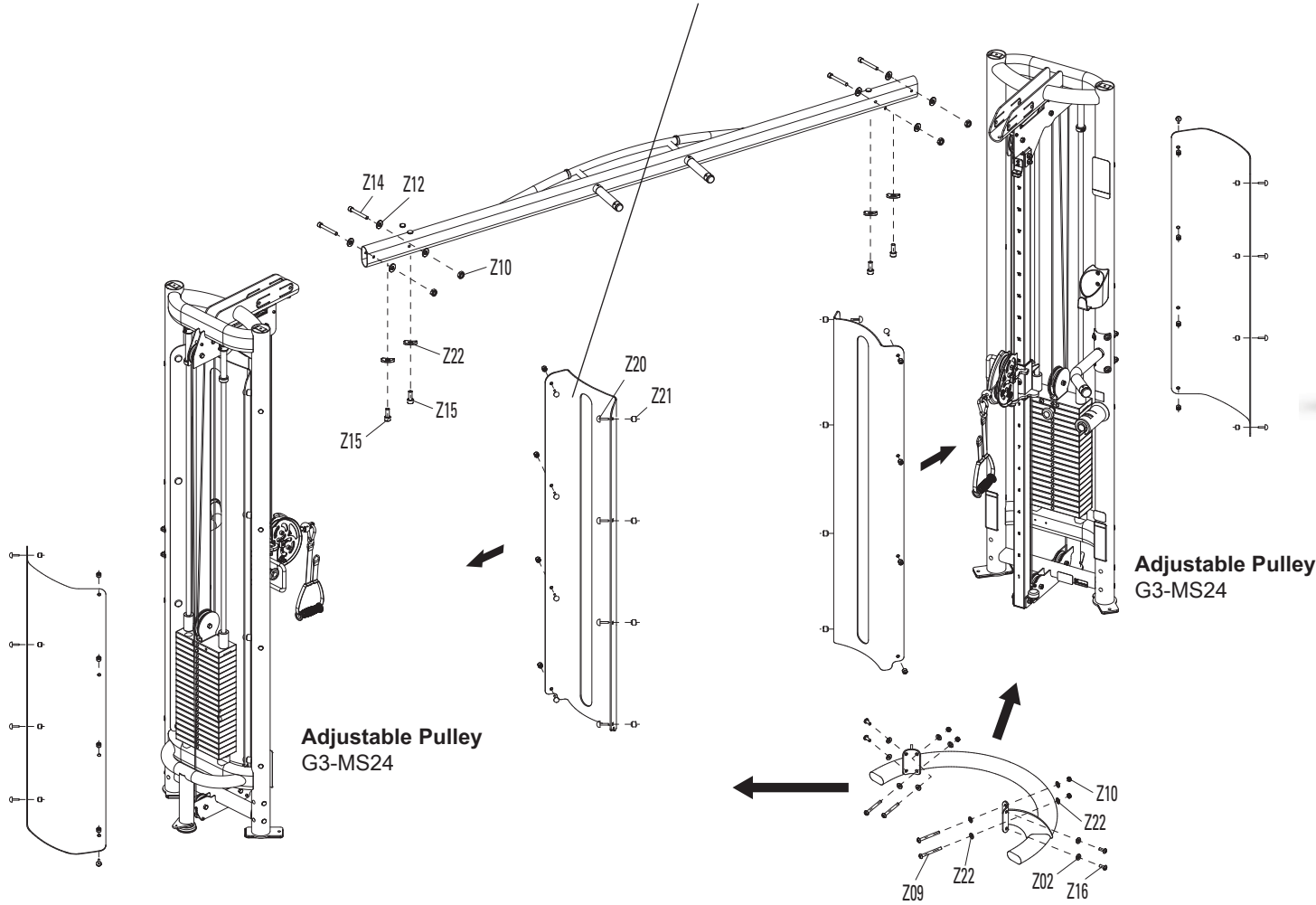

Hardware		Qty
Z02	Flat Washer (M8)	8
Z09	Bolt (M10x100L)	8
Z10	Nylon Nut (M10)	12
Z12	Flat Washer (M10)	8
Z14	Bolt (M10x80L)	4
Z15	Bolt (M10x25L)	4
Z16	Bolt (M8x25L)	8
Z22	Arc Washer	20
Z20	Rubber Tip Bolt	24
Z21	Rubber Spacer	24



# G3-MS20 SHORT KIT

1

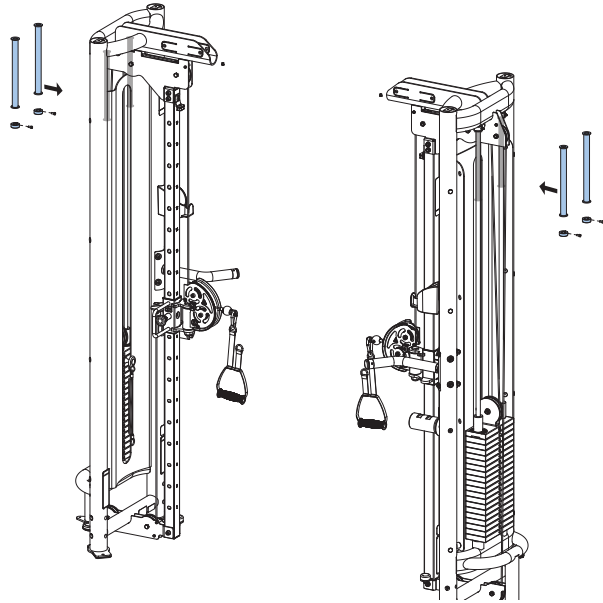

2	Hardware	Qty
Z01	Nylock Nut (M10)	4
Z02	Flat Washer (M10)	8
Z03	Bolt (M10x80-35L)	4
Z04	Bolt (M10x25L)	4
Z06	Arc Washer (M10)	4
B07	Plug	2

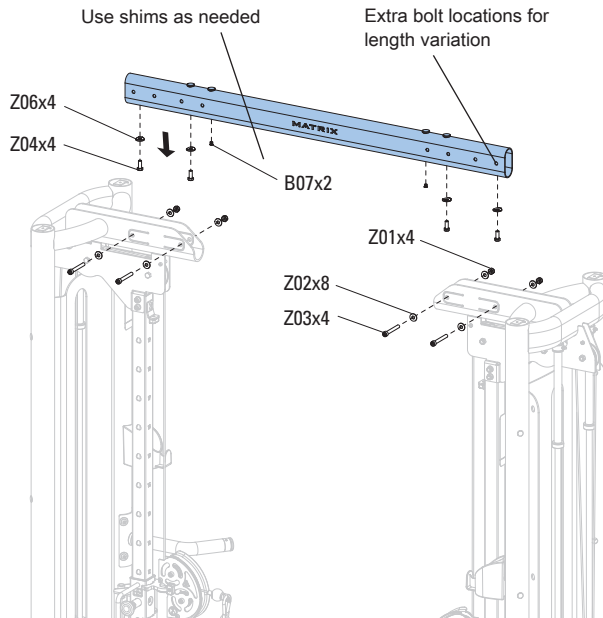

3	Hardware	Qty
Z01	Nylock Nut (M10)	4
Z02	Flat Washer (M10)	4
Z05	Bolt (M10x135L)	4
Z06	Arc Washer (M10L)	4

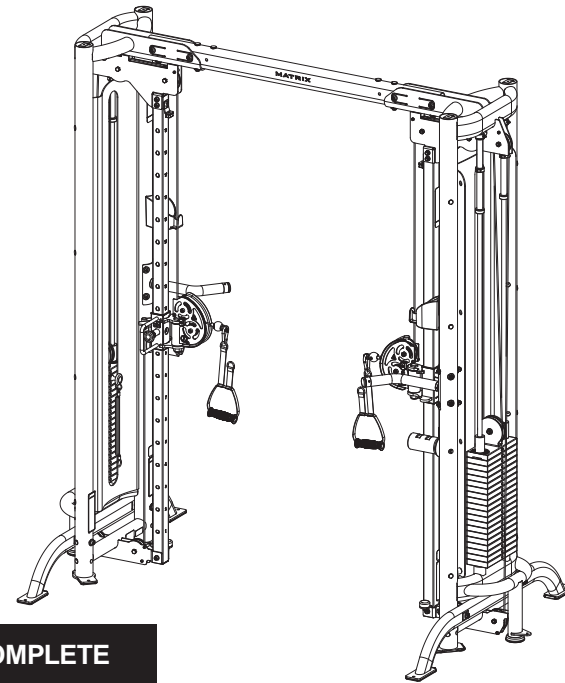
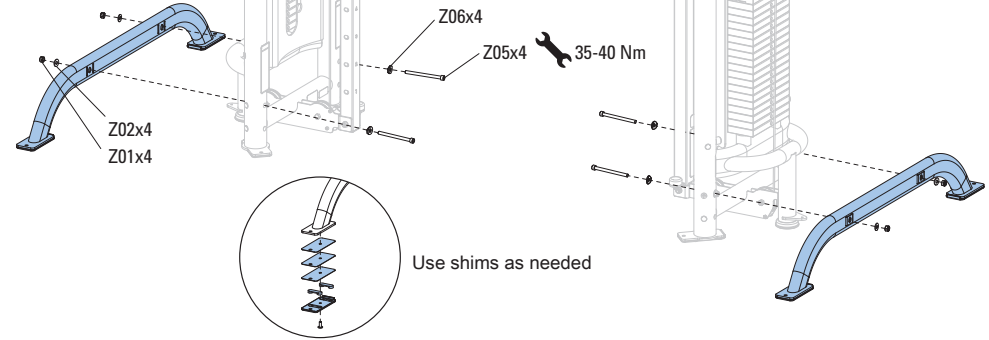

**ASSEMBLY COMPLETE**



# G3-MS40

4-STACK  
SAMPLE CONFIGURATION

Front shroud is optional in various countries. Available upon request.

**NOTE:**

If a 4-stack includes a G3-MS00 Blank Station, it must follow one of the configurations listed on page 4.

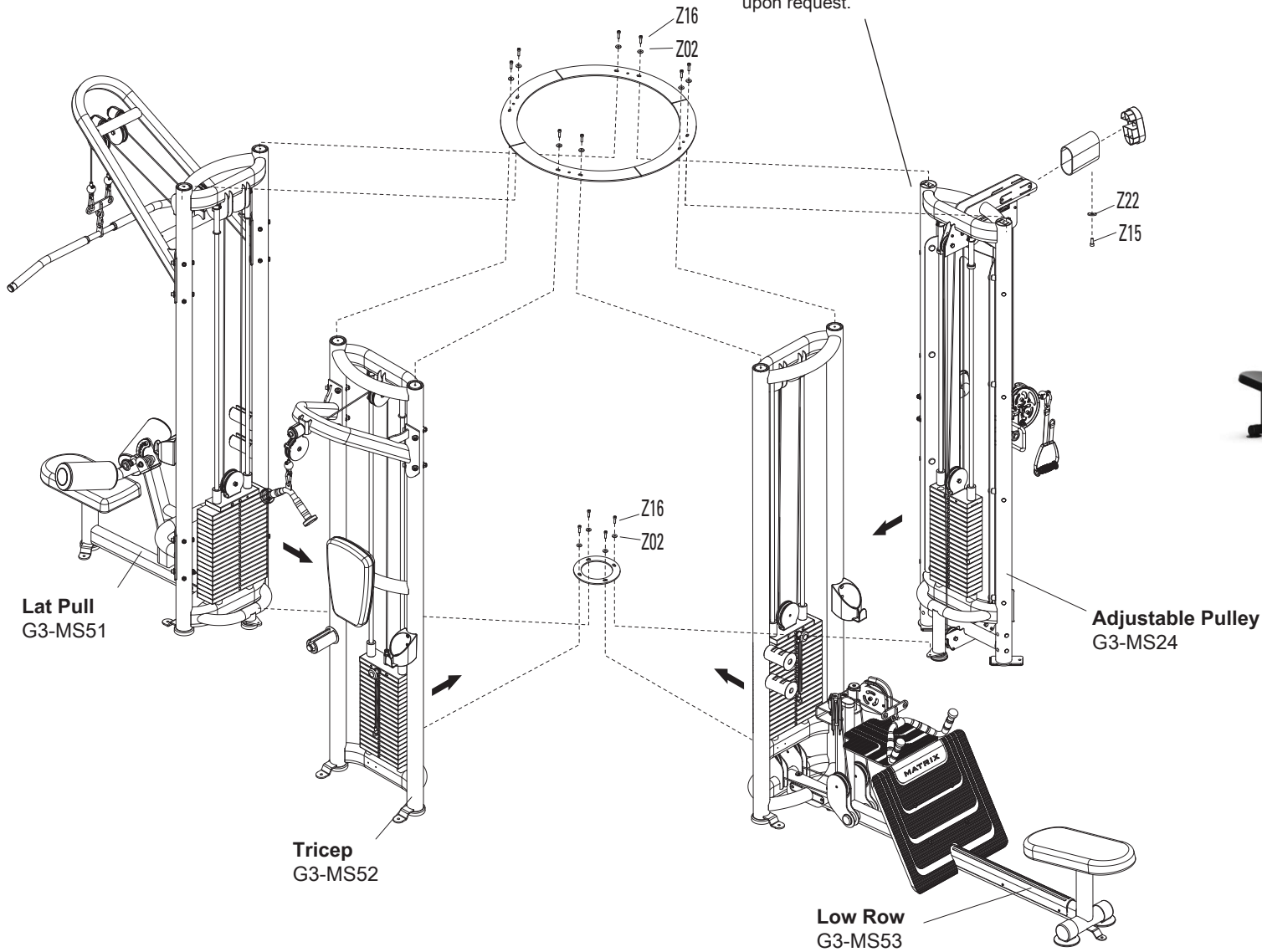

Hardware		Qty
Z02	Flat Washer (M8)	12
Z16	Bolt (M8x30L)	12
Z15	Bolt (M10x25L)	1
Z22	Arc Washer (M10)	1



# G3-MS50

## 1 5-STACK SAMPLE CONFIGURATION

### NOTE:

If a 5-stack includes a G3-MS00 Blank Station, it must follow one of the configurations listed on page 4.

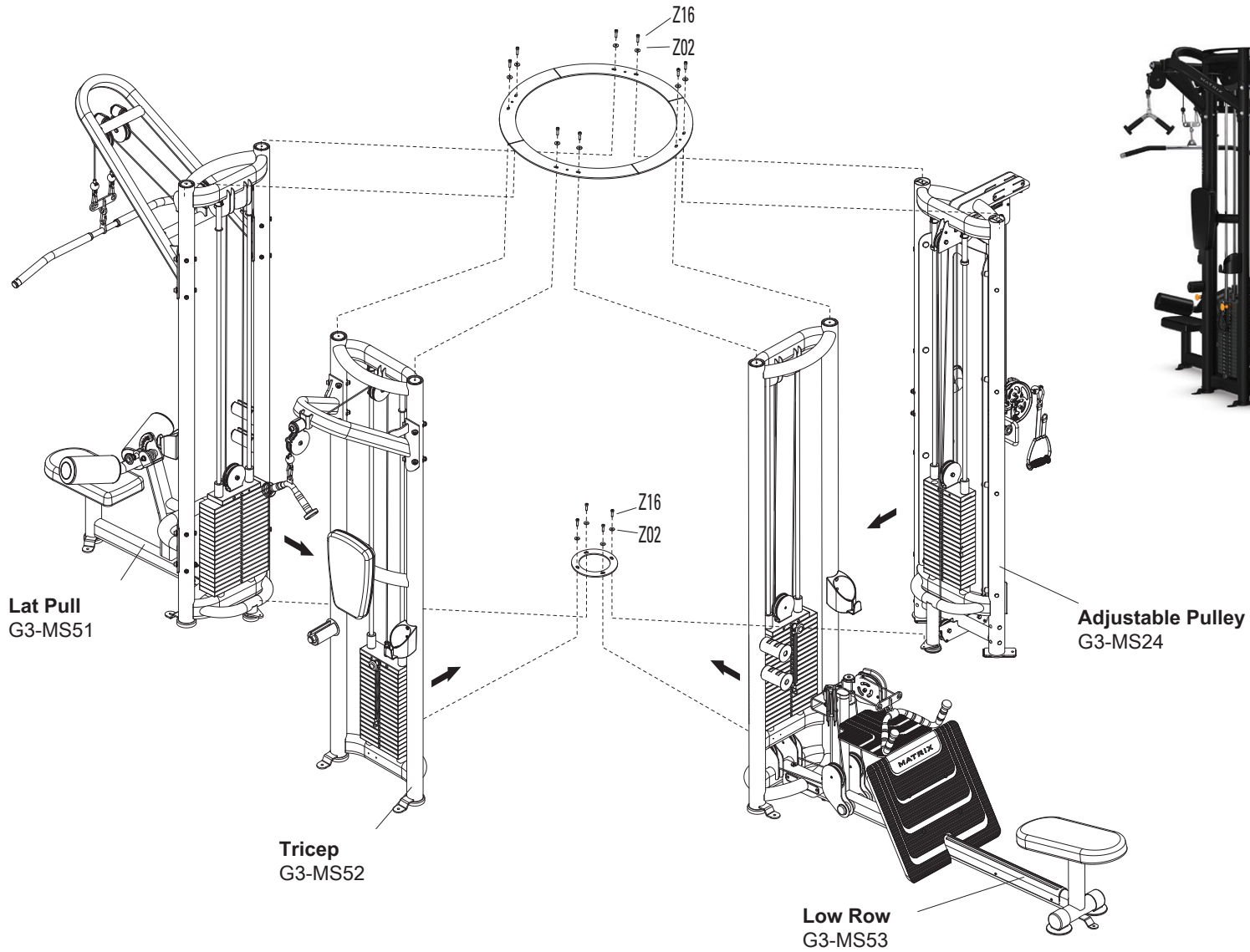

Hardware		Qty
Z02	Flat Washer (M8)	12
Z16	Bolt (M8x30L)	12



# G3-MS50

## 2 5-STACK SAMPLE CONFIGURATION

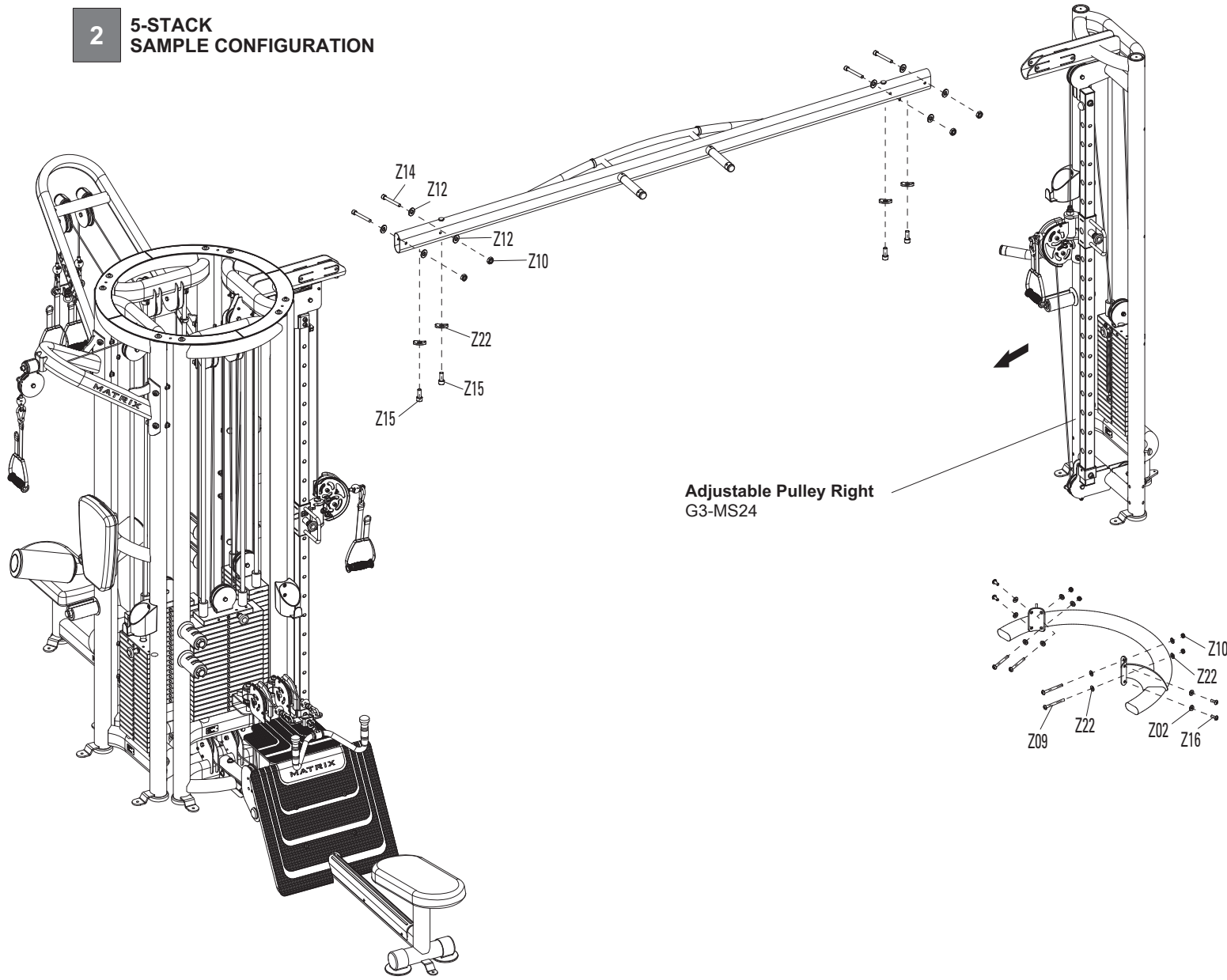

Adjustable Pulley Right  
G3-MS24

Hardware	Qty
Z02 Flat Washer (M8)	4
Z09 Bolt (M10x100L)	4
Z10 Nylon Nut (M10)	8
Z12 Flat Washer (M10)	8
Z14 Bolt (M10x80L)	4
Z15 Bolt (M10x25L)	4
Z16 Bolt (M8x25L)	4
Z22 Arc Washer	12



# G3-MS50

## 3 5-STACK SAMPLE CONFIGURATION

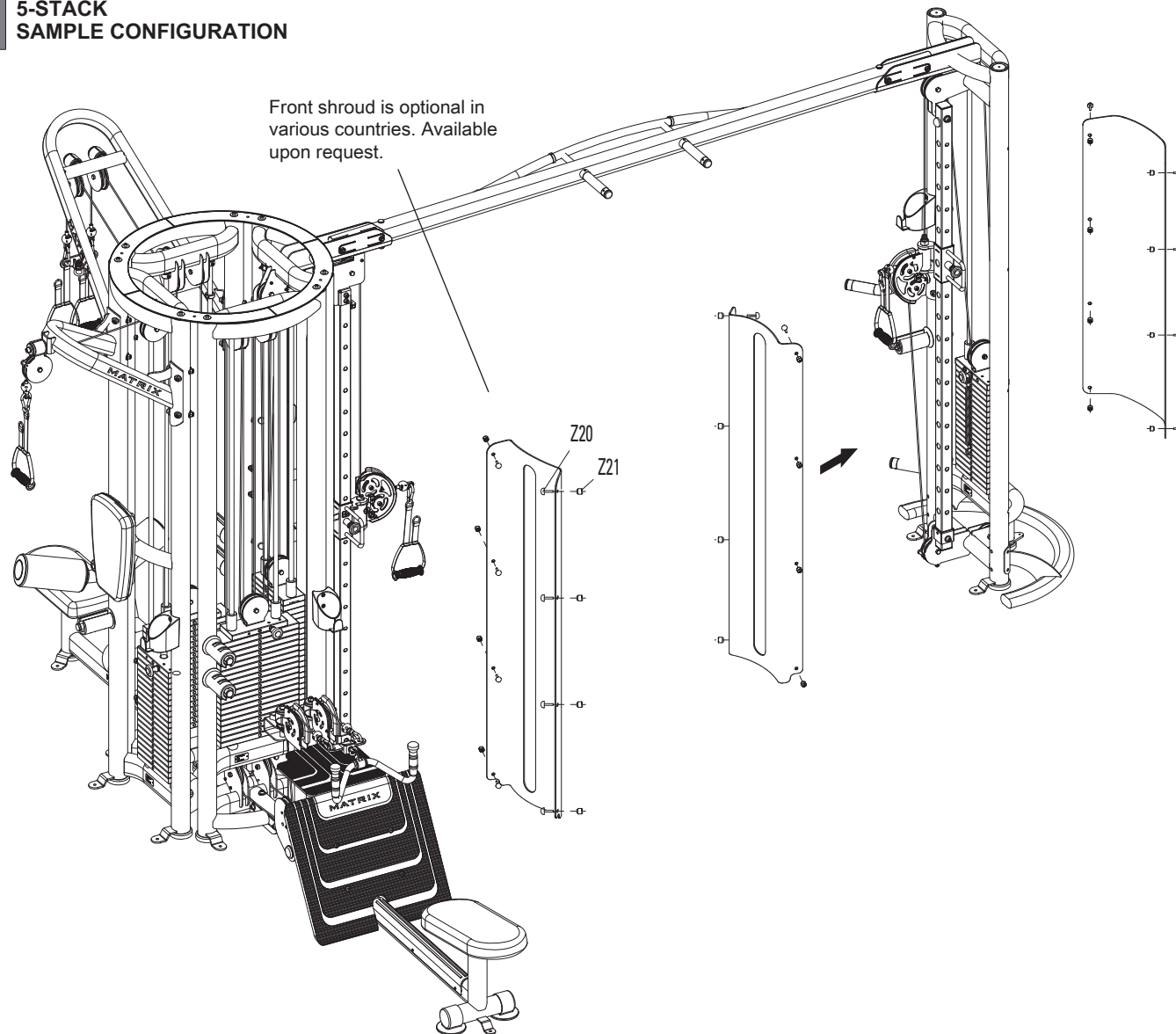

Hardware		Qty
Z20	Rubber Tip Bolt	24
Z21	Rubber Spacer	24



# G3-MS80

## 1 8-STACK SAMPLE CONFIGURATION

### NOTE:

If a 8-stack includes a G3-MS00 Blank Station, it must follow one of the configurations listed on page 4.

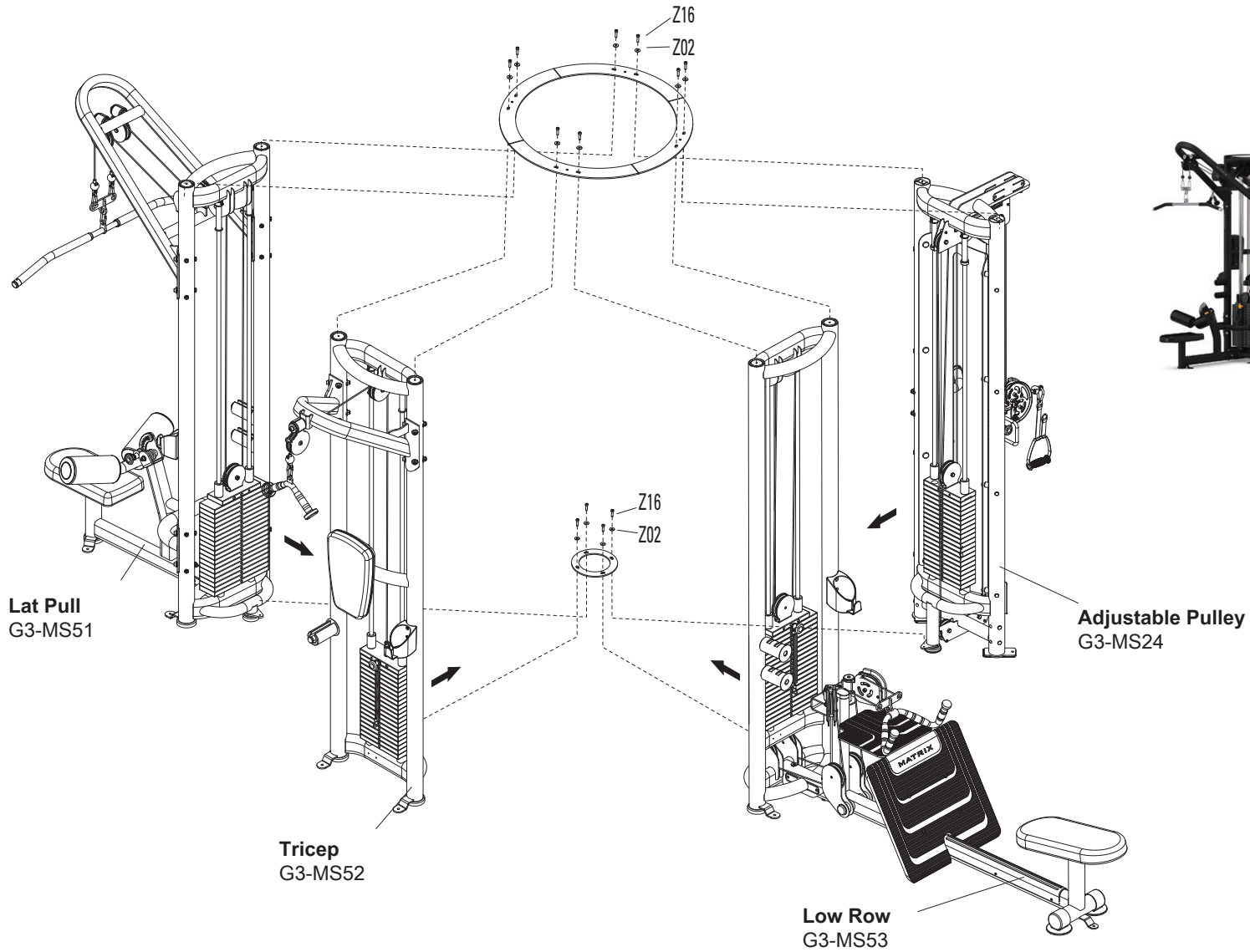

Hardware		Qty
Z02	Flat Washer (M8)	12
Z16	Bolt (M8x30L)	12



# G3-MS80

## 2 8-STACK SAMPLE CONFIGURATION

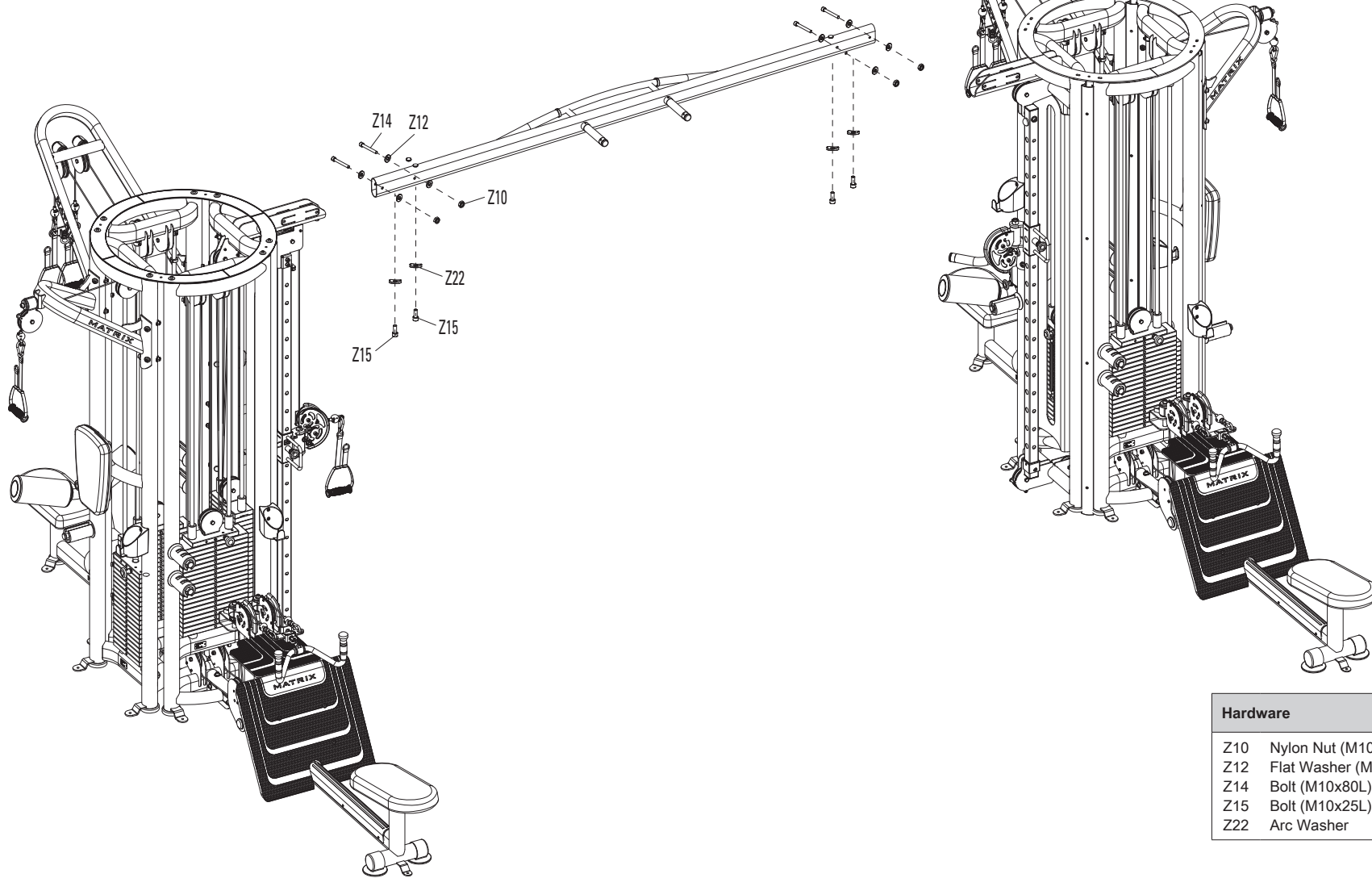

Hardware		Qty
Z10	Nylon Nut (M10)	4
Z12	Flat Washer (M10)	8
Z14	Bolt (M10x80L)	4
Z15	Bolt (M10x25L)	4
Z22	Arc Washer	4



# G3-MS80

## 3 8-STACK SAMPLE CONFIGURATION

Front shroud is optional in various countries. Available upon request.

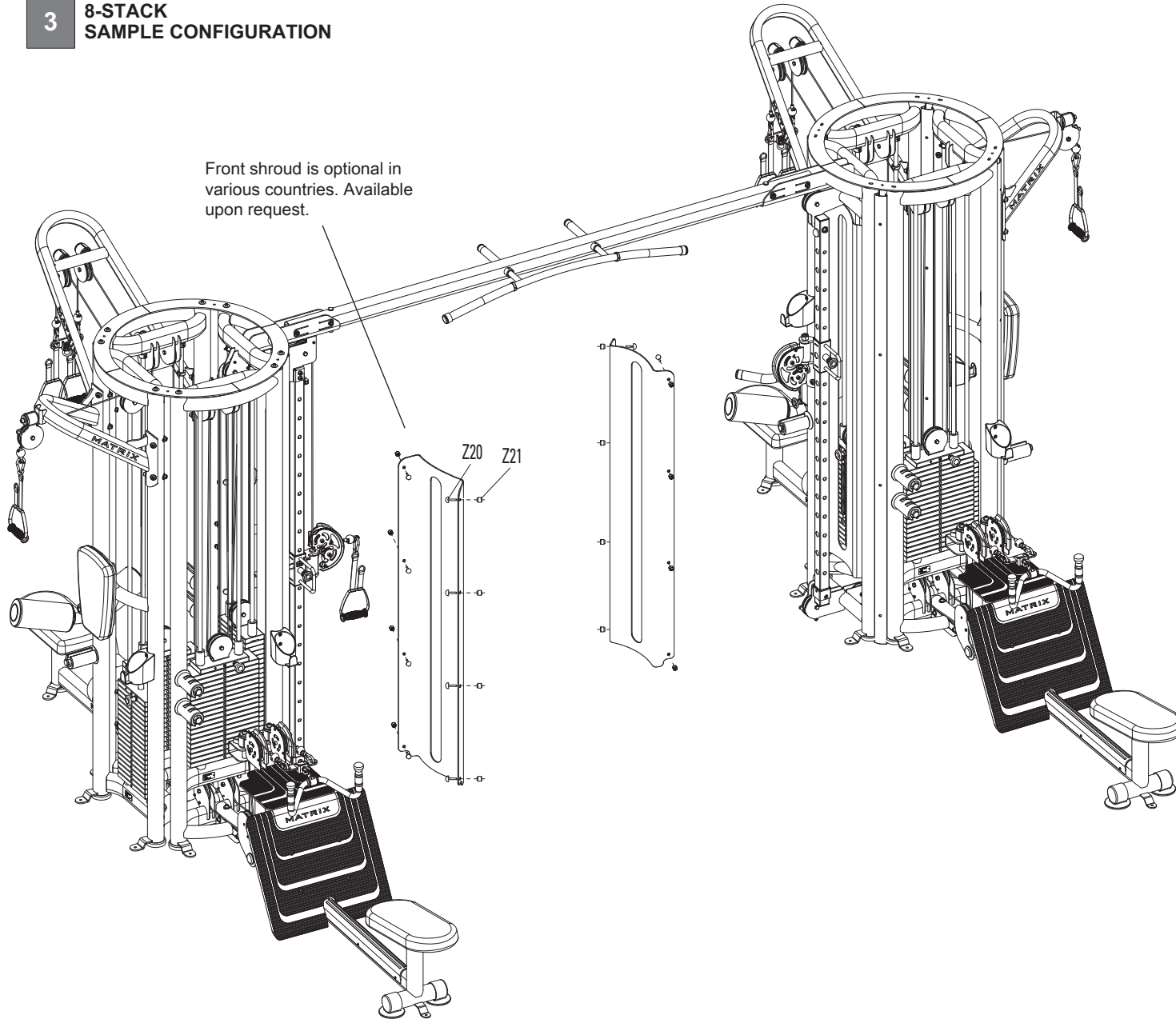

Hardware		Qty
Z20	Rubber Tip Bolt	16
Z21	Rubber Spacer	16

# MATRIX



G3-MS20 G3-MS40 G3-MS51 G3-MS53 G3-MS00  
G3-MS24 G3-MS50 G3-MS52 G3-MS80

© 2025 Johnson Health Tech

Rev 2.1 A