

MATRIX

DWG NO.		921-06 & FS921-06 SERVICE	
DESCRIPTION:		LAT PULLDOWN (Strength - Single Station)	
DRAWN BY:	LMB	DATE:	2018.JAN.15
UPDATED BY:		DATE:	

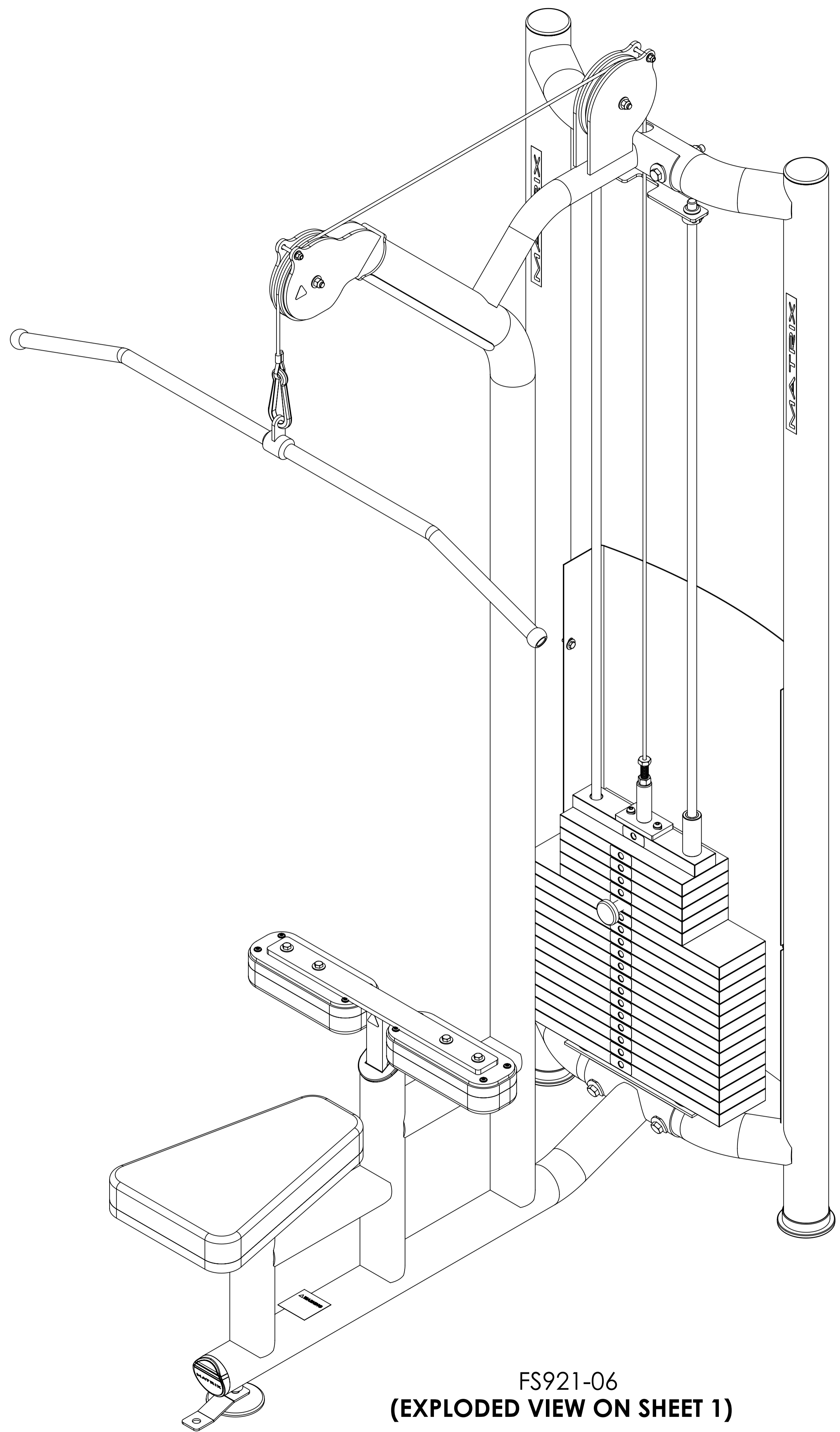

FS921-06
(EXPLODED VIEW ON SHEET 1)

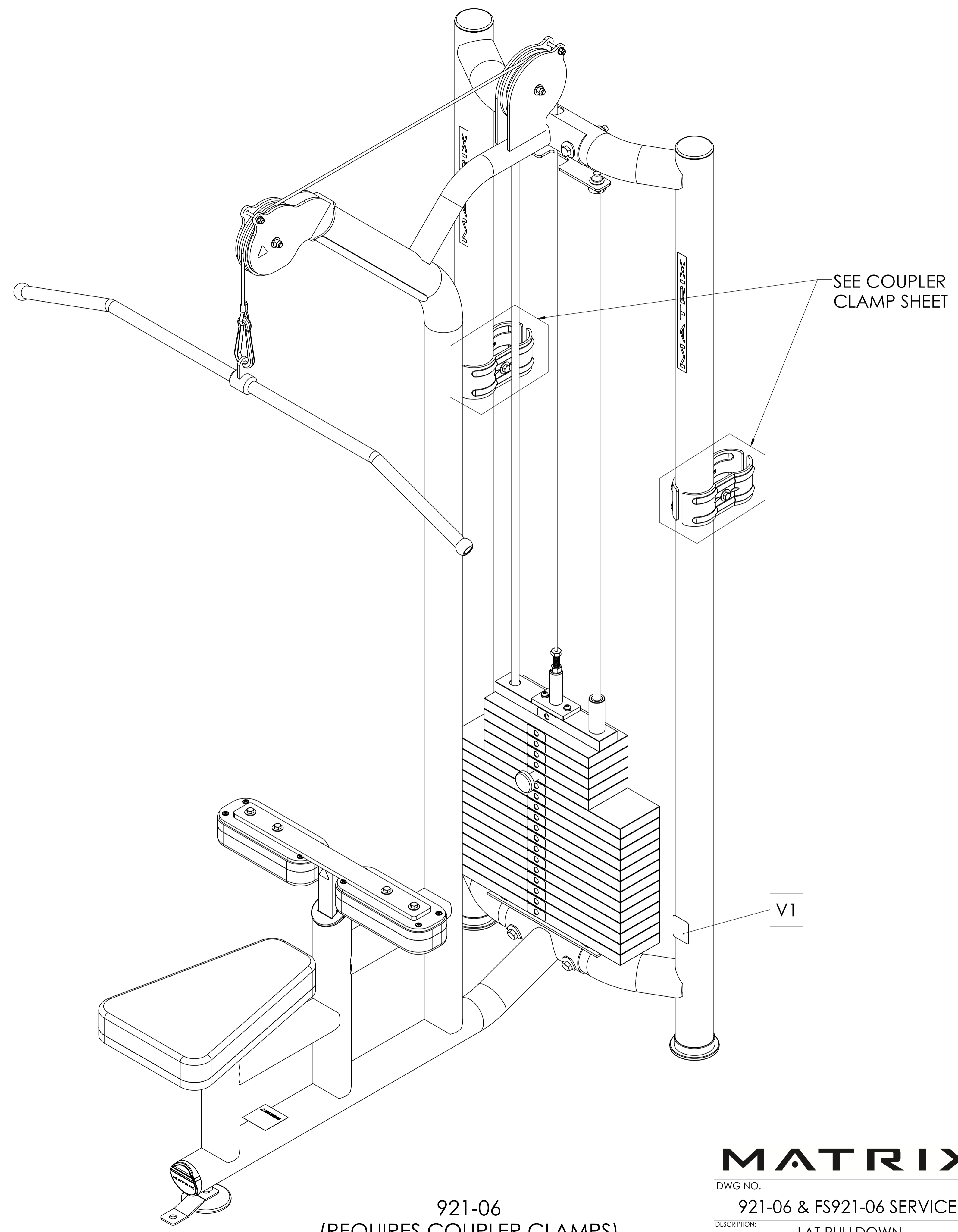

921-06
(REQUIRES COUPLER CLAMPS)

MATRIX

DWG NO.		921-06 & FS921-06 SERVICE	
DESCRIPTION:		LAT PULLDOWN (Strength - Single Station)	
DRAWN BY:	LMB	DATE:	2018.JAN.15
UPDATED BY:		DATE:	

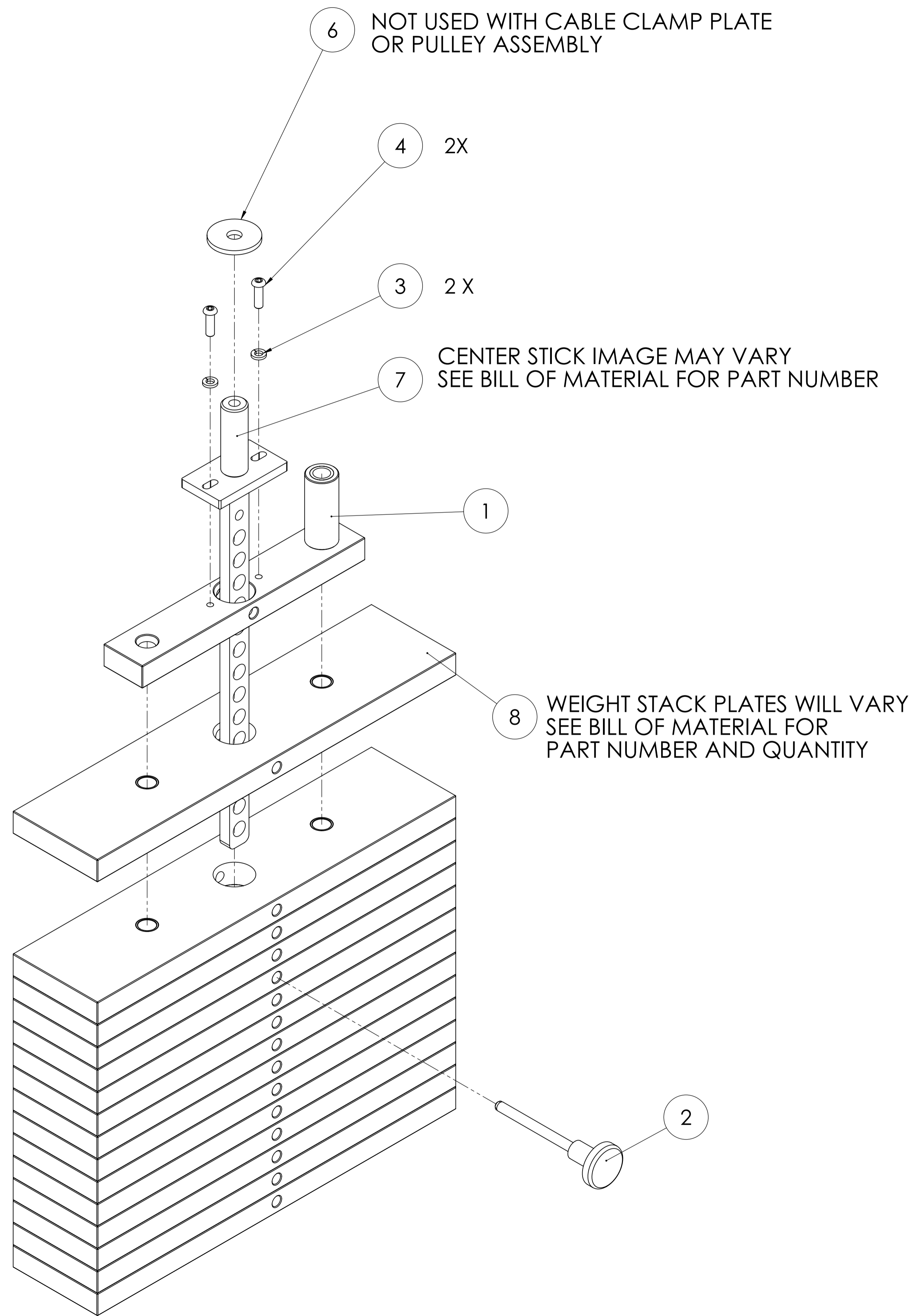

**CENTER STICK WITH MOUNTING POST
CABLE MOUNTED WITH TAKE UP BOLT OR PULLEY
(SHOWN EXPLODED)
SEE NOTES AND BOM FOR PART NUMBERS**

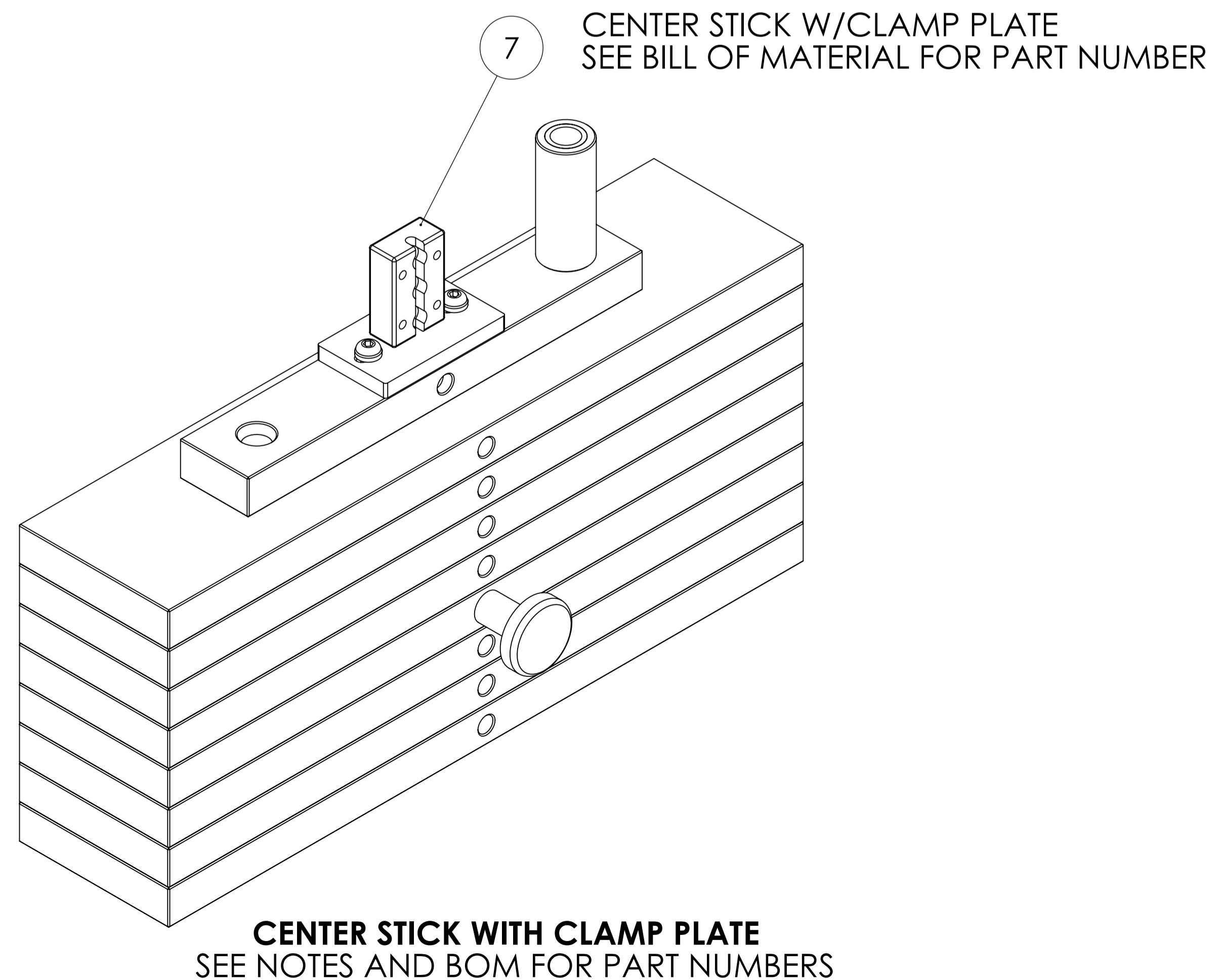
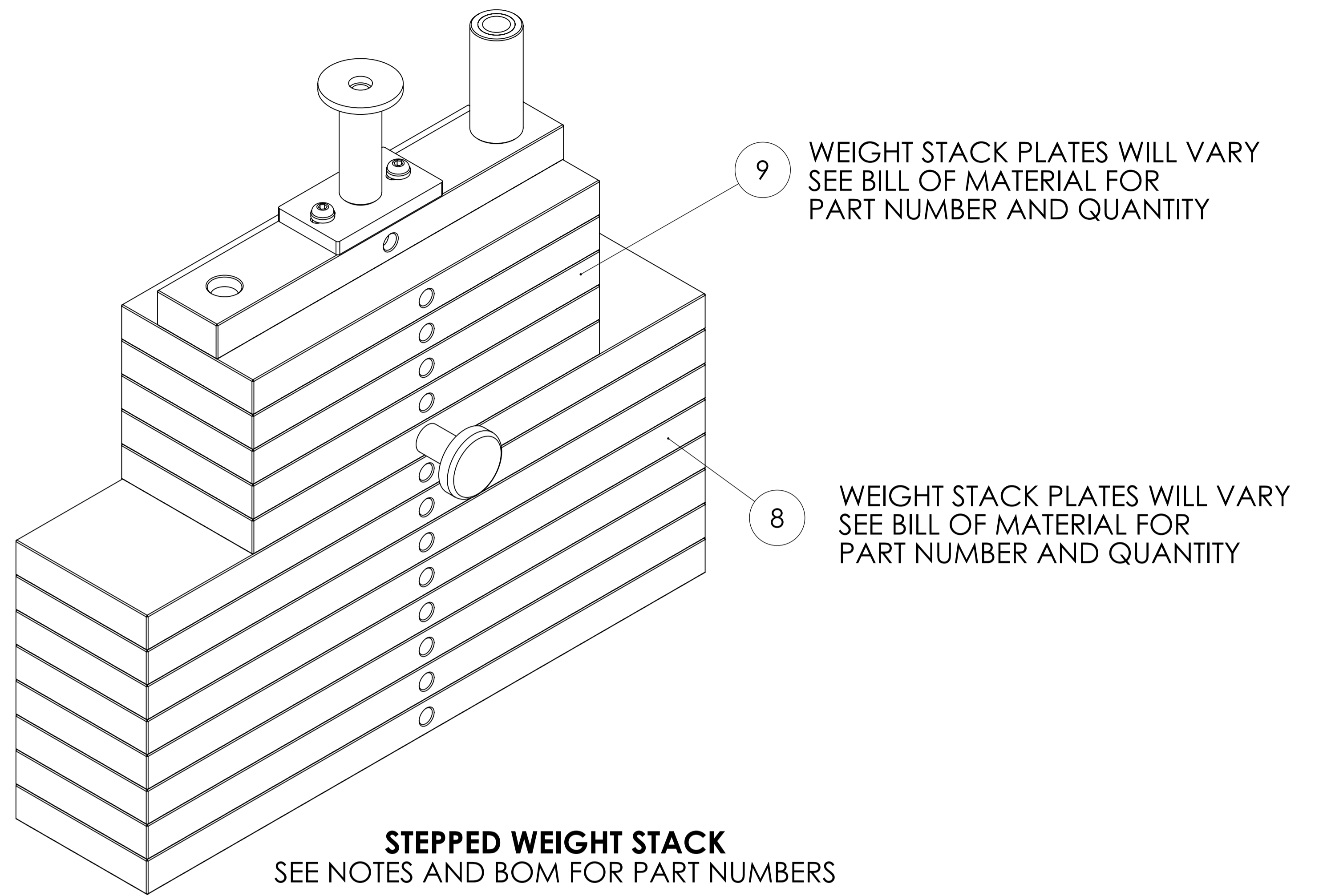

MATRIX

DWG NO.		
_WEIGHT STACK SERVICE		
DESCRIPTION: WEIGHT STACK/CENTERSTICK ASSY (Take Up Bolt, Pulley & Clamp Style)		
DRAWN BY:	LMB	DATE: 2013.OCT.10
UPDATED BY:	LMB	DATE: 2017.DEC.29

MG-921-06				
Reference #	Part #	Description	Qty	Notes
AB1	1000353447	Frame Set;900 Series;Iced Silver	1	
AB1	1000353448	Frame Set;900 Series;Black Glossy	1	
AB1	1000353449	Frame Set;900 Series;Lace White	1	
AB2	1000360142	Main Frame User Side Assy;921;Iced Silver	1	
AB2	1000360143	Main Frame User Side Assy;921;Black Glossy	1	
AB2	1000360144	Main Frame User Side Assy;921;Lace White	1	
AB5	1000393455	Knee Hold Down Chrome w/ Decals;921;	1	
AB6	1000328373	WELDMENT TIP OVER FOOT;Iced Silver	1	Only on FS version.
AB6	1000328374	WELDMENT TIP OVER FOOT;Black Glossy	1	Only on FS version.
AB6	1000328375	WELDMENT TIP OVER FOOT;Lace White	1	Only on FS version.
B3	1000313766	HARD CHROME 48" LAT BAR	1	
B4	1000338388	Plug;Seat Post;	1	
B6	1000310302	6" CABLE PULLEY w/ NARROW BUSHING	2	
B7	1000312893	3/8" SAFETY CLIP	1	
B8	1000379407	Spring Pin Assy;1.313 Body;	1	
B9	1000421275	Cable Assy;921;	1	
B10	1000310014	End Cap	1	
B11	1000321910	5/8" GUIDE ROD - 76"	2	
B14	1000421272	Weight Stack Bracket;900 SRS;	1	
B17	1000310339	ROUND WEIGHT STACK BUMPER	2	
B18	1000345600	5/8" Single Split Collar	2	
B19	1000310273	4" FOOT (SHORT)	2	
B20	1000312237	3" FOOT	2	
B24	1000310331	10ga PLASMA - 1 1/2" x 5 1/4"	1	
B46	1000350082	SAFETY TAPE 18"X 4" LAT BAR	1	
B49	1000312233	3" ROUND END CAP	2	
B50	1000317727	5/8" RUBBER GROMMET	2	
B51	1000342962	Stack Guard;Grey;	1	Only on FS version.
J11	See Pad Matrix	UPHOLSTERY	1	
J21	See Pad Matrix	Pad; seat;Hazelnut	1	
V1	1000363760	Decal;Warning;Multi Station;English	1	Non FS version only.
V1	1000363756	Decal;Warning;Multi Station;French	1	Non FS version only.
V40	1000421523	900 Step Stack Decal	1	
V41	1000312342	BOLT DOWN WARNING	1	
V42	1000384006	Serial Number Label;4" x 1.5";3M;	2	
V43	1000315894	DECAL MATRIX 11X1 BLK	1	
V44	1000359953	Decal;Warning;Single Station;English	1	
V44	1000364025	Decal;Warning;Single Station;French	1	
V45	1000308473	Decal, warning Hand Pinch	3	
Z25	1000308446	WASHER;FLT;USS;Φ0.281XΦ0.734X.063;ZN;	6	Only on FS version.
Z26	1000310219	SCREW;HH;250-20 x 0.75;ZN;	6	Only on FS version.
Z27	1000309953	SCREW;HH;313-18 x 1.25;ZN;	2	
Z28	1000312099	HCS 1/2-13 x 4 1/4"	4	
Z29	1000309851	HCS 3/8-16 x 2 1/4" - ZINC	2	
Z30	1000310097	SCREW;HH;250-20 x 2.00;ZN;	2	
Z31	1000311963	SCREW;HH;375-16 x 1.25;ZN;	2	
Z32	1000308436	WASHER;FLT;USS;Φ0.344XΦ0.875X.063;ZN;	14	
Z33	1000310088	Washer, Curved, 1/2"	9	
Z35	1000312161	NUT;NLK;500-13;ZN	4	
Z36	1000309858	Machine Bushing 3/8 ID x 5/8OD 18ga Zinc	4	
Z37	1000308428	3/8" NUT	4	
Z38	1000309854	1/4" NYLON JAM NUT	2	
Z40	1000308448	5/16" X 1 1/2" BOLT	4	
Weight Stack Set	1000421546	Weight Stack Assy;Stepped;#390;	1	
Weight Stack 1	1000310334	6000 TOP PLATE	1	
Weight Stack 2	1000310343	Orange SELECTOR PIN w/ 6 1/2" CORD	1	
Weight Stack 3	1000312817	5/16" SPLIT LOCK WASHER	2	

Weight Stack 4	1000312127	BHS 5/16" - 1"	2	
Weight Stack 6	1000359722	2" OD x .562 ID x .187 F/W Zinc	1	
Weight Stack 7	1000421547	Center Stick;19";CR3;	1	
Weight Stack 8	1000321944	WEIGHT PLATE 20# W_BUSHINGS 18.4 X 4.3X 1	13	
Weight Stack 9	1000312880	CAST IRON	5	
Coupler Set	1000344108	900 Series Coupler Kit;Metal	2	Non FS version only.
Coupler 1	1000337789	連接片;;;SPHC;186x76.2x23.4x4.76T;;	2	Non FS version only.
Coupler 2	1000314246	SCREW;HH;;375-16 x 3.50;ZN;	1	Non FS version only.
Coupler 3	1000308444	WASHER;FLT;USS;Ø0.406XØ1.000X.063;ZN;	2	Non FS version only.
Coupler 4	1000308428	3/8" NUT	1	Non FS version only.
Coupler 5	1000342964	Pipe;3/4" OD x 1/2" ID;w/ Zinc Coating;	1	Non FS version only.

MG-FS921-06				
Reference #	Part #	Description	Qty	Notes
AB1	1000353447	Frame Set;900 Series;Iced Silver	1	
AB1	1000353448	Frame Set;900 Series;Black Glossy	1	
AB1	1000353449	Frame Set;900 Series;Lace White	1	
AB2	1000360142	Main Frame User Side Assy;921;Iced Silver	1	
AB2	1000360143	Main Frame User Side Assy;921;Black Glossy	1	
AB2	1000360144	Main Frame User Side Assy;921;Lace White	1	
AB5	1000393455	Knee Hold Down Chrome w/ Decals;921;	1	
AB6	1000328373	WELDMENT TIP OVER FOOT;Iced Silver	1	Only on FS version.
AB6	1000328374	WELDMENT TIP OVER FOOT;Black Glossy	1	Only on FS version.
AB6	1000328375	WELDMENT TIP OVER FOOT;Lace White	1	Only on FS version.
B3	1000313766	HARD CHROME 48" LAT BAR	1	
B4	1000338388	Plug;Seat Post;	1	
B6	1000310302	6" CABLE PULLEY w/ NARROW BUSHING	2	
B7	1000312893	3/8" SAFETY CLIP	1	
B8	1000379407	Spring Pin Assy;1.313 Body;	1	
B9	1000421275	Cable Assy;921;	1	
B10	1000310014	End Cap	1	
B11	1000321910	5/8" GUIDE ROD - 76"	2	
B14	1000421272	Weight Stack Bracket;900 SRS;	1	
B17	1000310339	ROUND WEIGHT STACK BUMPER	2	
B18	1000345600	5/8" Single Split Collar	2	
B19	1000310273	4" FOOT (SHORT)	2	
B20	1000312237	3" FOOT	2	
B24	1000310331	10ga PLASMA - 1 1/2" x 5 1/4"	1	
B46	1000350082	SAFETY TAPE 18"X 4" LAT BAR	1	
B49	1000312233	3" ROUND END CAP	2	
B50	1000317727	5/8" RUBBER GROMMET	2	
B51	1000342962	Stack Guard;Grey;	1	Only on FS version.
J11	See Pad Matrix	UPHOLSTERY	1	
J21	See Pad Matrix	Pad; seat;Hazelnut	1	
V1	1000363760	Decal;Warning;Multi Station;English	1	Non FS version only.
V1	1000363756	Decal;Warning;Multi Station;French	1	Non FS version only.
V40	1000421523	900 Step Stack Decal	1	
V41	1000312342	BOLT DOWN WARNING	1	
V42	1000384006	Serial Number Label;4" x 1.5";3M;	2	
V43	1000315894	DECAL MATRIX 11X1 BLK	1	
V44	1000359953	Decal;Warning;Single Station;English	1	
V44	1000364025	Decal;Warning;Single Station;French	1	
V45	1000308473	Decal, warning Hand Pinch	3	
Z25	1000308446	WASHER;FLT;USS;Φ0.281XΦ0.734X.063;ZN;	6	Only on FS version.
Z26	1000310219	SCREW;HH;250-20 x 0.75;ZN;	6	Only on FS version.
Z27	1000309953	SCREW;HH;313-18 x 1.25;ZN;	2	
Z28	1000312099	HCS 1/2-13 x 4 1/4"	4	
Z29	1000309851	HCS 3/8-16 x 2 1/4" - ZINC	2	
Z30	1000310097	SCREW;HH;250-20 x 2.00;ZN;	2	
Z31	1000311963	SCREW;HH;375-16 x 1.25;ZN;	2	
Z32	1000308436	WASHER;FLT;USS;Φ0.344XΦ0.875X.063;ZN;	14	
Z33	1000310088	Washer, Curved, 1/2"	9	
Z35	1000312161	NUT;NLK;500-13;ZN	4	
Z36	1000309858	Machine Bushing 3/8 ID x 5/8OD 18ga Zinc	4	
Z37	1000308428	3/8" NUT	4	
Z38	1000309854	1/4" NYLON JAM NUT	2	
Z40	1000308448	5/16" X 1 1/2" BOLT	4	
Weight Stack Set	1000421546	Weight Stack Assy;Stepped;#390;	1	
Weight Stack 1	1000310334	6000 TOP PLATE	1	
Weight Stack 2	1000310343	Orange SELECTOR PIN w/ 6 1/2" CORD	1	
Weight Stack 3	1000312817	5/16" SPLIT LOCK WASHER	2	

Weight Stack 4	1000312127	BHS 5/16" - 1"	2	
Weight Stack 6	1000359722	2" OD x .562 ID x .187 F/W Zinc	1	
Weight Stack 7	1000421547	Center Stick;19";CR3;	1	
Weight Stack 8	1000321944	WEIGHT PLATE 20# W_BUSHINGS 18.4 X 4.3X 1	13	
Weight Stack 9	1000312880	CAST IRON	5	
Coupler Set	1000344108	900 Series Coupler Kit;Metal	2	Non FS version only.
Coupler 1	1000337789	連接片;;;SPHC;186x76.2x23.4x4.76T;;	2	Non FS version only.
Coupler 2	1000314246	SCREW;HH;375-16 x 3.50;ZN;	1	Non FS version only.
Coupler 3	1000308444	WASHER;FLT;USS;Φ0.406XΦ1.000X.063;ZN;	2	Non FS version only.
Coupler 4	1000308428	3/8" NUT	1	Non FS version only.
Coupler 5	1000342964	Pipe;3/4" OD x 1/2" ID;w/ Zinc Coating;	1	Non FS version only.

Matrix FS921 Lat Pulldown

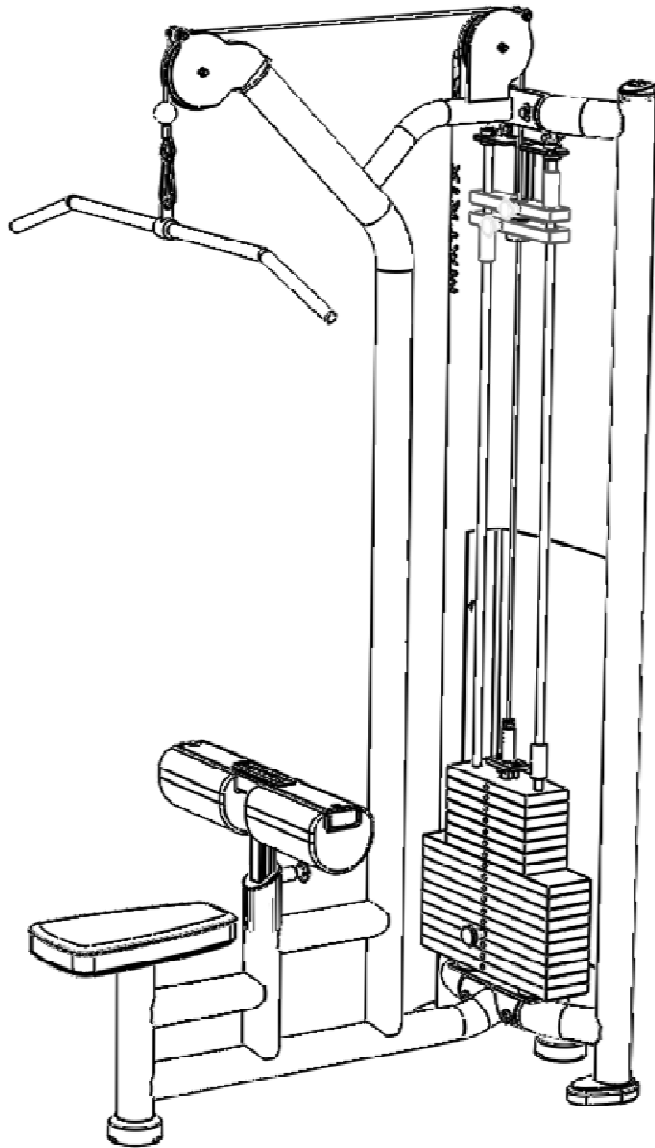

Quantity

1

862-040
Serial plate
Non - EN

MATRIX

Model: XXXXXXXXX Max User Weight: XXX lbs
 S/N: XXXXXXXXXXXXXXXX Max Training Weight: XXX lbs
 Mfg Date: XX-XX-XXXX EN957-1, EN957-2 Class 8

UPC

Matrix Fitness
1600 Landmark Dr
Cottage Grove, WI 53027
(888) 695-4863

2

854-044
280 mm Matrix



1

854-982
Bolt down

WARNING

DO NOT USE equipment if not properly secured to floor. Manufacturer requires that this equipment be secured to the floor to stabilize and eliminate rocking or tipping over. Use a licensed contractor.

1

854-987
Single
Station

WARNING

SEVERE INJURY CAN OCCUR ON THIS EQUIPMENT. FOLLOW THESE PRECAUTIONS TO AVOID INJURY!

- Never allow children on strength training equipment. Always read the equipment's manual before using the equipment.
- All warnings and instructions should be read and proper instructions should be followed.
- Use this equipment for its intended purpose only.
- NEVER grab resistance straps, ropes or other means to be attached to the equipment, as this may result in serious injury.
- NEVER use this equipment for non-approved activities, as this may result in serious injury.
- Always inspect the machine before use. Do NOT use machine if it appears damaged or defective.
- Keep body hair, clothing, and shoes clean and free from oil or all moving parts.
- Always inspect the machine before use. Do NOT use machine if it appears damaged or defective.
- Check to see that the selector pin is properly inserted into the weight stack.
- Do NOT use the machine with the weight stack removed or unsecured.
- NEVER use dumbbells or other weights in combination with the weight resistance. Only use the weight resistance provided from the manufacturer.
- DO NOT REMOVE THIS LABEL, REPLACE IF DAMAGED OR ILLEGIBLE.

3

854-985
Pinch
hazard



1

862-360 Weight Stack

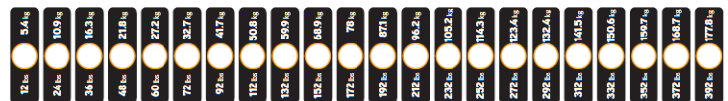

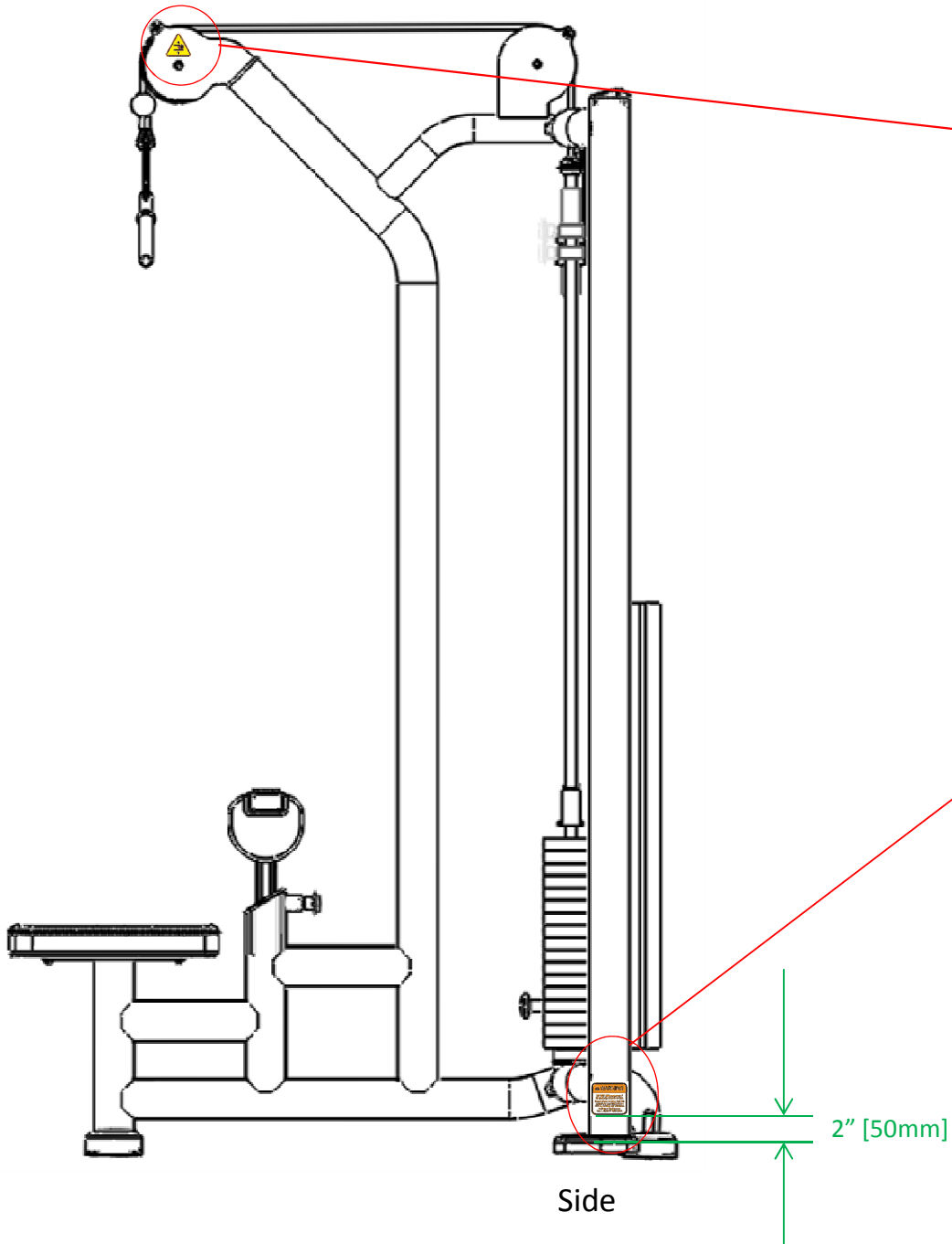

854-985
Pinch
hazard



854-982
Bolt down

DO NOT USE equipment if
not properly secured to floor.
Manufacturer requires that this
equipment be secured to the
floor to stabilize and eliminate
rocking or tipping over.
Use a licensed contractor.

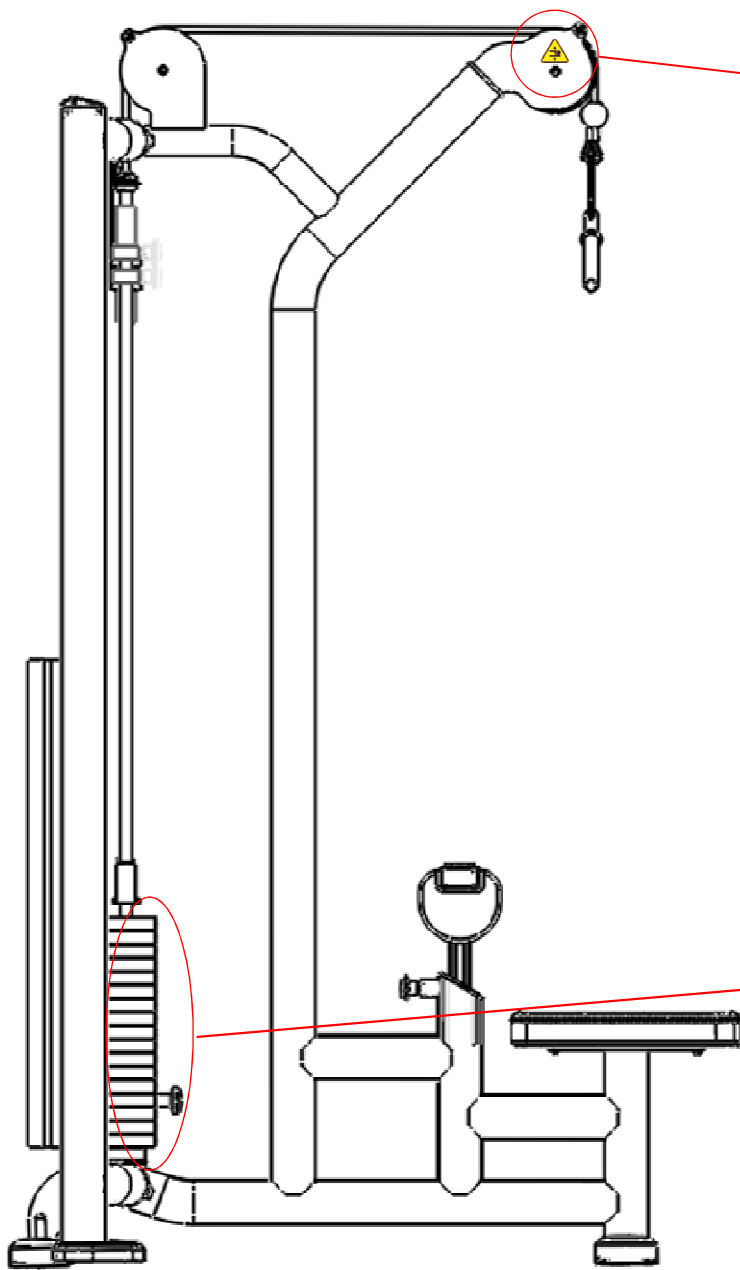

854-985
Pinch
hazard

862-360 Weight Stack

- 12 lb 5.4 kg
- 24 lb 10.9 kg
- 36 lb 16.3 kg
- 48 lb 21.8 kg
- 60 lb 27.2 kg
- 72 lb 32.7 kg
- 92 lb 41.7 kg
- 112 lb 50.8 kg
- 132 lb 59.9 kg
- 152 lb 68.9 kg
- 172 lb 78 kg
- 192 lb 87.1 kg
- 212 lb 96.2 kg
- 232 lb 105.2 kg
- 252 lb 114.3 kg
- 272 lb 123.4 kg
- 292 lb 132.4 kg
- 312 lb 141.5 kg
- 332 lb 150.6 kg
- 352 lb 159.7 kg
- 372 lb 168.7 kg
- 392 lb 177.8 kg

Side

280mm
MATRIX

854 - 044
 280 mm Matrix

9" [230mm]



854-985
 Pinch
 hazard

854-987
 Single
 Station

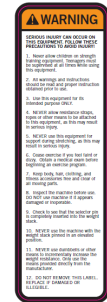

862-040
 Serial plate
 Non - EN

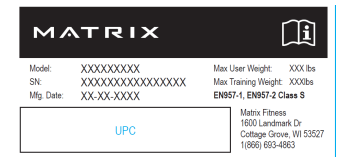

1" [25mm]

1" [25mm]

Front

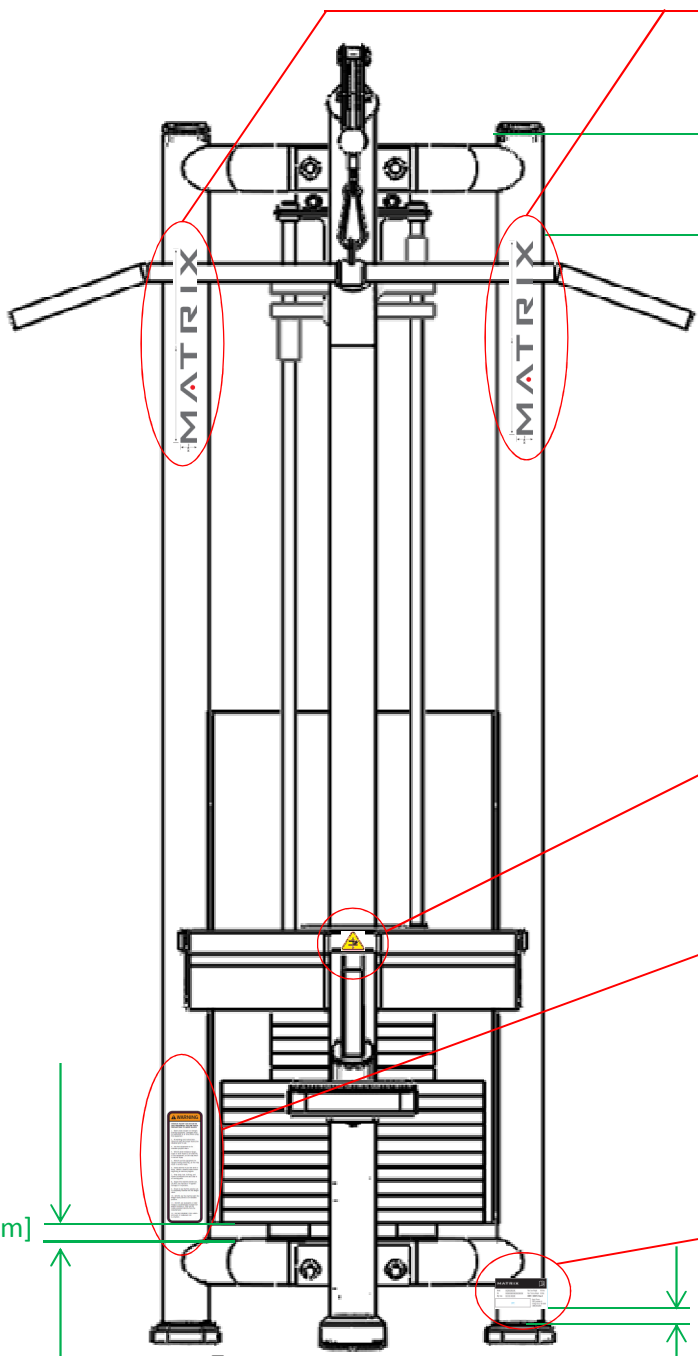

Matrix QC template

854-043
166mm Matrix

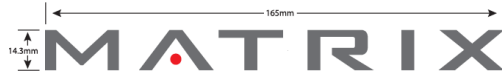

854-044
280mm Matrix

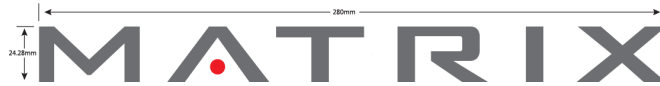

854-857
Serial plate

MATRIX		
Model: XXXXXXXXX	Max User Weight: XXX lbs	
S/N: XXXXXXXXXXXXXXXX	Max Training Weight: XXXXlbs	
Mfg Date: XXX-XX-XXXX	EN57-1, EN57-2 Class S	
UPC		Matrix Fitness 1600 Landmark Dr Cottage Grove, WI 53527 (800) 655-4863

862-040
Serial plate
Non - EN

MATRIX		
Model: XXXXXXXXX	Max User Weight: XXX lbs	
S/N: XXXXXXXXXXXXXXXX	Max Training Weight: XXXXlbs	
Mfg Date: XX-XX-XXXX	EN57-1, EN57-2 Class S	
UPC		Matrix Fitness 1600 Landmark Dr Cottage Grove, WI 53527 (800) 655-4863



854-985
Pinch hazard



854-986
Moving hazard



Weight horn caps

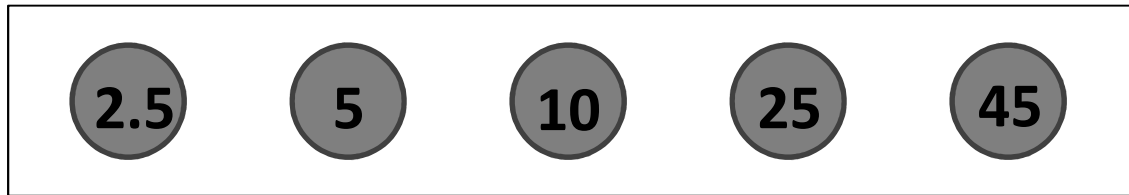

854-982
Bolt down



854-984
Sled L Press

WARNING
<p>DEATH OR SERIOUS INJURY CAN OCCUR ON THIS EQUIPMENT. FOLLOW THESE PRECAUTIONS TO AVOID INJURY!</p> <ol style="list-style-type: none"> NEVER allow children on strength training equipment. Teenagers must be supervised at all times while using this equipment. All warnings and instructions should be read and proper instruction obtained prior to use. Use this equipment for its intended purpose ONLY. Inspect the machine before use. DO NOT use machine if it appears damaged or inoperable. NEVER allow resistance straps, ropes or other means to be attached to this equipment, as this may result in serious injury. NEVER use this equipment for support during stretching, as this may result in serious injury. Adjusters use a spacer. Do not exceed the weight capacity of this equipment. Balance the weight applied to this equipment and/or any barbell. Where applicable, use vibration devices to inhibit weight discs. Caution exercise if you feel faint or dizzy. Obtain a medical exam before beginning an exercise program. Keep body, hair, clothing, and shoes accurate free and clear of all moving parts. Manufacturer recommends that all equipment be secured to the floor to stabilize and eliminate rocking or tipping over. Use a licensed contractor. DO NOT REMOVE THIS LABEL. REPLACE IF DAMAGED OR ILLISIBLE. <p style="text-align: center;">Working Bench</p>

854-978
Oly bench

WARNING
<p>DEATH OR SERIOUS INJURY CAN OCCUR ON THIS EQUIPMENT. FOLLOW THESE PRECAUTIONS TO AVOID INJURY!</p> <ol style="list-style-type: none"> NEVER allow children on strength training equipment. Teenagers must be supervised at all times while using this equipment. All warnings and instructions should be read and proper instruction obtained prior to use. Use this equipment for its intended purpose ONLY. Inspect the machine before use. DO NOT use machine if it appears damaged or inoperable. NEVER allow resistance straps, ropes or other means to be attached to this equipment, as this may result in serious injury. NEVER use this equipment for support during stretching, as this may result in serious injury. Adjusters use a spacer. Do not exceed the weight capacity of this equipment. Balance the weight applied to this equipment and/or any barbell. Where applicable, use vibration devices to inhibit weight discs. Caution exercise if you feel faint or dizzy. Obtain a medical exam before beginning an exercise program. Keep body, hair, clothing, and shoes accurate free and clear of all moving parts. Manufacturer recommends that all equipment be secured to the floor to stabilize and eliminate rocking or tipping over. Use a licensed contractor. DO NOT REMOVE THIS LABEL. REPLACE IF DAMAGED OR ILLISIBLE. <p style="text-align: center;">Working Bench</p>

854-983
W bench

WARNING
<p>DEATH OR SERIOUS INJURY CAN OCCUR ON THIS EQUIPMENT. FOLLOW THESE PRECAUTIONS TO AVOID INJURY!</p> <ol style="list-style-type: none"> NEVER allow children on strength training equipment. Teenagers must be supervised at all times while using this equipment. All warnings and instructions should be read and proper instruction obtained prior to use. Use this equipment for its intended purpose ONLY. Inspect the machine before use. DO NOT use machine if it appears damaged or inoperable. NEVER allow resistance straps, ropes or other means to be attached to this equipment, as this may result in serious injury. NEVER use this equipment for support during stretching, as this may result in serious injury. Adjusters use a spacer. Do not exceed the weight capacity of this equipment. Balance the weight applied to this equipment and/or any barbell. Where applicable, use vibration devices to inhibit weight discs. Caution exercise if you feel faint or dizzy. Obtain a medical exam before beginning an exercise program. Keep body, hair, clothing, and shoes accurate free and clear of all moving parts. Manufacturer recommends that all equipment be secured to the floor to stabilize and eliminate rocking or tipping over. Use a licensed contractor. DO NOT REMOVE THIS LABEL. REPLACE IF DAMAGED OR ILLISIBLE. <p style="text-align: center;">Working Bench</p>

854-981
Smith Machine

WARNING
<p>DEATH OR SERIOUS INJURY CAN OCCUR ON THIS EQUIPMENT. FOLLOW THESE PRECAUTIONS TO AVOID INJURY!</p> <ol style="list-style-type: none"> NEVER allow children on strength training equipment. Teenagers must be supervised at all times while using this equipment. All warnings and instructions should be read and proper instruction obtained prior to use. Use this equipment for its intended purpose ONLY. Inspect the machine before use. DO NOT use machine if it appears damaged or inoperable. NEVER allow resistance straps, ropes or other means to be attached to this equipment, as this may result in serious injury. NEVER use this equipment for support during stretching, as this may result in serious injury. Adjusters use a spacer. Do not exceed the weight capacity of this equipment. Balance the weight applied to this equipment and/or any barbell. Where applicable, use vibration devices to inhibit weight discs. Caution exercise if you feel faint or dizzy. Obtain a medical exam before beginning an exercise program. Keep body, hair, clothing, and shoes accurate free and clear of all moving parts. Manufacturer recommends that all equipment be secured to the floor to stabilize and eliminate rocking or tipping over. Use a licensed contractor. DO NOT REMOVE THIS LABEL. REPLACE IF DAMAGED OR ILLISIBLE. <p style="text-align: center;">Smith Machine</p>

854-987
Single Station

WARNING
<p>DEATH OR SERIOUS INJURY CAN OCCUR ON THIS EQUIPMENT. FOLLOW THESE PRECAUTIONS TO AVOID INJURY!</p> <ol style="list-style-type: none"> NEVER allow children on strength training equipment. Teenagers must be supervised at all times while using this equipment. All warnings and instructions should be read and proper instruction obtained prior to use. Use this equipment for its intended purpose ONLY. Inspect the machine before use. DO NOT use machine if it appears damaged or inoperable. NEVER allow resistance straps, ropes or other means to be attached to this equipment, as this may result in serious injury. NEVER use this equipment for support during stretching, as this may result in serious injury. Adjusters use a spacer. Do not exceed the weight capacity of this equipment. Balance the weight applied to this equipment and/or any barbell. Where applicable, use vibration devices to inhibit weight discs. Caution exercise if you feel faint or dizzy. Obtain a medical exam before beginning an exercise program. Keep body, hair, clothing, and shoes accurate free and clear of all moving parts. Manufacturer recommends that all equipment be secured to the floor to stabilize and eliminate rocking or tipping over. Use a licensed contractor. DO NOT REMOVE THIS LABEL. REPLACE IF DAMAGED OR ILLISIBLE. <p style="text-align: center;">Smith Machine</p>

854-979
ADJ stop 1



854-980
ADJ stop 2

