

FS942-06
(EXPLODED VIEW ON SHEET 1)

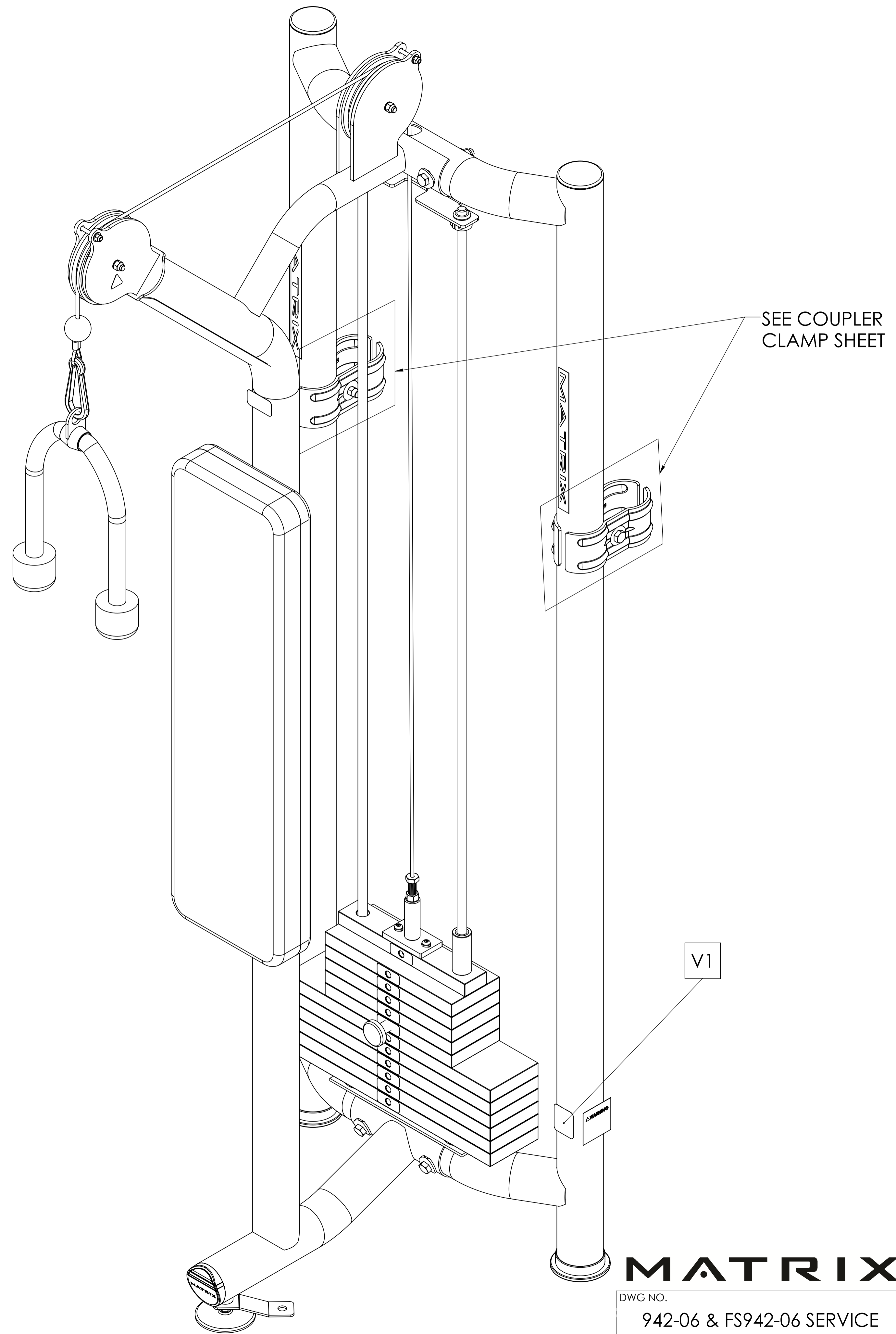

942-06
(REQUIRES COUPLER CLAMPS)

MATRIX

DWG NO.		942-06 & FS942-06 SERVICE	
DESCRIPTION:		TRICEPS PUSHDOWN (Strength Multi-Station)	
DRAWN BY:	LMB	DATE:	2018.JAN.22
UPDATED BY:		DATE:	

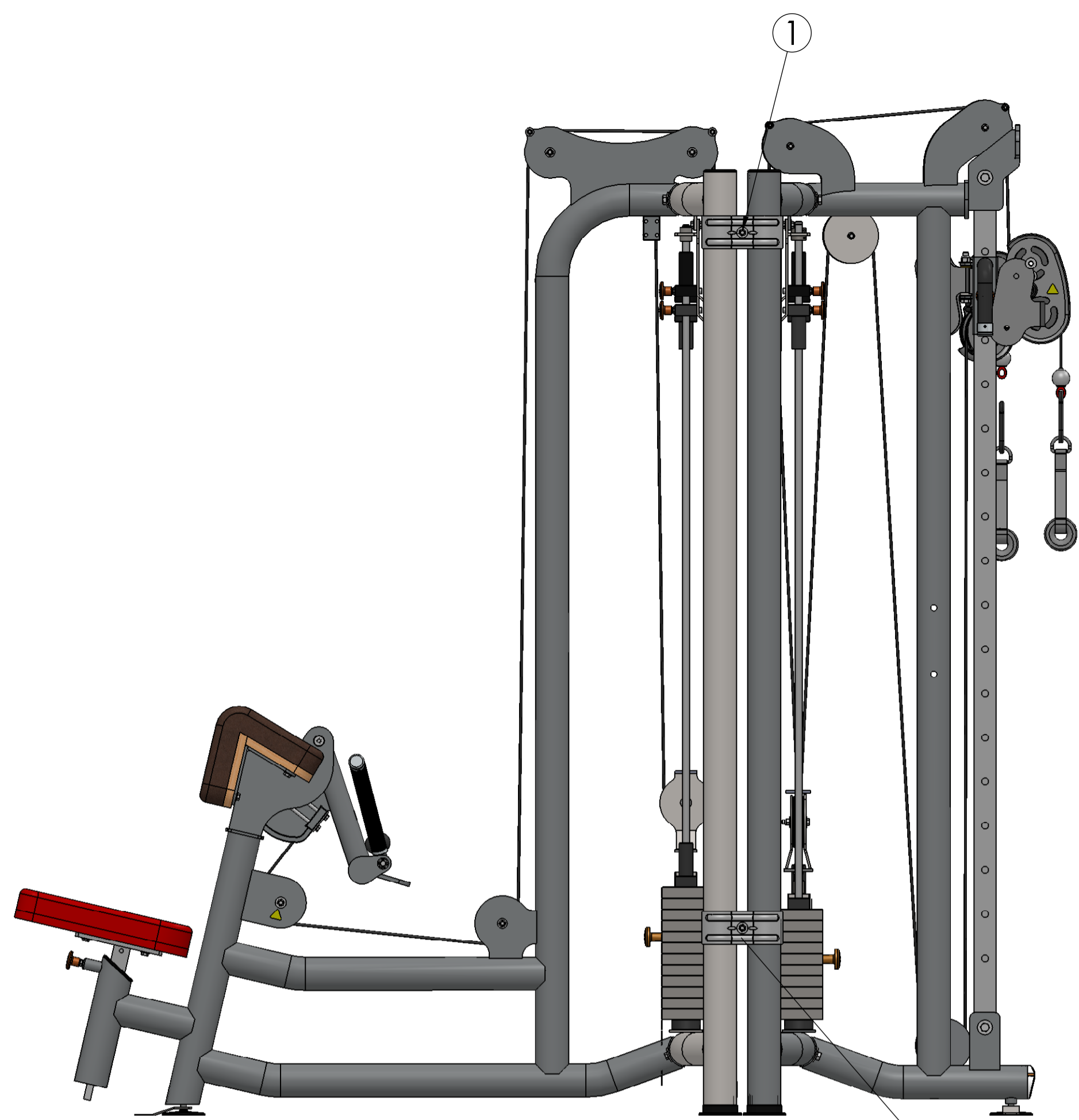

TWO STACK

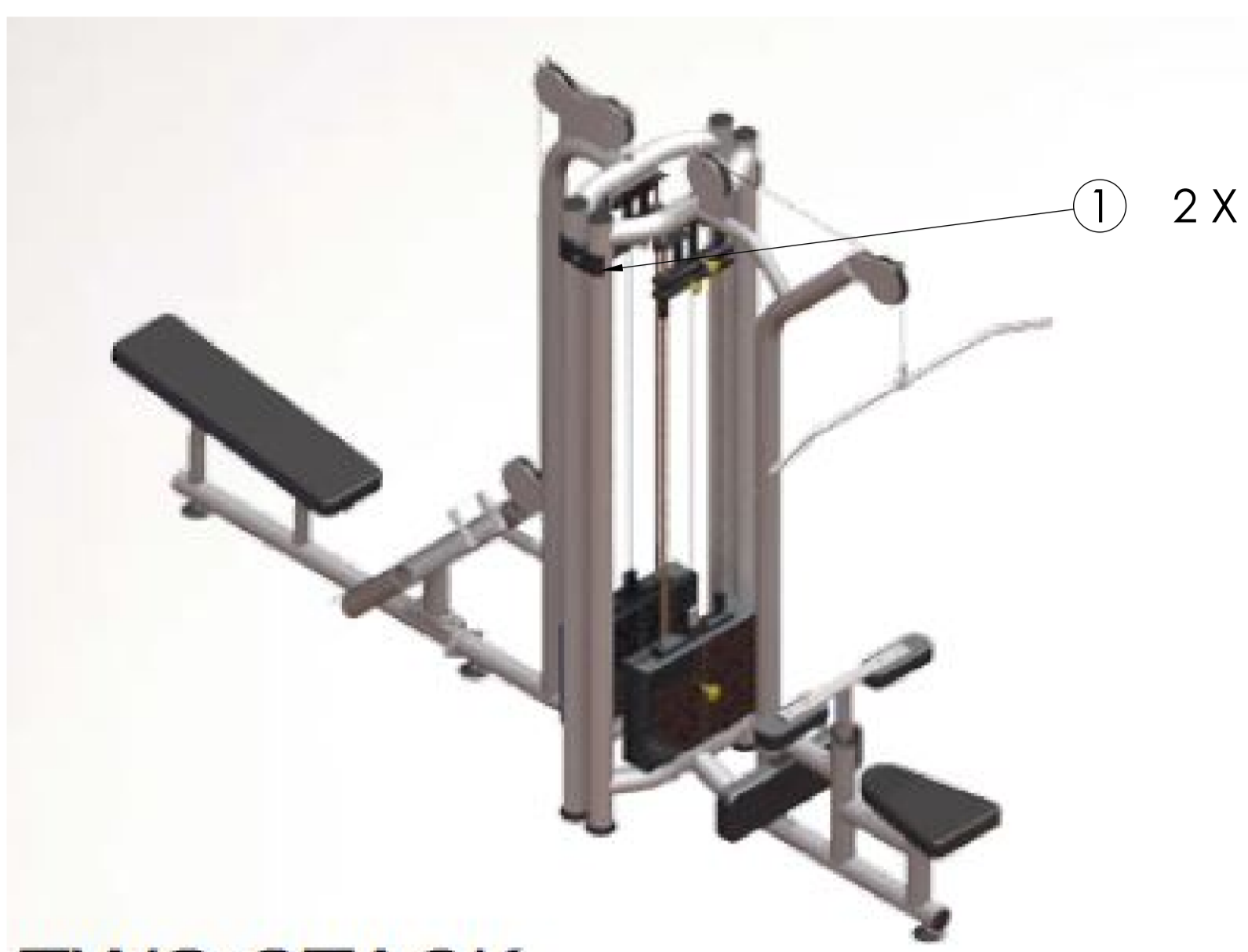

TWO STACK

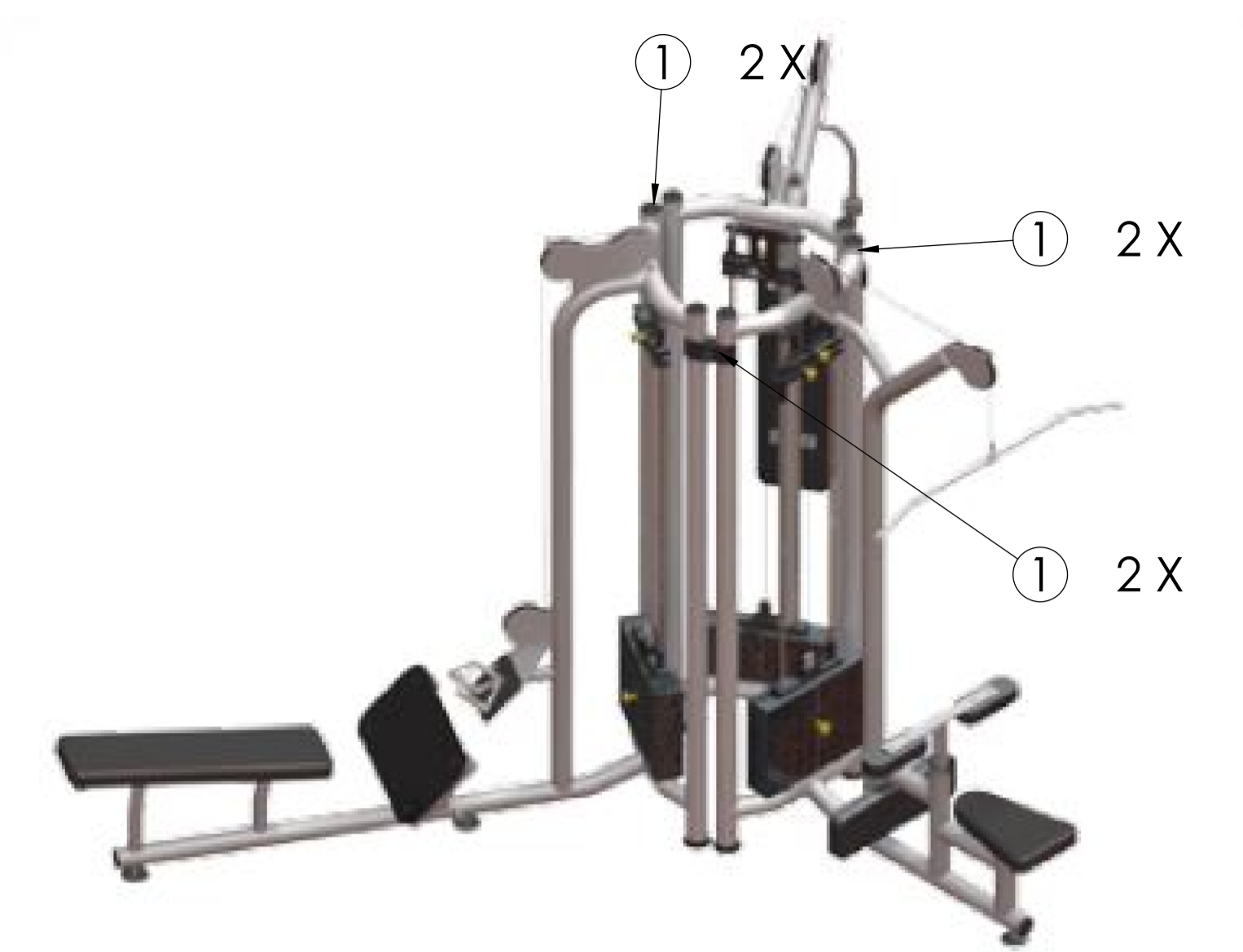

THREE STACK

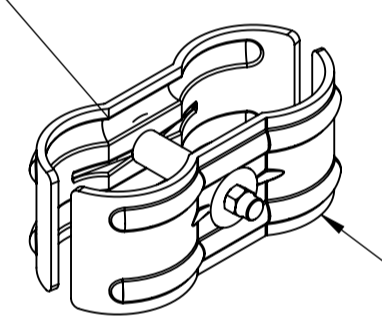

EXPLODED VIEW SHOWN ON SHEET 1
 NOTE: QUANTITY REQUIRED FOR EACH CONFIGURATION WILL VARY
 (CONFIGURATIONS SHOWN ARE FOR REFERENCE ONLY)

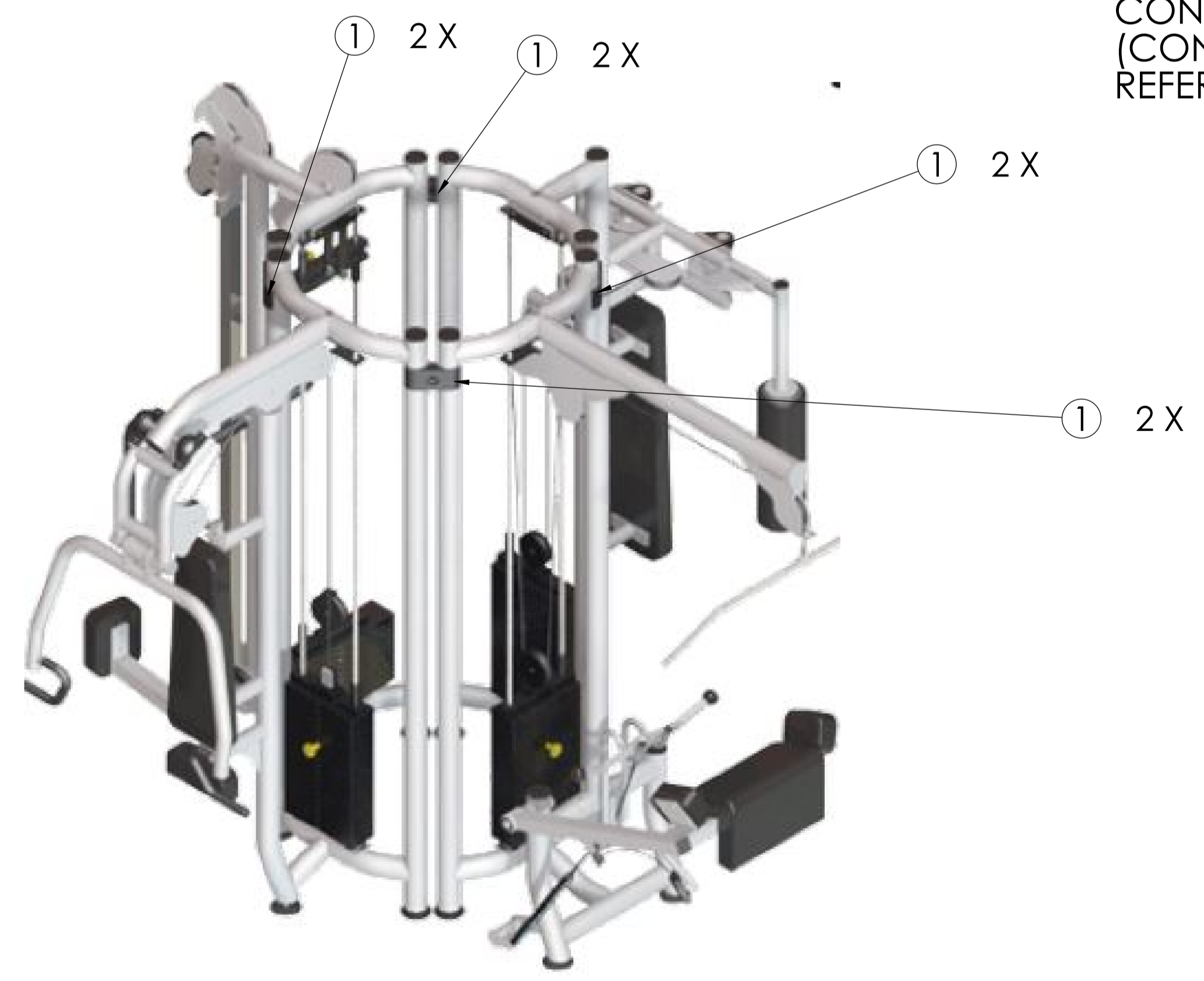

FOUR STACK

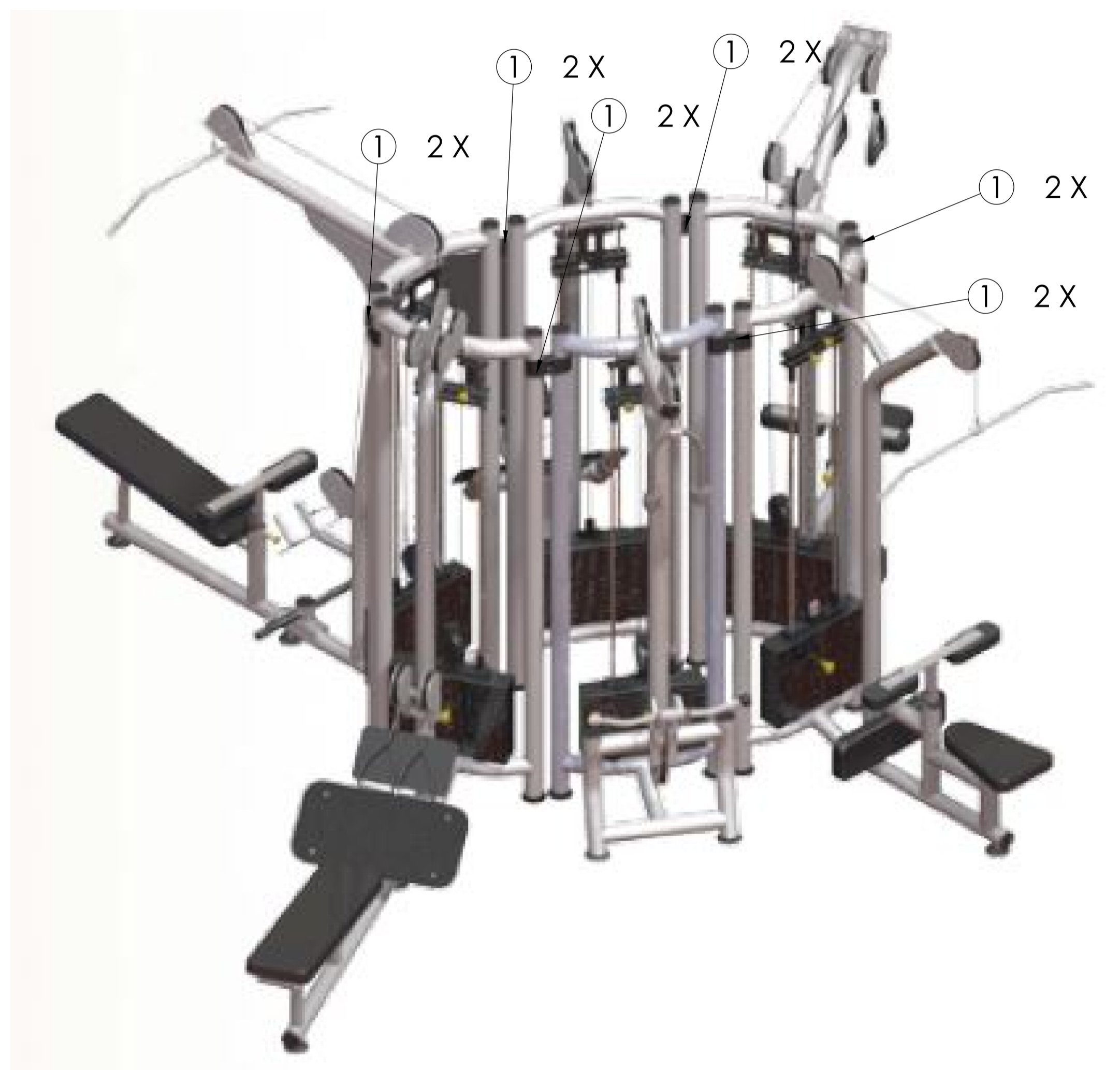

SIX STACK

MATRIX

DWG NO.		160-257 SERVICE	
DESCRIPTION:		COUPLER(CONFIGURATIONS) (Strength - Multi Station)	
DRAWN BY:	LMB	DATE:	2016.JAN.14
UPDATED BY:		DATE:	

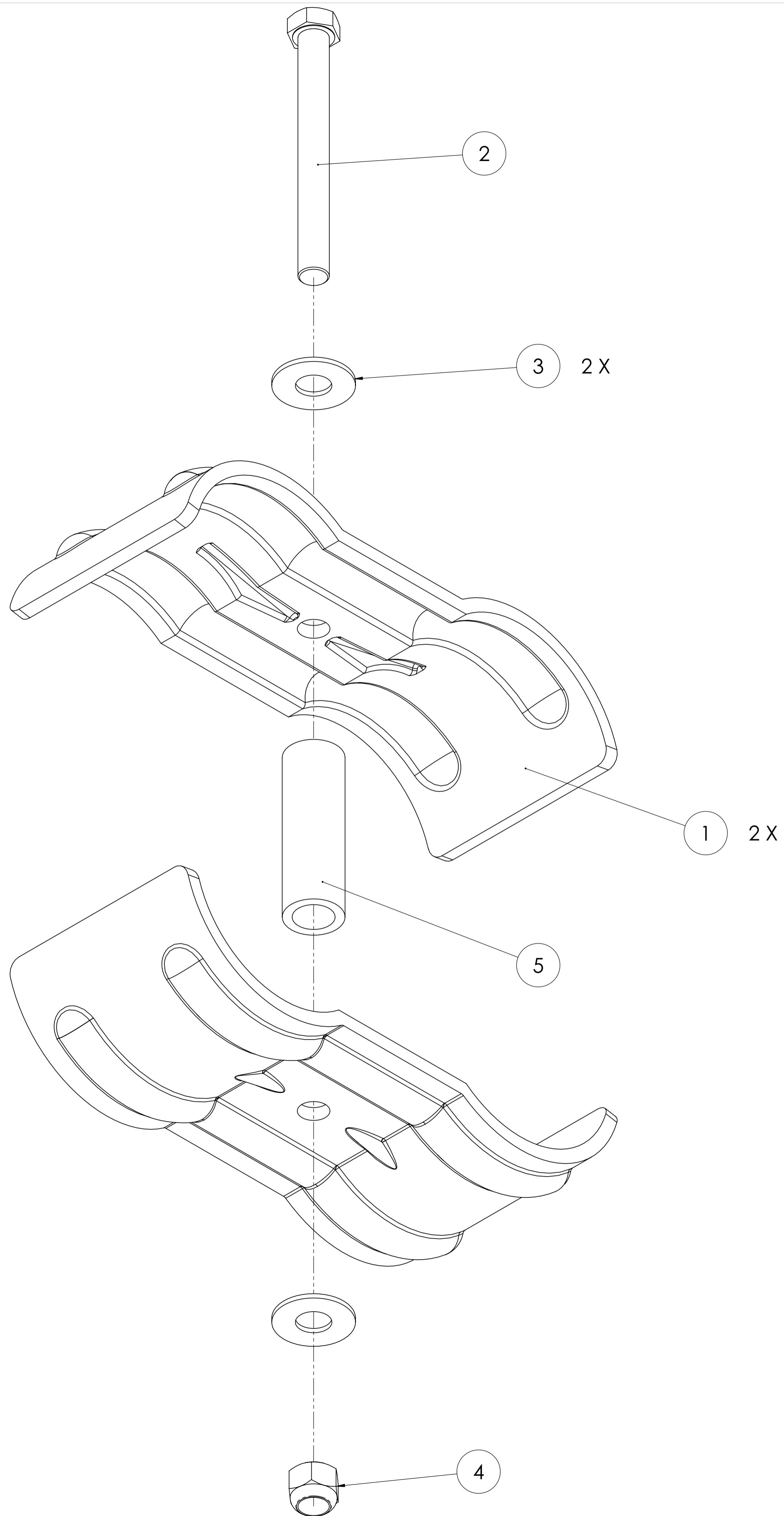

MATRIX

DWG NO.

160-257 SERVICE

DESCRIPTION:

900 SERIES TOWER CLAMP (SINGLE)
(Strength - Multi Station)

DRAWN BY: LMB

DATE: 2016.JAN.14

UPDATED BY:

DATE:

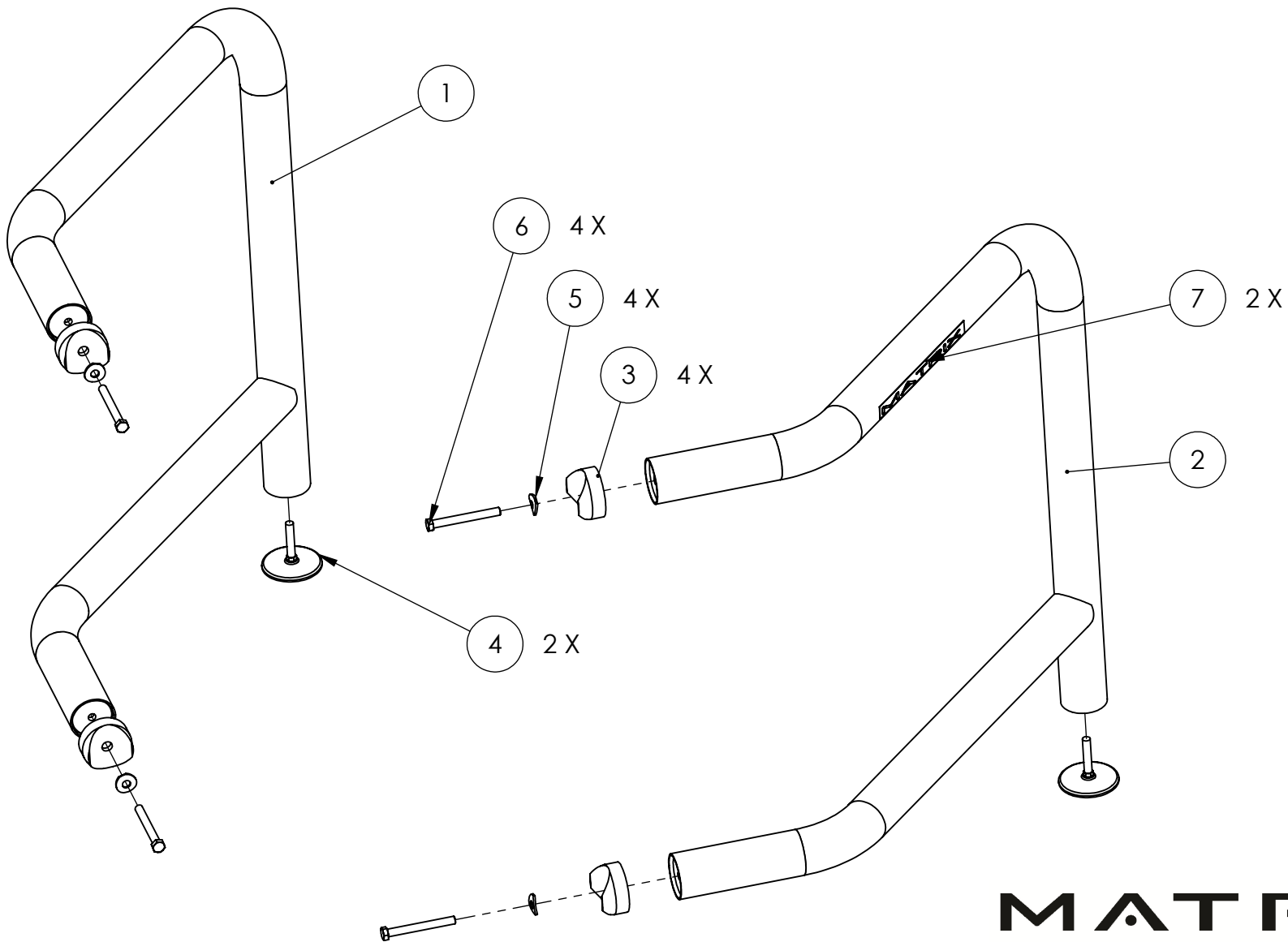

MATRIX

DWG. NO.		160-122 SERVICE	
DESCRIPTION: 900 TOWER SERIES FREE STANDING (SIDES)			
DRAWN:	LMB	DATE	13.08.06
UPDATED:	--	DATE	--

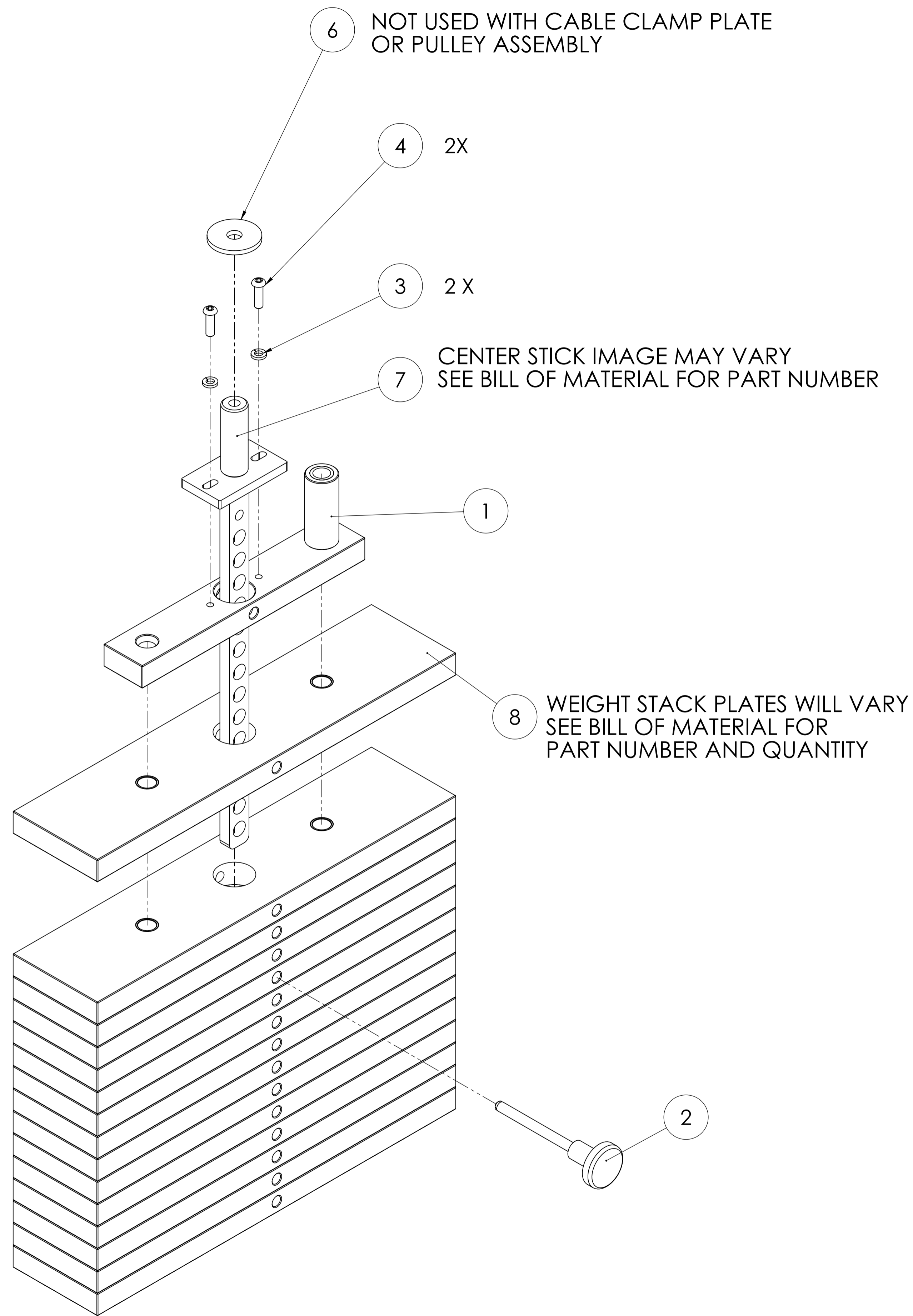

**CENTER STICK WITH MOUNTING POST
CABLE MOUNTED WITH TAKE UP BOLT OR PULLEY
(SHOWN EXPLODED)
SEE NOTES AND BOM FOR PART NUMBERS**

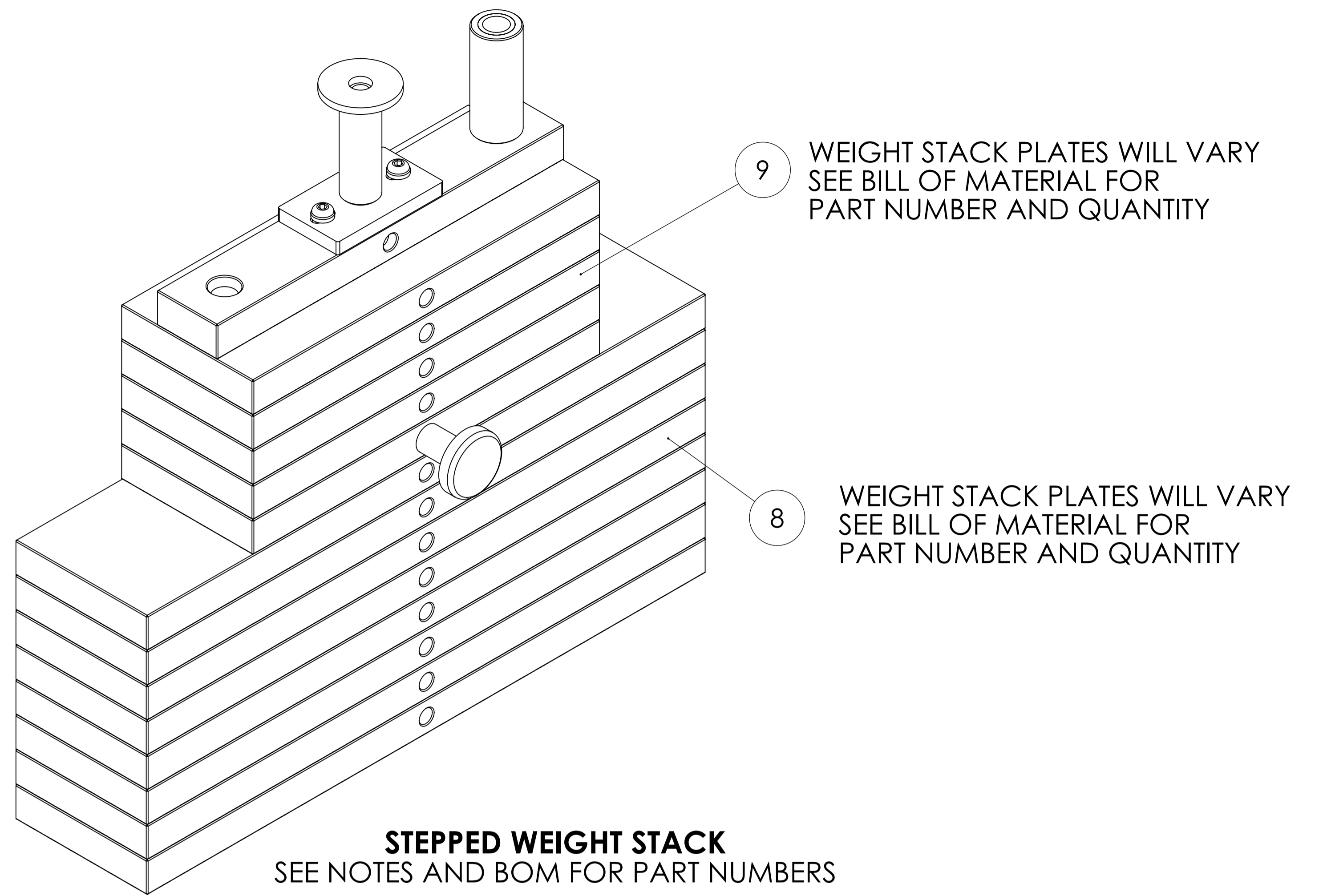

**STEPPED WEIGHT STACK
SEE NOTES AND BOM FOR PART NUMBERS**

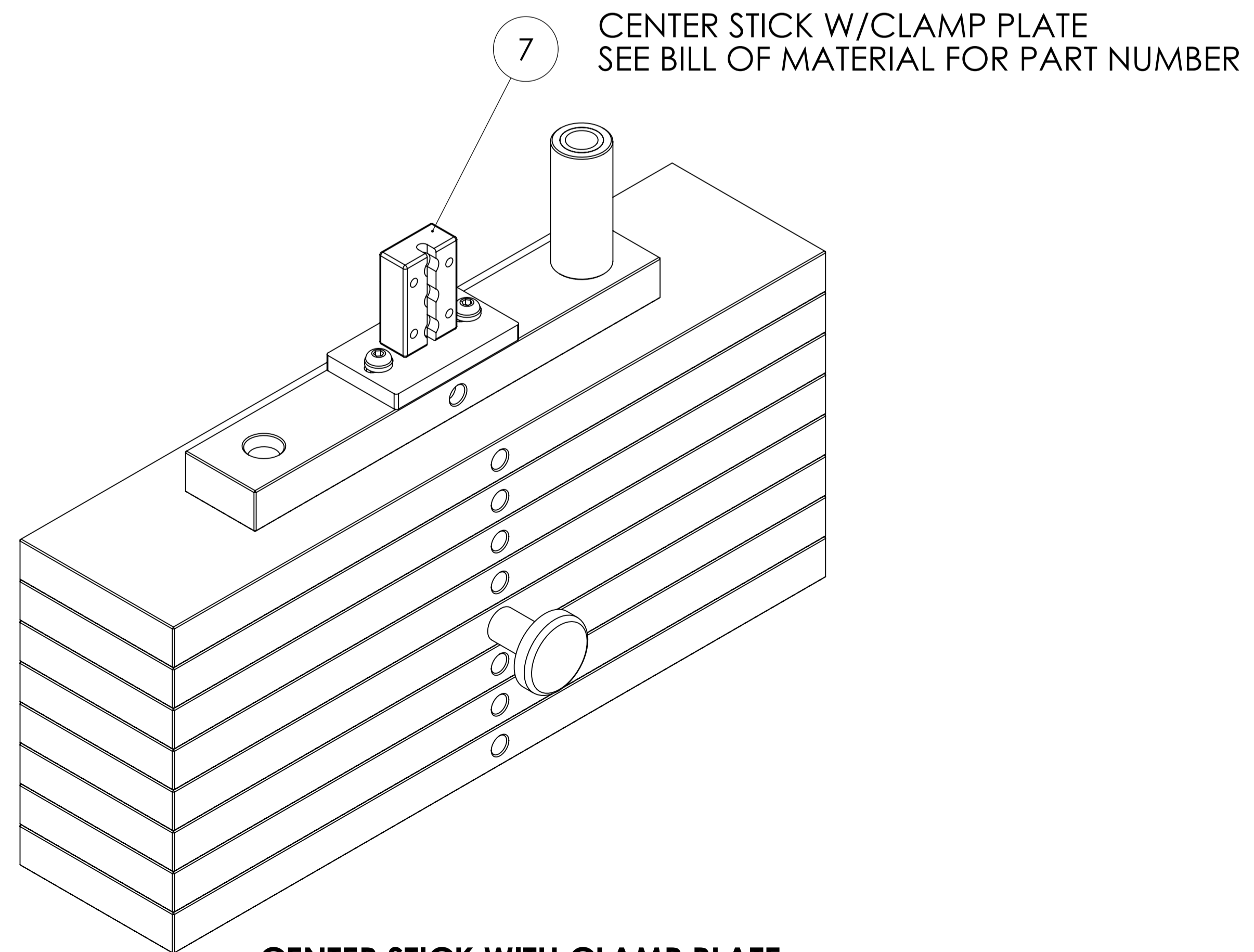

**CENTER STICK WITH CLAMP PLATE
SEE NOTES AND BOM FOR PART NUMBERS**

MATRIX

DWG NO. _WEIGHT STACK SERVICE		
DESCRIPTION: WEIGHT STACK/CENTERSTICK ASSY (Take Up Bolt, Pulley & Clamp Style)		
DRAWN BY: LMB	DATE: 2013.OCT.10	
UPDATED BY: LMB	DATE: 2017.DEC.29	

MG-942-06				
Reference #	SAP Part #	Description	Qty	Notes
AB1	1000398796	Main Frame Assy;942;Iced Silver	1	
AB1	1000398797	Main Frame Assy;942;Black Glossy	1	
AB1	1000344197	Main Frame Assy;942;Lace White	1	
AB2	1000353447	Frame Set;900 Series;Iced Silver	1	
AB2	1000353448	Frame Set;900 Series;Black Glossy	1	
AB2	1000353449	Frame Set;900 Series;Lace White	1	
AB5	1000328373	WELDMENT TIP OVER FOOT;Iced Silver	1	Only on FS version.
AB5	1000328374	WELDMENT TIP OVER FOOT;Black Glossy	1	Only on FS version.
AB5	1000328375	WELDMENT TIP OVER FOOT;Lace White	1	Only on FS version.
B4	1000421272	Weight Stack Bracket;900 SRS;	1	
B5	1000421278	Cable Assy;942;	1	
B6	1000310302	6" CABLE PULLEY w/ NARROW BUSHING	2	
B21	1000310014	End Cap	1	
B26	1000321910	5/8" GUIDE ROD - 76"	2	
B27	1000310339	ROUND WEIGHT STACK BUMPER	2	
B28	1000310273	4" FOOT (SHORT)	1	
B29	1000345600	5/8" Single Split Collar	2	
B30	1000312237	3" FOOT	2	
B42	1000312233	3" ROUND END CAP	2	
B43	1000350082	SAFETY TAPE 18"X 4" LAT BAR	1	
B44	1000313871	TRICEP ROPE (MA-TA)	1	
B46	1000312893	3/8" SAFETY CLIP	1	
B47	1000317727	5/8" RUBBER GROMMET	2	
B48	1000342962	Stack Guard;Grey;	1	Only on FS version.
B49	1000310331	10ga PLASMA - 1 1/2" x 5 1/4"	1	
J31	See Pad Matrix	ASSEMBLY; PAD;	1	
V1	1000359953	Decal;Warning;Single Station;English	1	Non FS version only.
V1	1000364025	Decal;Warning;Single Station;French	1	Non FS version only.
V32	1000384006	Serial Number Label;4" x 1.5";3M;	1	
V33	1000363760	Decal;Warning;Multi Station;English	1	
V33	1000363766	Decal;Warning;Multi Station;French	1	
V34	1000315894	DECAL MATRIX 11X1 BLK	2	
V35	1000312342	BOLT DOWN WARNING	1	
V36	1000308473	Decal, warning Hand Pinch	2	
V37	1000421523	900 Step Stack Decal	1	
V38	1000421609	Warning Label	1	
Z3	1000309858	Machine Bushing 3/8 ID x 5/8OD 18ga Zinc	8	
Z7	1000312099	HCS 1/2-13 x 4 1/4"	4	
Z9	1000308448	5/16" X 1 1/2" BOLT	24	
Z10	1000310097	SCREW;HH;.250-20 x 2.00;ZN;	2	
Z11	1000309851	HCS 3/8-16 x 2 1/4" - ZINC	2	
Z12	1000311963	SCREW;HH;.375-16 x 1.25;ZN;	2	
Z13	1000310088	Washer, Curved, 1/2"	8	
Z14	1000312161	NUT;NLK;.500-13;ZN	4	
Z15	1000309854	1/4" NYLON JAM NUT	2	
Z16	1000308428	3/8" NUT	4	
Z17	1000308436	WASHER;FLT;USS;Φ0.344XΦ0.875X.063;ZN;	8	
Z18	1000308446	WASHER;FLT;USS;Φ0.281XΦ0.734X.063;ZN;	6	Only on FS version.
Z47	1000310219	SCREW;HH;.250-20 x 0.75;ZN;	6	Only on FS version.
Coupler Set	1000344108	900 Series Coupler Kit;Metal	2	
Coupler 1	1000337789	連接片;;;SPHC;186x76.2x23.4x4.76T;;	2	
Coupler 2	1000314246	SCREW;HH;.375-16 x 3.50;ZN;	1	
Coupler 3	1000308444	WASHER;FLT;USS;Φ0.406XΦ1.000X.063;ZN;	2	

Coupler 4	1000308428	3/8" NUT	1	
Coupler 5	1000342964	Pipe;3/4" OD x 1/2" ID;w/ Zinc Coating;	1	
FS Side Set	1000329670	900 TOWER SERIES FREE STANDING SIDE SET	1	Only on FS version.
Weight Stack Set	1000421610	Weight Stack Assy;Stepped;#190;	1	
Weight Stack 1	1000310334	6000 TOP PLATE	1	
Weight Stack 2	1000310343	Orange SELECTOR PIN w/ 6 1/2" CORD	1	
Weight Stack 3	1000312817	5/16" SPLIT LOCK WASHER	2	
Weight Stack 4	1000312127	BHS 5/16" - 1"	2	
Weight Stack 6	1000359722	2" OD x .562 ID x .187 F/W Zinc	1	
Weight Stack 7	1000421611	Center Stick;12";CR3;	1	
Weight Stack 8	1000321944	WEIGHT PLATE 20# W_BUSHINGS 18.4 X 4.3X 1	6	
Weight Stack 9	1000312880	CAST IRON	5	

MG-FS942-06				
Reference #	SAP Part #	Description	Qty	Notes
AB1	1000398796	Main Frame Assy;942;Iced Silver	1	
AB1	1000398797	Main Frame Assy;942;Black Glossy	1	
AB1	1000344197	Main Frame Assy;942;Lace White	1	
AB2	1000353447	Frame Set;900 Series;Iced Silver	1	
AB2	1000353448	Frame Set;900 Series;Black Glossy	1	
AB2	1000353449	Frame Set;900 Series;Lace White	1	
AB5	1000328373	WELDMENT TIP OVER FOOT;Iced Silver	1	Only on FS version.
AB5	1000328374	WELDMENT TIP OVER FOOT;Black Glossy	1	Only on FS version.
AB5	1000328375	WELDMENT TIP OVER FOOT;Lace White	1	Only on FS version.
B4	1000421272	Weight Stack Bracket;900 SRS;	1	
B5	1000421278	Cable Assy;942;	1	
B6	1000310302	6" CABLE PULLEY w/ NARROW BUSHING	2	
B21	1000310014	End Cap	1	
B26	1000321910	5/8" GUIDE ROD - 76"	2	
B27	1000310339	ROUND WEIGHT STACK BUMPER	2	
B28	1000310273	4" FOOT (SHORT)	2	
B29	1000345600	5/8" Single Split Collar	2	
B30	1000312237	3" FOOT	2	
B42	1000312233	3" ROUND END CAP	2	
B43	1000350082	SAFETY TAPE 18"X 4" LAT BAR	1	
B44	1000313871	TRICEP ROPE (MA-TA)	1	
B46	1000312893	3/8" SAFETY CLIP	1	
B47	1000317727	5/8" RUBBER GROMMET	2	
B48	1000342962	Stack Guard;Grey;	1	Only on FS version.
B49	1000310331	10ga PLASMA - 1 1/2" x 5 1/4"	1	
J31	See Pad Matrix	ASSEMBLY; PAD;	1	
V1	1000359953	Decal;Warning;Single Station;English	1	Non FS version only.
V1	1000364025	Decal;Warning;Single Station;French	1	Non FS version only.
V32	1000384006	Serial Number Label;4" x 1.5";3M;	1	
V33	1000363760	Decal;Warning;Multi Station;English	1	
V33	1000363766	Decal;Warning;Multi Station;French	1	
V34	1000315894	DECAL MATRIX 11X1 BLK	2	
V35	1000312342	BOLT DOWN WARNING	1	
V36	1000308473	Decal, warning Hand Pinch	2	
V37	1000421523	900 Step Stack Decal	1	
V38	1000421609	Warning Label	1	
Z3	1000309858	Machine Bushing 3/8 ID x 5/8OD 18ga Zinc	8	
Z7	1000312099	HCS 1/2-13 x 4 1/4"	4	
Z9	1000308448	5/16" X 1 1/2" BOLT	24	
Z10	1000310097	SCREW;HH;.250-20 x 2.00;ZN;	2	
Z11	1000309851	HCS 3/8-16 x 2 1/4" - ZINC	2	
Z12	1000311963	SCREW;HH;.375-16 x 1.25;ZN;	2	
Z13	1000310088	Washer, Curved, 1/2"	8	
Z14	1000312161	NUT;NLK;.500-13;ZN	4	
Z15	1000309854	1/4" NYLON JAM NUT	2	
Z16	1000308428	3/8" NUT	4	
Z17	1000308436	WASHER;FLT;USS;Φ0.344XΦ0.875X.063;ZN;	8	
Z18	1000308446	WASHER;FLT;USS;Φ0.281XΦ0.734X.063;ZN;	6	Only on FS version.
Z47	1000310219	SCREW;HH;.250-20 x 0.75;ZN;	6	Only on FS version.
Coupler Set	1000344108	900 Series Coupler Kit;Metal	2	
FS Side Set	1000329670	900 TOWER SERIES FREE STANDING SIDE SET	1	Only on FS version.
FS Side 1	1000394473	FS Arm Assy;Right;923-02;	1	Only on FS version.
FS Side 2	1000394458	FS Arm Assy;Left;923-02;	1	Only on FS version.

FS Side 3	1000310289	3" Connector Joint	1	Only on FS version.
FS Side 4	1000310273	4" FOOT (SHORT)	1	Only on FS version.
FS Side 5	1000310088	Washer, Curved, 1/2"	1	Only on FS version.
FS Side 6	1000310301	SCREW;HH;.500-13 x 4.50;ZN;	1	Only on FS version.
FS Side 7	1000315894	DECAL MATRIX 11X1 BLK	1	Only on FS version.
Weight Stack Set	1000421610	Weight Stack Assy;Stepped;#190;	1	
Weight Stack 1	1000310334	6000 TOP PLATE	1	
Weight Stack 2	1000310343	Orange SELECTOR PIN w/ 6 1/2" CORD	1	
Weight Stack 3	1000312817	5/16" SPLIT LOCK WASHER	2	
Weight Stack 4	1000312127	BHS 5/16" - 1"	2	
Weight Stack 6	1000359722	2" OD x .562 ID x .187 F/W Zinc	1	
Weight Stack 7	1000421611	Center Stick;12";CR3;	1	
Weight Stack 8	1000321944	WEIGHT PLATE 20# W_BUSHINGS 18.4 X 4.3X 1	6	
Weight Stack 9	1000312880	CAST IRON	5	

Matrix FS942 Tricep Pushdown

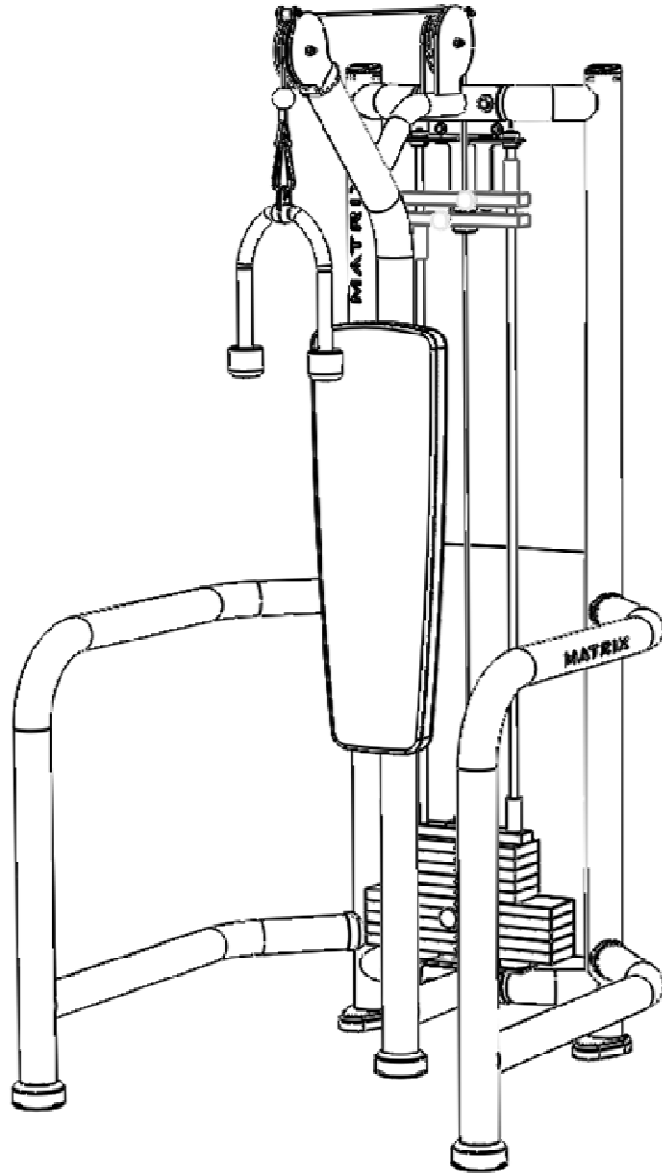

Quantity

1

862-040
Serial plate
Non - EN

MATRIX

Model: XXXXXXXXX Max User Weight: XXXX lbs
 S/N: XXXXXXXXXXXXXXXX Max Training Weight: XXXX lbs
 Mfg Date: XX-XX-XXXX EN587-1, EN587-2 Class S

UPC

Matrix Fitness
1600 Landmark Dr
Cottage Grove, WI 53027
(888) 695-4863

4

854 - 044
280 mm Matrix



1

WARNING

SEATBELT SECTIONS: NEVER CAM LOCK ON THIS EQUIPMENT. FOLLOW THESE PRECAUTIONS TO AVOID INJURY:

1. When camming under the seatbelt, always turn the strength training equipment. Seaters must be supervised at all times while using this equipment.
2. This equipment is not intended for use by persons with reduced physical, sensory or mental capabilities, a lack of experience and knowledge, or those who are unable to understand and follow instructions concerning use of the equipment. It is the user's responsibility to read the manual and to be properly instructed in its use.
3. Do not attempt use or exercise modification for use without the proper instruction and supervision of a qualified fitness professional.
4. Inspect the machine before use. DO NOT use the machine if you observe any damage or wear that may affect the safe use of the equipment.
5. Check to see that the weight stack is completely seated in the weight stack.
6. Do not use the machine if the weight stack is pinned in an abnormal position.
7. NEVER use dumbbells or other items to increase the weight of the weight stack.
8. NEVER use the machine if you observe any damage or wear that may affect the safe use of the equipment.
9. NEVER use the machine if you observe any damage or wear that may affect the safe use of the equipment.
10. Keep feet, clothing, hair, and fitness accessories away from the machine.
11. Adjustable bars, when pinning, must be used in all times.
12. When using any adjustable mechanism, keep the machine in a safe position.
13. Make sure the machine is in a safe position before use. Do not use the machine if you observe any damage or wear that may affect the safe use of the equipment.
14. Do not use the machine if you observe any damage or wear that may affect the safe use of the equipment.
15. DO NOT REMOVE THIS LABEL. REPLACE IF DAMAGED OR ILLEGIBLE.

General Instruction 000321 EN

2 each



854-985
Pinch hazard



1

862-360 Weight Stack



Front

862-360 Weight Stack

12 lb	5.4 kg
24 lb	10.9 kg
36 lb	16.3 kg
48 lb	21.8 kg
60 lb	27.2 kg
72 lb	32.7 kg
92 lb	41.7 kg
112 lb	50.8 kg
132 lb	59.9 kg
152 lb	68.9 kg
172 lb	78 kg
192 lb	87.1 kg
212 lb	96.2 kg
232 lb	105.2 kg
252 lb	114.3 kg
272 lb	123.4 kg
292 lb	132.4 kg
312 lb	141.5 kg
332 lb	150.6 kg
352 lb	159.7 kg
372 lb	168.7 kg
392 lb	177.8 kg

WARNING

DEATH OR SERIOUS INJURY CAN OCCUR ON THIS EQUIPMENT. FOLLOW THESE PRECAUTIONS TO AVOID INJURY.

1. Keep children under the age of 14 away from this strength training equipment. Teenagers must be supervised at all times while using this equipment.
2. This equipment is not intended for use by persons with reduced physical, sensory or mental capabilities, or lack of experience and knowledge, unless they have been given supervision or instruction concerning use of the equipment by a person responsible for their safety.
3. All warnings and instructions should be read and proper instruction obtained prior to use. Use this equipment for its intended purpose ONLY.
4. Inspect the machine before use. DO NOT use machine if it appears damaged or inoperable.
5. Do not exceed weight capacity of this equipment.
6. Check to see that the selector pin is completely inserted into the weight stack.
7. NEVER use the machine with the weight stack pinned in an elevated position.
8. NEVER use dumbbells or other means to incrementally increase the weight resistance. Only use the means provided directly from the manufacturer.
9. Injuries to health may result from incorrect or excessive training. Cease exercise if you feel faint or dizzy. Obtain a medical exam before beginning an exercise program.
10. Keep body, clothing, hair, and fitness accessories free and clear of all moving parts.
11. Adjustable straps, where provided, must be used at all times.
12. When adjusting any adjustable mechanism (top position, seat position, pad location, range of motion limiter, pulley carriage, or any other type), make certain that the adjustable mechanism is fully engaged prior to use to prevent unintended motion.
13. Manufacturer recommends that this equipment be secured to the floor to stabilize and eliminate rocking or tipping over. Use a licensed contractor.
14. If equipment is NOT secured to floor, NEVER allow resistance straps, ropes or other means to be attached to this equipment, as this may result in serious injury. NEVER use this equipment for support during stretching, as this may result in serious injury.
15. DO NOT REMOVE THIS LABEL. REPLACE IF DAMAGED OR ILLICIBLE.

General Selectorized 1000363780

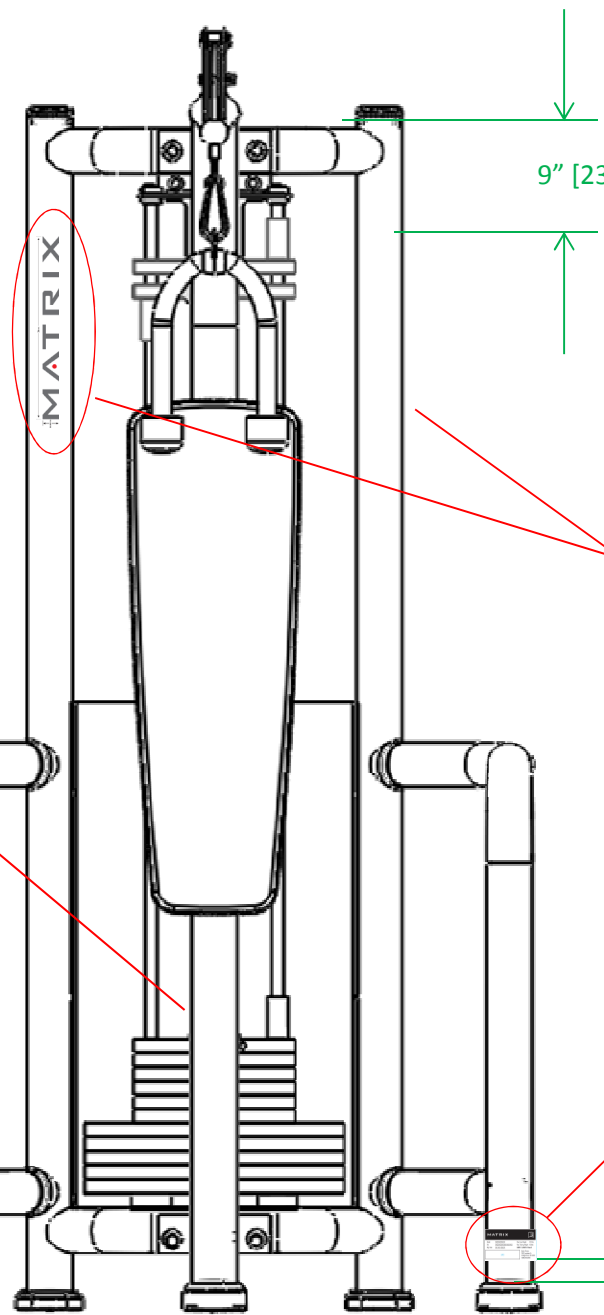

9" [230mm]

MATRIX

854 - 044
280 mm Matrix

862-040
Serial plate
Non - EN

MATRIX

Model: XXXXXXXXX Max User Weight: XXX lbs
 SN: XXXXXXXXXXXXXXXX Max Training Weight: XXX lbs
 Mfg Date: XX-XX-XXXX EN957-1, EN957-2 Class B

Matrix Fitness
1600 Landmark Dr
Cottage Grove, WI 53027
(888) 695-4863

UPC

1" [25mm]

1" [25mm]

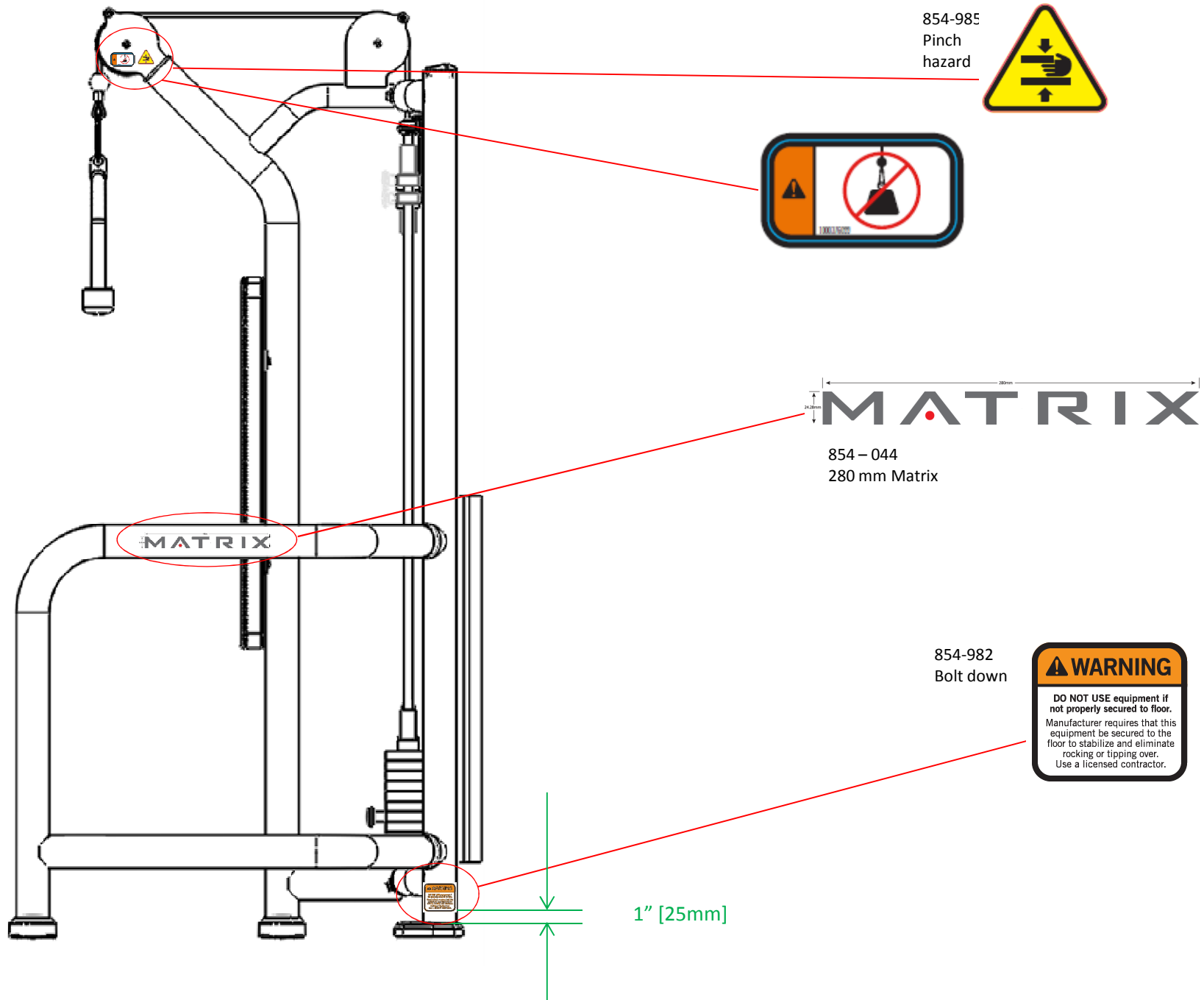

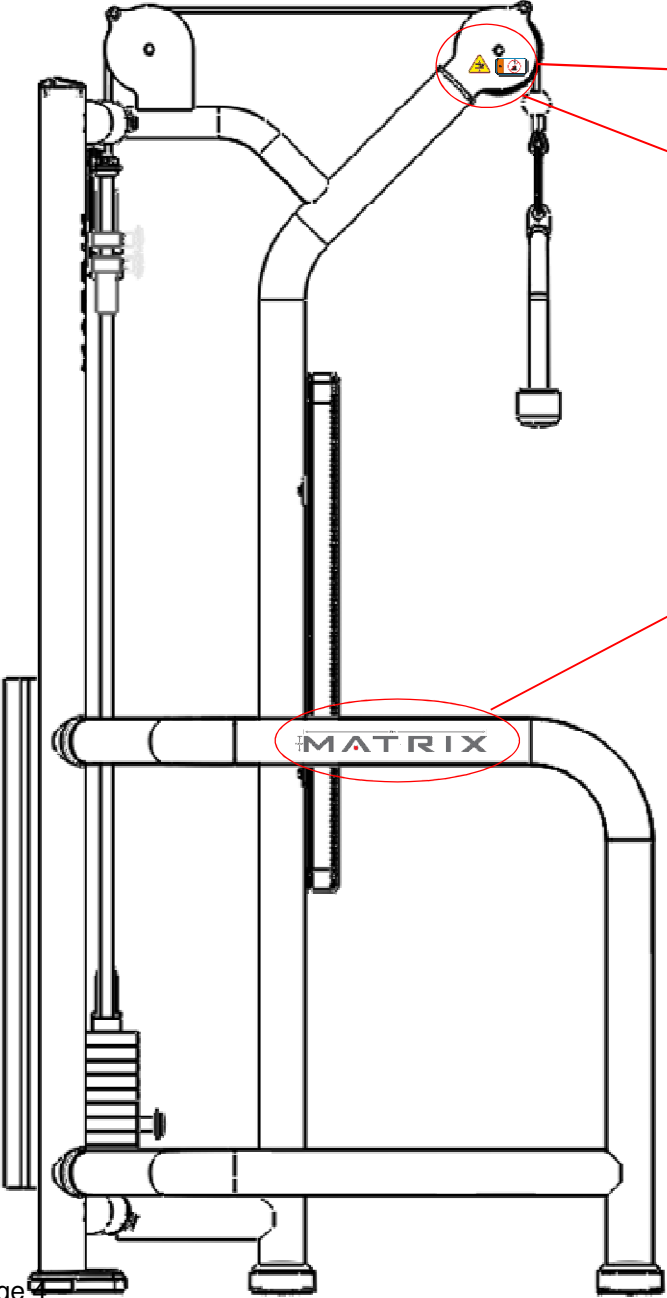

854-985
Pinch
hazard



280mm
24mm
MATRIX

854 - 044
280 mm Matrix

Matrix QC template

854-043
166mm Matrix

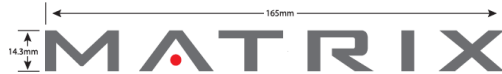

854-044
280mm Matrix



854-857
Serial plate

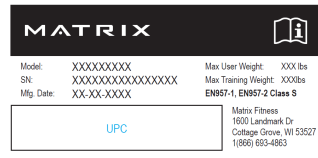

862-040
Serial plate
Non - EN

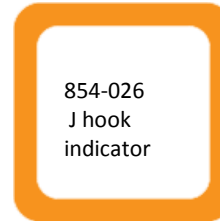
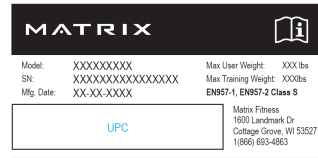

854-026
J hook
indicator

854-985
Pinch
hazard



854-986
Moving
hazard



Weight horn caps

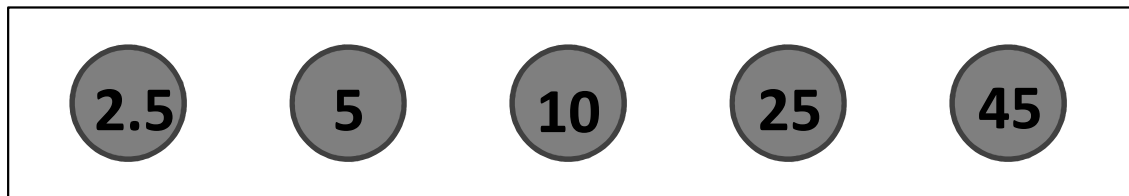

854-982
Bolt down

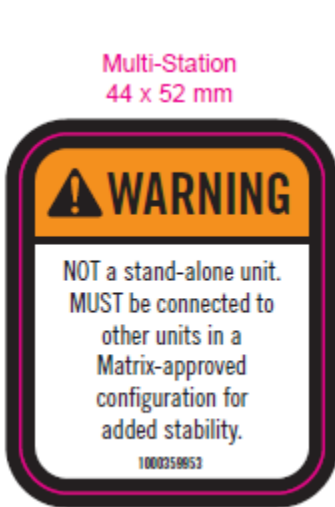

Multi-Station
44 x 52 mm

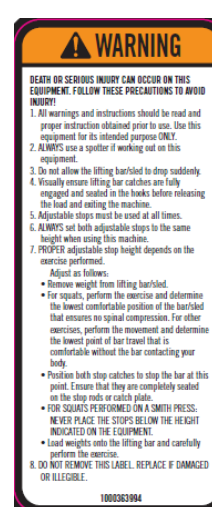
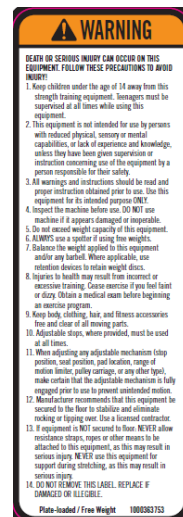

854-979
ADJ stop 1



854-980
ADJ stop 2

