

FS946-06
(SHOWN IN EXPLODED VIEW SHEET 1)

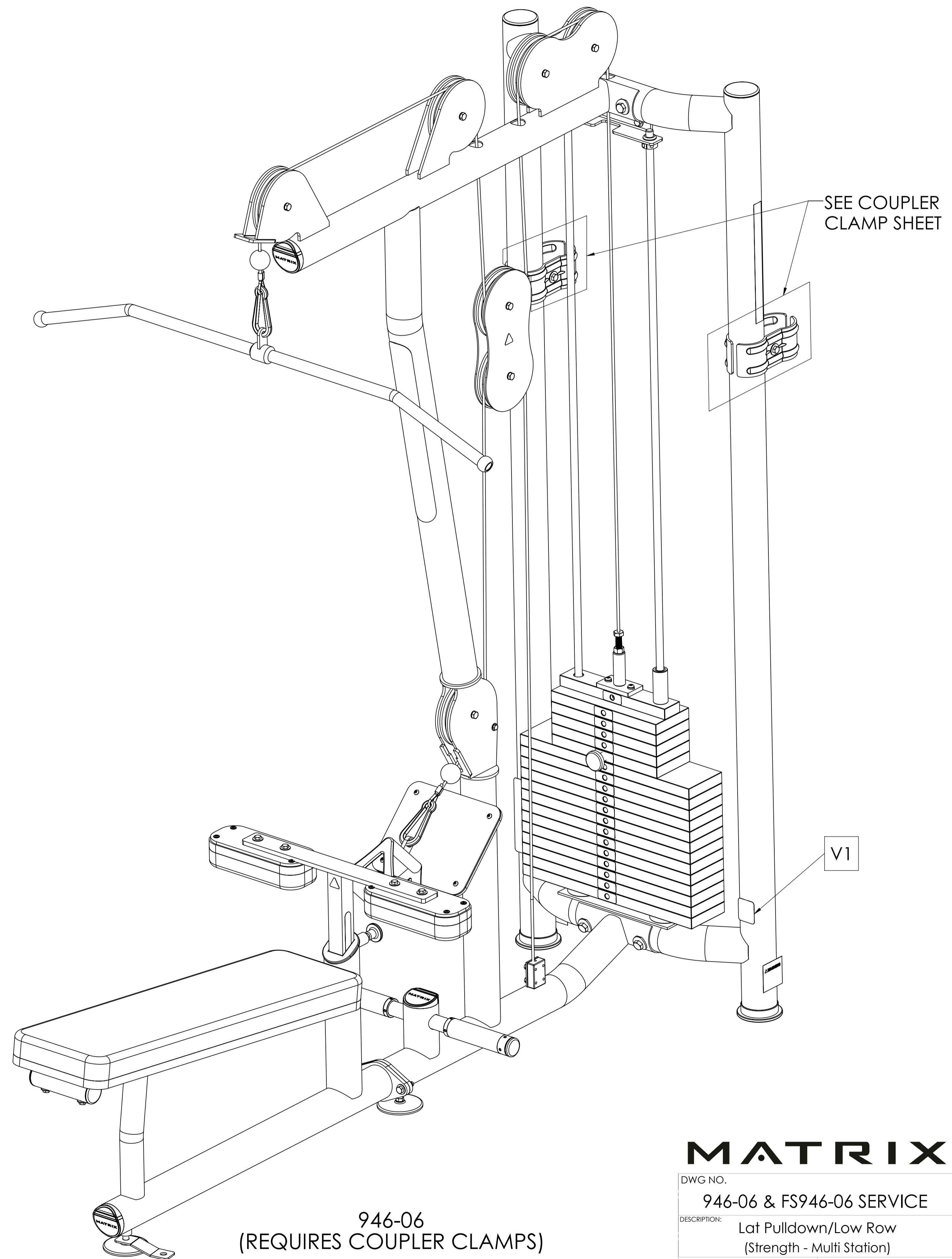

946-06
(REQUIRES COUPLER CLAMPS)

MATRIX

DWG NO. 946-06 & FS946-06 SERVICE

DESCRIPTION: Lat Pulldown/Low Row
(Strength - Multi Station)

DRAWN BY: LMB DATE: 2018.JAN.08

UPDATED BY: DATE:

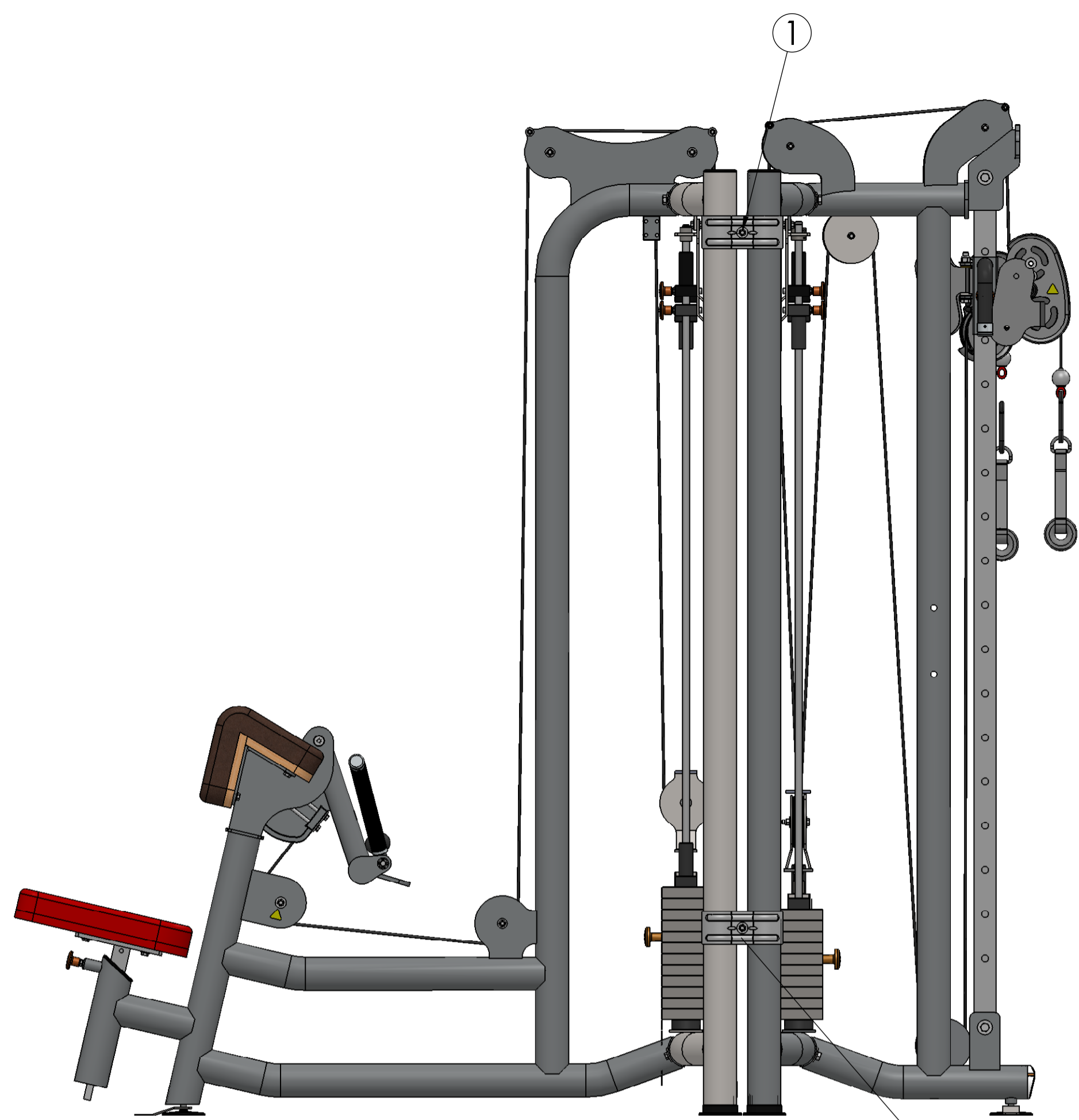

TWO STACK

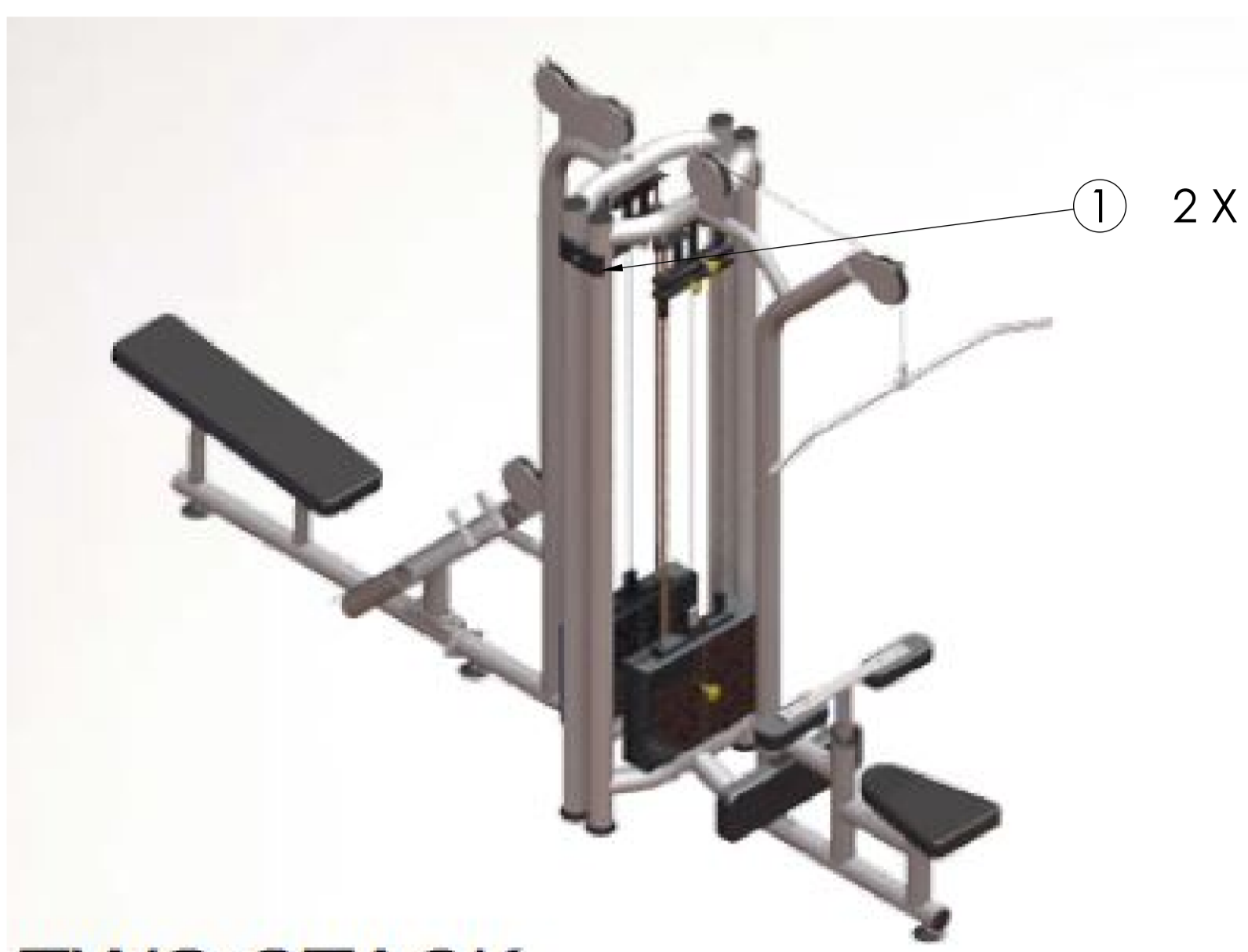

TWO STACK

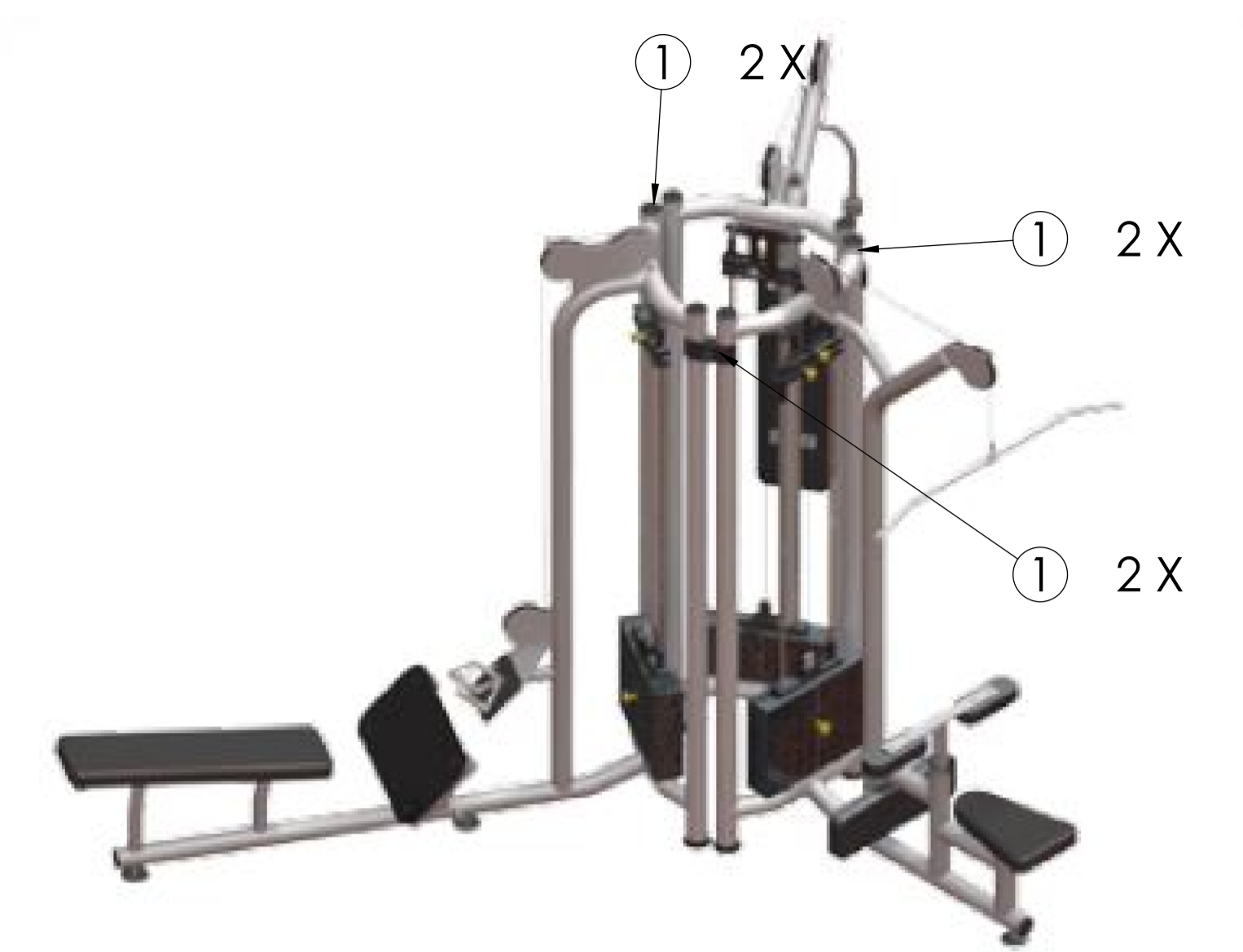

THREE STACK

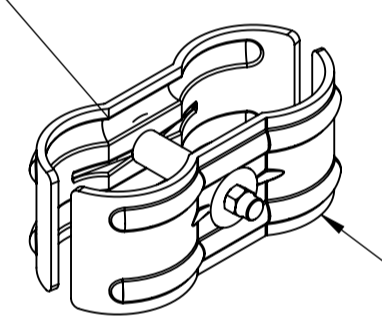

EXPLODED VIEW SHOWN ON SHEET 1
 NOTE: QUANTITY REQUIRED FOR EACH CONFIGURATION WILL VARY
 (CONFIGURATIONS SHOWN ARE FOR REFERENCE ONLY)

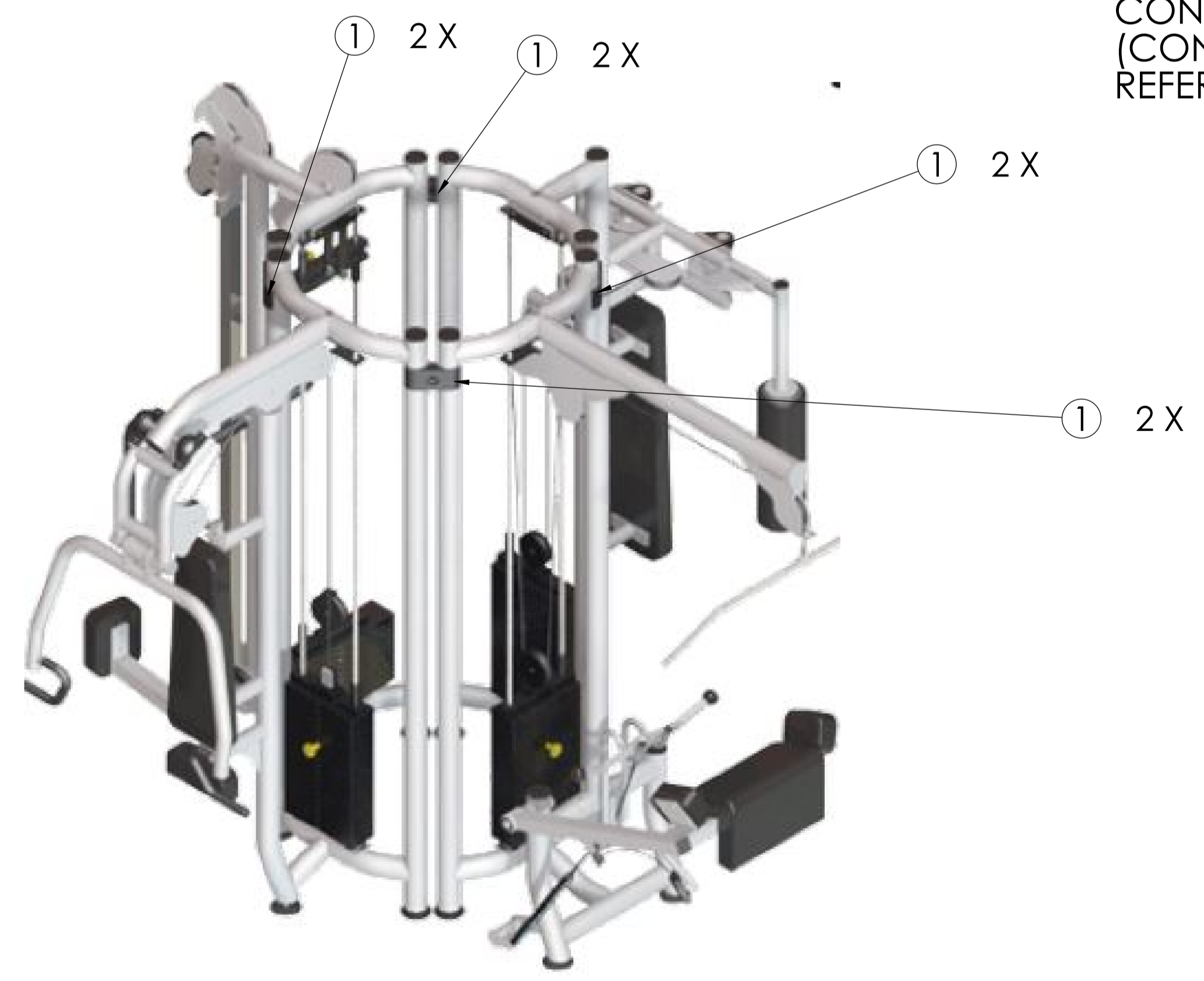

FOUR STACK

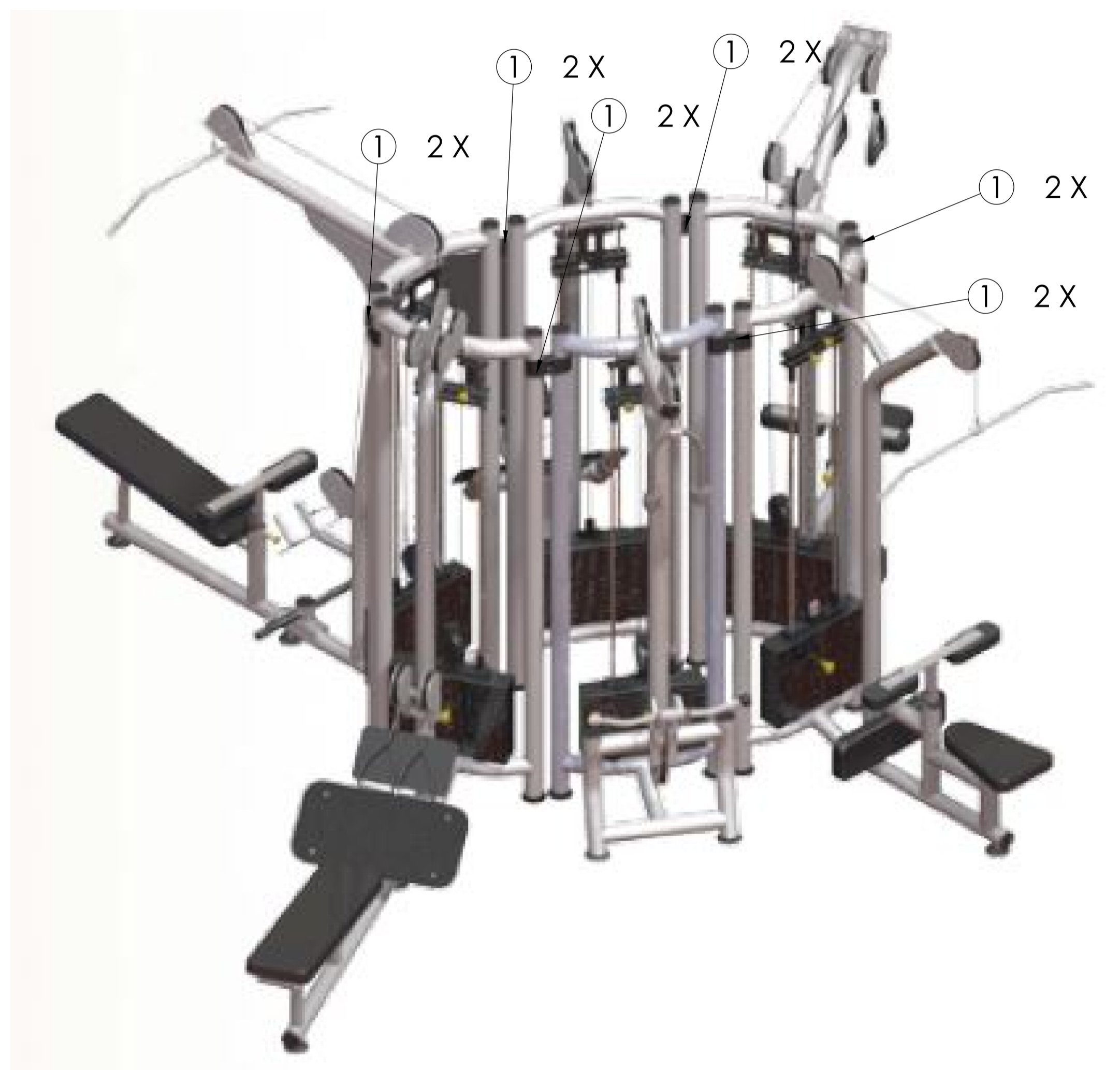

SIX STACK

MATRIX

DWG NO.	160-257 SERVICE	
DESCRIPTION:	COUPLER(CONFIGURATIONS) (Strength - Multi Station)	
DRAWN BY:	LMB	DATE: 2016.JAN.14
UPDATED BY:		DATE:

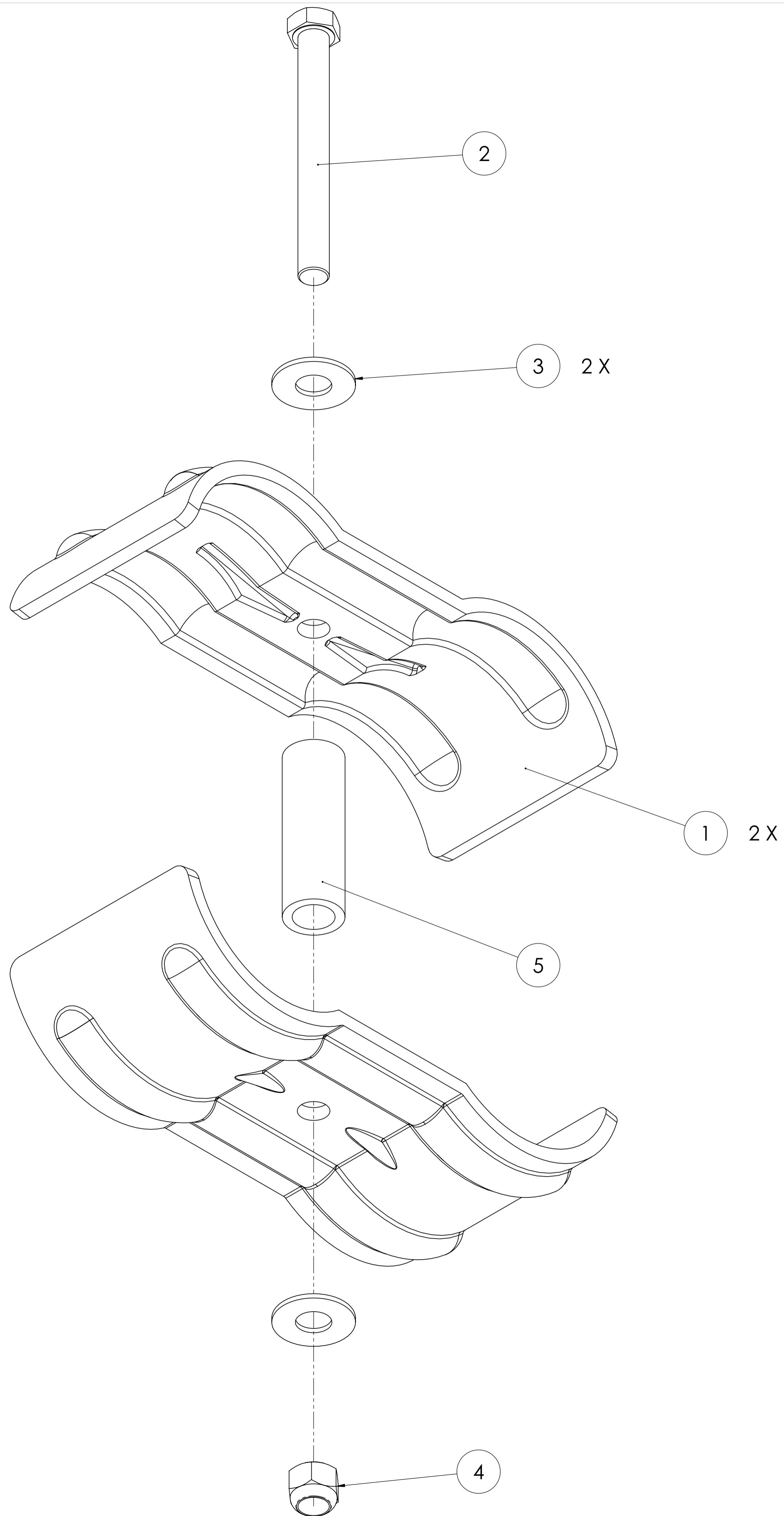

MATRIX

DWG NO.

160-257 SERVICE

DESCRIPTION:

900 SERIES TOWER CLAMP (SINGLE)
(Strength - Multi Station)

DRAWN BY: LMB

DATE: 2016.JAN.14

UPDATED BY:

DATE:

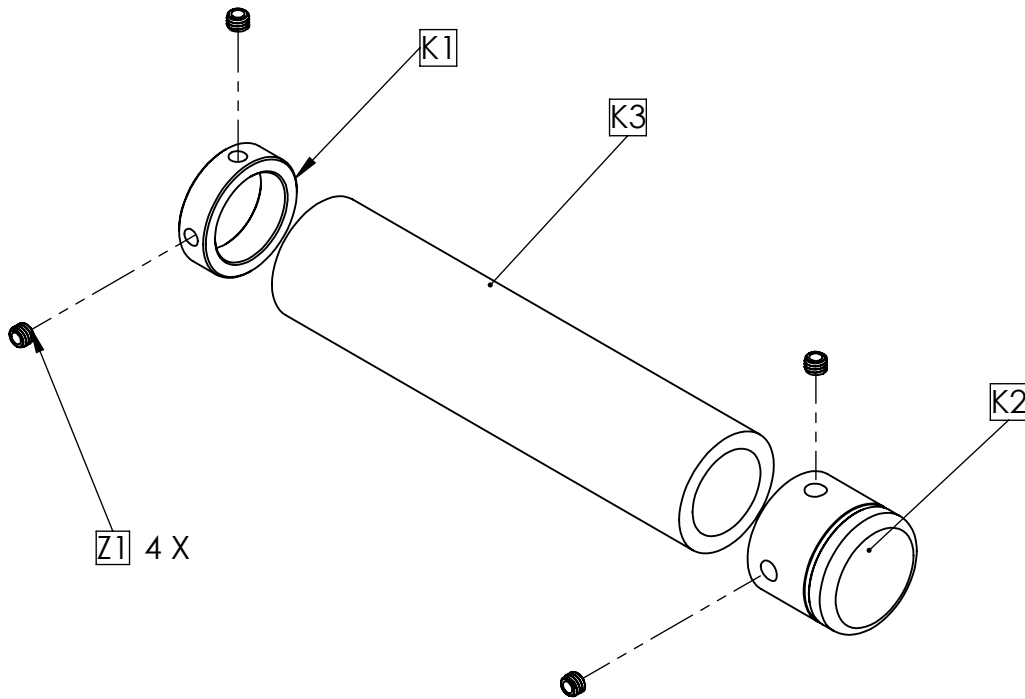

MATRIX

DWG. NO.	KIT1 HAND GRIP	
DESCRIPTION:	HAND GRIP	
DRAWN:	LMB	DATE 13.03.26
UPDATED:	--	DATE --

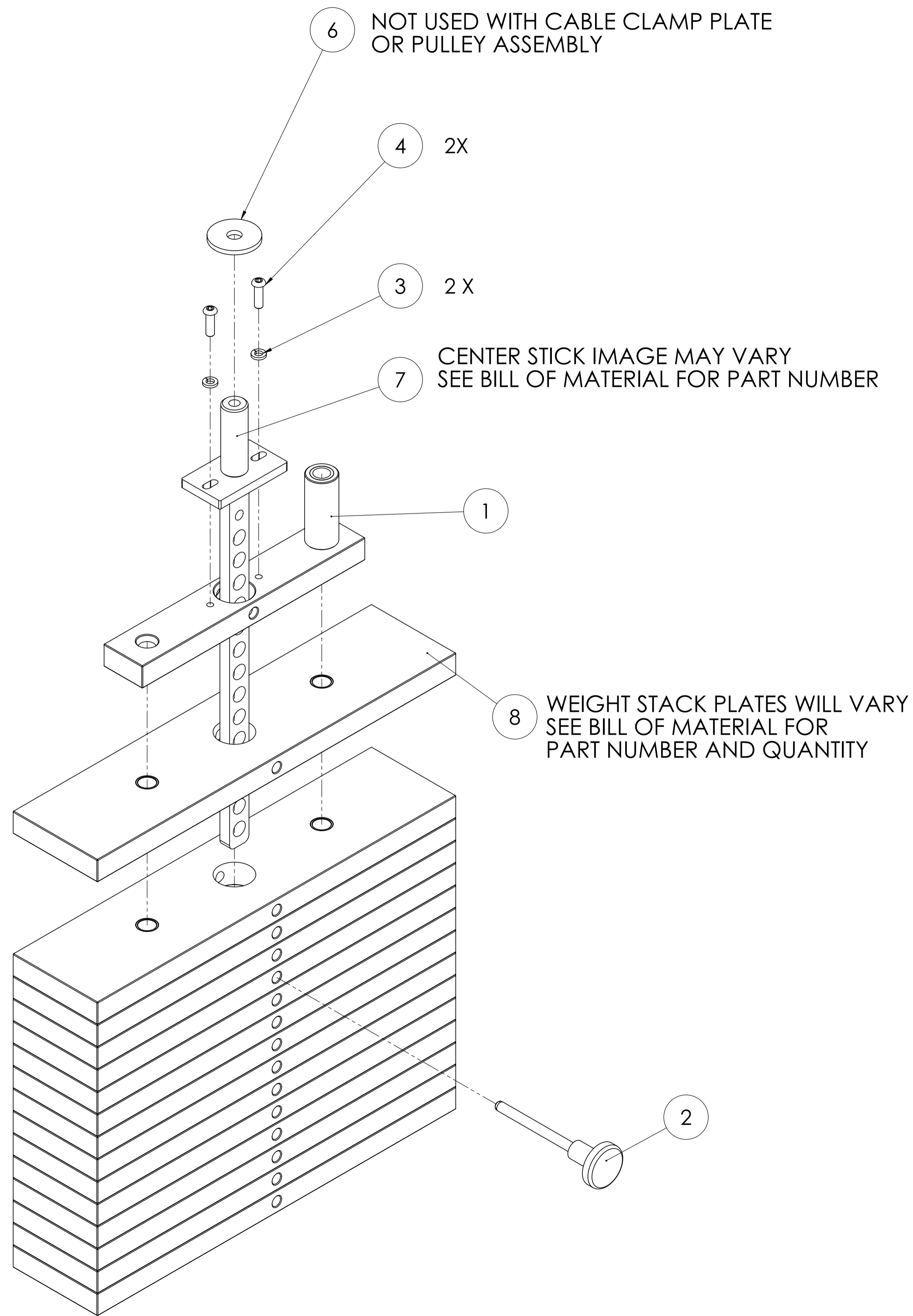

**CENTER STICK WITH MOUNTING POST
CABLE MOUNTED WITH TAKE UP BOLT OR PULLEY
(SHOWN EXPLODED)
SEE NOTES AND BOM FOR PART NUMBERS**

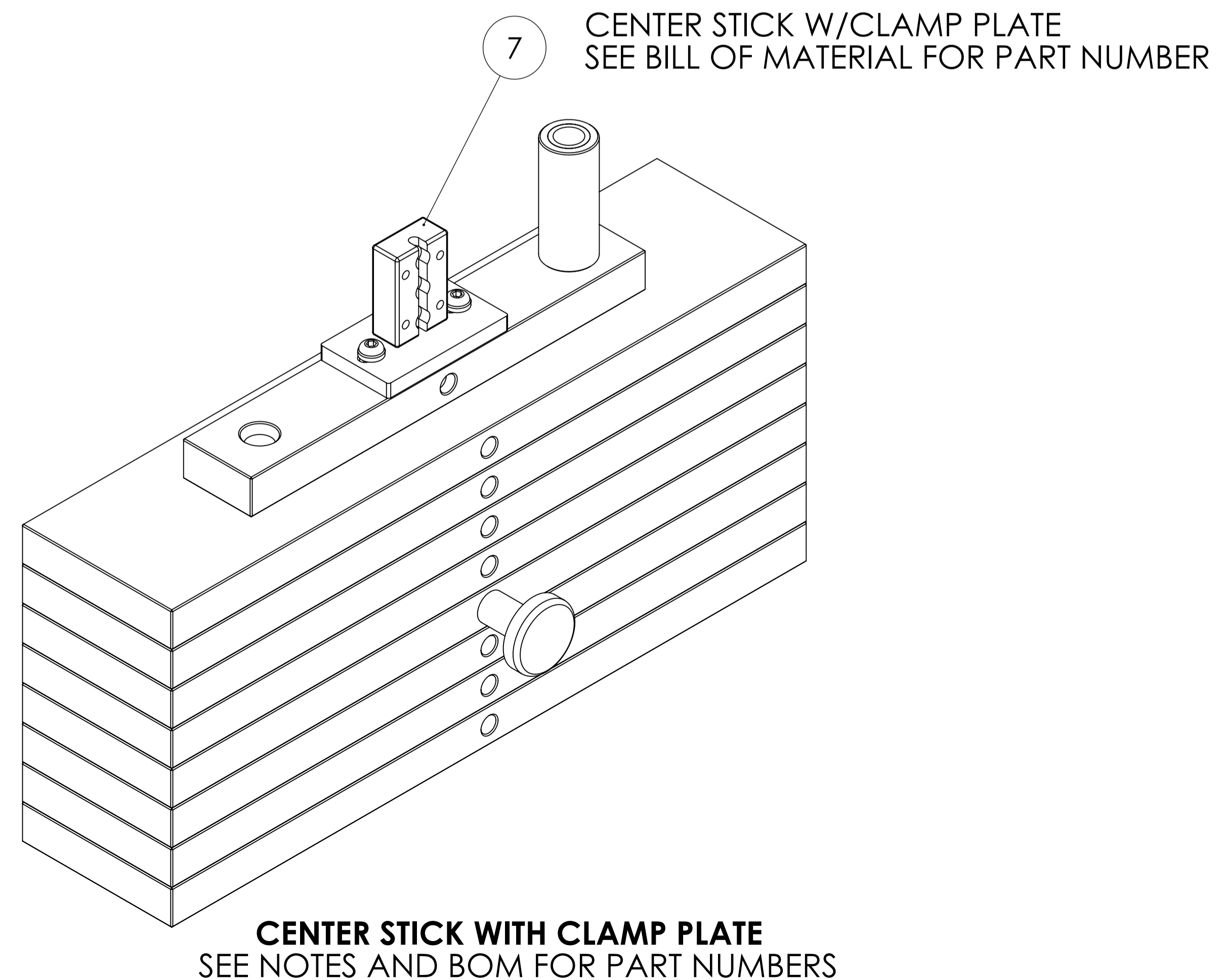
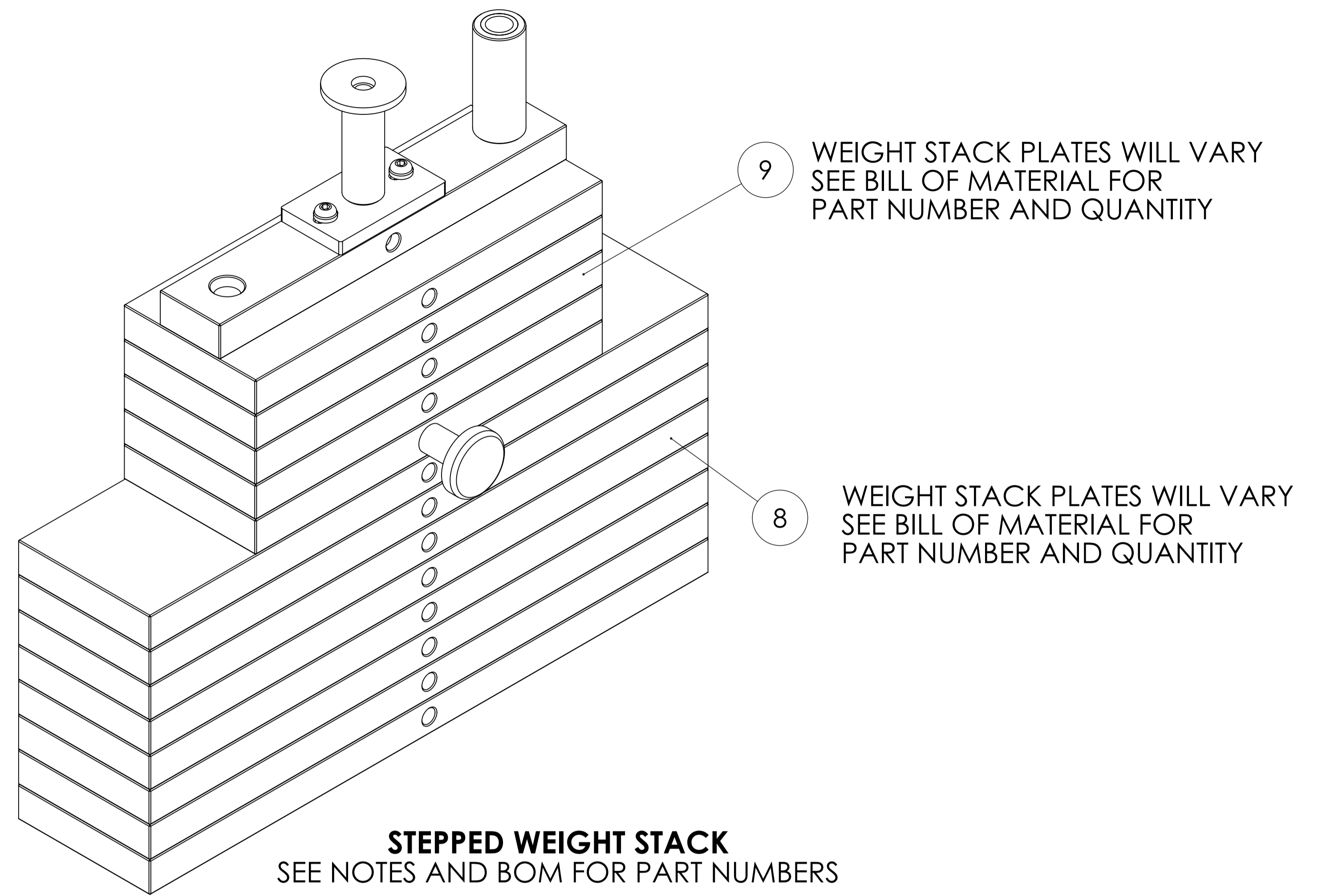

MATRIX

DWG NO.		_WEIGHT STACK SERVICE	
DESCRIPTION: WEIGHT STACK/CENTERSTICK ASSY (Take Up Bolt, Pulley & Clamp Style)			
DRAWN BY:	LMB	DATE:	2013.OCT.10
UPDATED BY:	LMB	DATE:	2017.DEC.29

Reference #	SAP Part #	Description	Qty	Notes
MG-946-06				
AB1	1000334550	WELDMENT MAIN FRAME CENTER;Iced Silver	1	
AB1	1000334551	WELDMENT MAIN FRAME CENTER;Black Glossy	1	
AB1	1000334552	WELDMENT MAIN FRAME CENTER;Lace White	1	
AB2	1000412059	Seat Frame Assy;946;Iced Silver	1	
AB2	1000412060	Seat Frame Assy;946;Black Glossy	1	
AB2	1000412061	Seat Frame Assy;946;Lace White	1	
AB3	1000393455	Knee Hold Down Chrome w/ Decals;921;	1	
AB4	1000353447	Frame Set;900 Series;Iced Silver	1	
AB4	1000353448	Frame Set;900 Series;Black Glossy	1	
AB4	1000353449	Frame Set;900 Series;Lace White	1	
AB5	1000328373	WELDMENT TIP OVER FOOT;Iced Silver	1	Only on FS version.
AB5	1000328374	WELDMENT TIP OVER FOOT;Black Glossy	1	Only on FS version.
AB5	1000328375	WELDMENT TIP OVER FOOT;Lace White	1	Only on FS version.
B5	1000421272	Weight Stack Bracket;900 SRS;	1	
B7	1000379407	Spring Pin Assy;1.313 Body;	1	
B11	1000321910	5/8" GUIDE ROD - 76"	2	
B12	1000335318	1/4" x 1 1/2" F.S. - 2 1/4"	1	
B13	1000324103	10ga PLASMA	2	
B14	1000310331	10ga PLASMA - 1 1/2" x 5 1/4"	1	
B15	1000324104	PLATE ABS FOOT PLATE	1	
B18	1000345600	5/8" Single Split Collar	2	
B19	1000312893	3/8" SAFETY CLIP	2	
B20	1000310014	End Cap	3	
B21	1000310339	ROUND WEIGHT STACK BUMPER	2	
B22	1000310083	2" ROUND END CAP	2	
B23	1000310095	1/2" OD x 1/4" ID Plastic Spacer - 1"	1	
B24	1000310302	6" CABLE PULLEY w/ NARROW BUSHING	7	
B26	1000338388	Plug;Seat Post;	1	
B27	1000313851	HANDLE DOUBLE TRIANGLE ROW	1	
B28	1000313766	HARD CHROME 48" LAT BAR	1	
B30	1000310273	4" FOOT (SHORT)	2	
B31	1000312237	3" FOOT	2	
B50	1000312233	3" ROUND END CAP	2	
B56	1000421279	Cable Assy;946;	1	
B57	1000334577	Cable#2 946	1	
B58	1000350082	SAFETY TAPE 18"X 4" LAT BAR	1	
B59	1000342962	Stack Guard;Grey;	1	Only on FS version.
B64	1000317727	5/8" RUBBER GROMMET	2	
B66	1000393238	TAPE;Double faced 2" x 8.5"	2	
J16	See Pad Matrix	UPHOLSTERY	2	
J17	See Pad Matrix	Bottom Pad	1	
V1	1000359953	Decal;Warning;Single Station;English	1	Non FS version only.
V1	1000364025	Decal;Warning;Single Station;French	1	Non FS version only.
V32	1000312342	BOLT DOWN WARNING	1	
V33	1000308473	Decal, warning Hand Pinch	3	
V34	1000313470	Decal, ROM	1	
V35	1000315894	DECAL MATRIX 11X1 BLK	2	
V36	1000384006	Serial Number Label;4" x 1.5";3M;	1	
V37	1000363760	Decal;Warning;Multi Station;English	1	
V37	1000363766	Decal;Warning;Multi Station;French	1	
V57	1000421523	900 Step Stack Decal	1	
Z38	1000309871	3/8-16 x 2" BOLT	2	
Z39	1000310096	1/4" SPLIT LOCK WASHER	4	

Z40	1000310219	SCREW;HH;.250-20 x 0.75;ZN;	4	
Z41	1000309858	Machine Bushing 3/8 ID x 5/8OD 18ga Zinc	16	
Z42	1000310088	Washer, Curved, 1/2"	8	
Z43	1000309851	HCS 3/8-16 x 2 1/4" - ZINC	5	
Z44	1000310097	SCREW;HH;.250-20 x 2.00;ZN;	1	
Z45	1000308437	SCREW;HH;.375-16 x 1.50;ZN;	2	
Z46	1000308445	5/16" - 3" BOLT	3	
Z47	1000308448	5/16" X 1 1/2" BOLT	4	
Z48	1000311963	SCREW;HH;.375-16 x 1.25;ZN;	2	
Z49	1000312099	HCS 1/2-13 x 4 1/4"	4	
Z50	1000309854	1/4" NYLON JAM NUT	1	
Z51	1000308428	3/8" NUT	11	
Z52	1000308446	WASHER;FLT;USS;Φ0.281XΦ0.734X.063;ZN;	6	Only on FS version.
Z53	1000308436	WASHER;FLT;USS;Φ0.344XΦ0.875X.063;ZN;	15	
Z56	1000312161	NUT;NLK;.500-13;ZN	4	
Z59	1000312711	1/4" x 1/2" BUTTON HEAD	4	
Weight Stack Set	1000421546	Weight Stack Assy;Stepped;#390;	1	
Weight Stack 1	1000310334	6000 TOP PLATE	1	
Weight Stack 2	1000310343	Orange SELECTOR PIN w/ 6 1/2" CORD	1	
Weight Stack 3	1000312817	5/16" SPLIT LOCK WASHER	2	
Weight Stack 4	1000312127	BHS 5/16" - 1"	2	
Weight Stack 6	1000359722	2" OD x .562 ID x .187 F/W Zinc	1	
Weight Stack 7	1000421547	Center Stick;19";CR3	1	
Weight Stack 8	1000321944	WEIGHT PLATE 20# W_BUSHINGS 18.4 X 4.3X 1	13	
Weight Stack 9	1000312880	CAST IRON	5	
Coupler Set	1000344108	900 Series Coupler Kit;Metal	2	Non FS version only.
Coupler 1	1000337789	連接片;;;SPHC;186x76.2x23.4x4.76T;;	2	Non FS version only.
Coupler 2	1000314246	SCREW;HH;.375-16 x 3.50;ZN;	1	Non FS version only.
Coupler 3	1000308444	WASHER;FLT;USS;Φ0.406XΦ1.000X.063;ZN;	2	Non FS version only.
Coupler 4	1000308428	3/8" NUT	1	Non FS version only.
Coupler 5	1000342964	Pipe;3/4" OD x 1/2" ID;w/ Zinc Coating;	1	Non FS version only.
Kit 1	1000318109	HAND GRIP 1.25 DIA 0-12"LONG	2	
Kit 1 K1	1000369933	Tube Collar;25.4MM;	1	
Kit 1 K2	1000308469	Cap;End Tube;25.4MM ID;	2	
Kit 1 K3	1000316932	泡棉;把手;;;Φ24x5tx1524L;JHTNA-M;	1	
Kit 1 Z1	1000309773	Screw;Set;M6 x 1.0P x 5L;BP;POT;	8	

MG-FS946-06				
Reference #	SAP Part #	Description	Qty	Notes
AB1	1000334550	WELDMENT MAIN FRAME CENTER;Iced Silver	1	
AB1	1000334551	WELDMENT MAIN FRAME CENTER;Black Glossy	1	
AB1	1000334552	WELDMENT MAIN FRAME CENTER;Lace White	1	
AB2	1000412059	Seat Frame Assy;946;Iced Silver	1	
AB2	1000412060	Seat Frame Assy;946;Black Glossy	1	
AB2	1000412061	Seat Frame Assy;946;Lace White	1	
AB3	1000393455	Knee Hold Down Chrome w/ Decals;921;	1	
AB4	1000353447	Frame Set;900 Series;Iced Silver	1	
AB4	1000353448	Frame Set;900 Series;Black Glossy	1	
AB4	1000353449	Frame Set;900 Series;Lace White	1	
AB5	1000328373	WELDMENT TIP OVER FOOT;Iced Silver	1	Only on FS version.
AB5	1000328374	WELDMENT TIP OVER FOOT;Black Glossy	1	Only on FS version.
AB5	1000328375	WELDMENT TIP OVER FOOT;Lace White	1	Only on FS version.
B5	1000421272	Weight Stack Bracket;900 SRS;	1	
B7	1000379407	Spring Pin Assy;1.313 Body;	1	
B11	1000321910	5/8" GUIDE ROD - 76"	2	
B12	1000335318	1/4" x 1 1/2" F.S. - 2 1/4"	1	
B13	1000324103	10ga PLASMA	2	
B14	1000310331	10ga PLASMA - 1 1/2" x 5 1/4"	1	
B15	1000324104	PLATE ABS FOOT PLATE	1	
B18	1000345600	5/8" Single Split Collar	2	
B19	1000312893	3/8" SAFETY CLIP	2	
B20	1000310014	End Cap	3	
B21	1000310339	ROUND WEIGHT STACK BUMPER	2	
B22	1000310083	2" ROUND END CAP	2	
B23	1000310095	1/2" OD x 1/4" ID Plastic Spacer - 1"	1	
B24	1000310302	6" CABLE PULLEY w/ NARROW BUSHING	7	
B26	1000338388	Plug;Seat Post;	1	
B27	1000313851	HANDLE DOUBLE TRIANGLE ROW	1	
B28	1000313766	HARD CHROME 48" LAT BAR	1	
B30	1000310273	4" FOOT (SHORT)	3	
B31	1000312237	3" FOOT	2	
B50	1000312233	3" ROUND END CAP	2	
B56	1000421279	Cable Assy;946;	1	
B57	1000334577	Cable#2 946	1	
B58	1000350082	SAFETY TAPE 18"X 4" LAT BAR	1	
B59	1000342962	Stack Guard;Grey;	1	Only on FS version.
B64	1000317727	5/8" RUBBER GROMMET	2	
B66	1000393238	TAPE;Double faced 2" x 8.5"	2	
J16	See Pad Matrix	UPHOLSTERY	2	
J17	See Pad Matrix	Bottom Pad	1	
V1	1000359953	Decal;Warning;Single Station;English	1	Non FS version only.
V1	1000364025	Decal;Warning;Single Station;French	1	Non FS version only.
V32	1000312342	BOLT DOWN WARNING	1	
V33	1000308473	Decal, warning Hand Pinch	3	
V34	1000313470	Decal, ROM	1	
V35	1000315894	DECAL MATRIX 11X1 BLK	2	
V36	1000384006	Serial Number Label;4" x 1.5";3M;	1	
V37	1000363760	Decal;Warning;Multi Station;English	1	
V37	1000363766	Decal;Warning;Multi Station;French	1	
V57	1000421523	900 Step Stack Decal	1	
Z38	1000309871	3/8-16 x 2" BOLT	2	
Z39	1000310096	1/4" SPLIT LOCK WASHER	4	

Z40	1000310219	SCREW;HH;.250-20 x 0.75;ZN;	10	
Z41	1000309858	Machine Bushing 3/8 ID x 5/8OD 18ga Zinc	16	
Z42	1000310088	Washer, Curved, 1/2"	8	
Z43	1000309851	HCS 3/8-16 x 2 1/4" - ZINC	5	
Z44	1000310097	SCREW;HH;.250-20 x 2.00;ZN;	1	
Z45	1000308437	SCREW;HH;.375-16 x 1.50;ZN;	2	
Z46	1000308445	5/16" - 3" BOLT	3	
Z47	1000308448	5/16" X 1 1/2" BOLT	4	
Z48	1000311963	SCREW;HH;.375-16 x 1.25;ZN;	2	
Z49	1000312099	HCS 1/2-13 x 4 1/4"	4	
Z50	1000309854	1/4" NYLON JAM NUT	1	
Z51	1000308428	3/8" NUT	11	
Z52	1000308446	WASHER;FLT;USS;Φ0.281XΦ0.734X.063;ZN;	6	Only on FS version.
Z53	1000308436	WASHER;FLT;USS;Φ0.344XΦ0.875X.063;ZN;	15	
Z56	1000312161	NUT;NLK;.500-13;ZN	4	
Z59	1000312711	1/4" x 1/2" BUTTON HEAD	4	
Weight Stack Set	1000421546	Weight Stack Assy;Stepped;#390;	1	
Weight Stack 1	1000310334	6000 TOP PLATE	1	
Weight Stack 2	1000310343	Orange SELECTOR PIN w/ 6 1/2" CORD	1	
Weight Stack 3	1000312817	5/16" SPLIT LOCK WASHER	2	
Weight Stack 4	1000312127	BHS 5/16" - 1"	2	
Weight Stack 6	1000359722	2" OD x .562 ID x .187 F/W Zinc	1	
Weight Stack 7	1000421547	Center Stick;19";CR3	1	
Weight Stack 8	1000321944	WEIGHT PLATE 20# W_BUSHINGS 18.4 X 4.3X 1	13	
Weight Stack 9	1000312880	CAST IRON	5	
Coupler Set	1000344108	900 Series Coupler Kit;Metal	2	Non FS version only.
Kit 1	1000318109	HAND GRIP 1.25 DIA 0-12"LONG	2	
Kit 1 K1	1000369933	Tube Collar;25.4MM;	1	
Kit 1 K2	1000308469	Cap;End Tube;25.4MM ID;	2	
Kit 1 K3	1000316932	泡棉;把手;;;Φ24x5tx1524L;JHTNA-M;	1	
Kit 1 Z1	1000309773	Screw;Set;M6 x 1.0P x 5L;BP;POT;	8	

Matrix FS946 Lat Pulldown Low Row

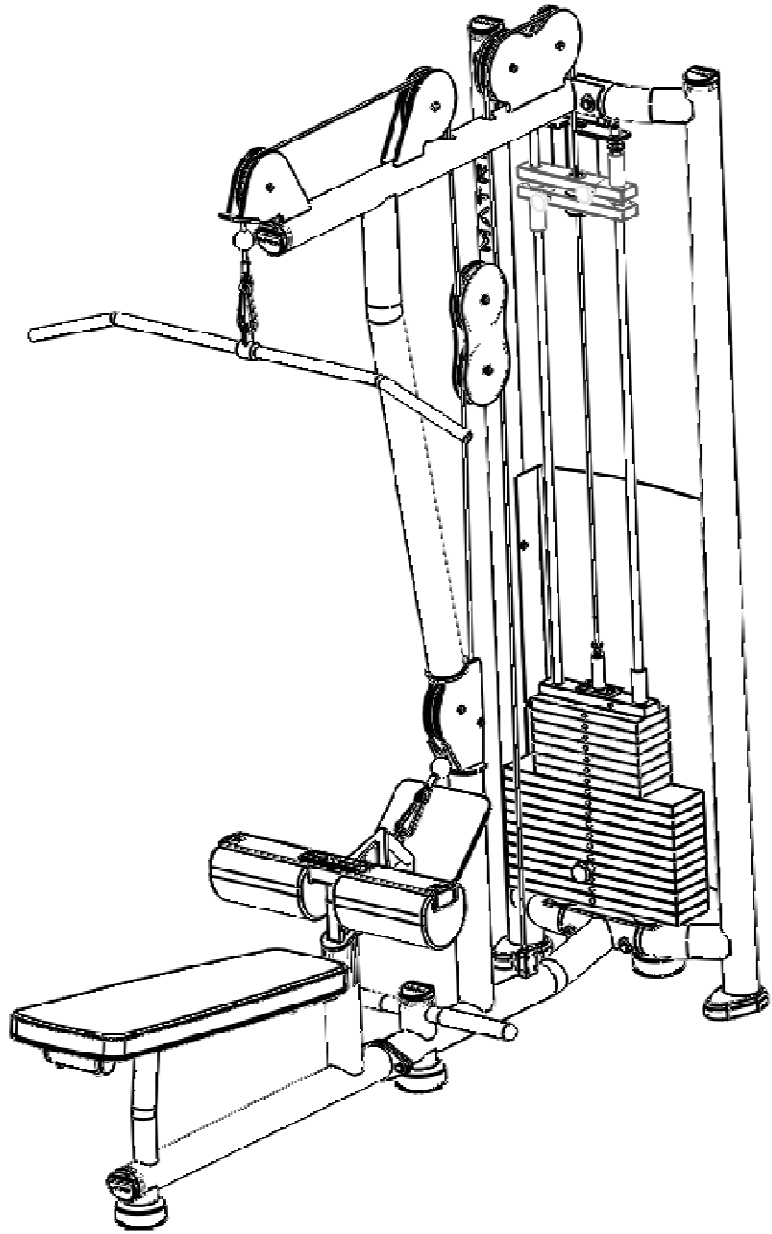

Quantity

1

862-040
Serial plate
Non - EN

2

854-044
280 mm Matrix



1

854-987
Single
Station

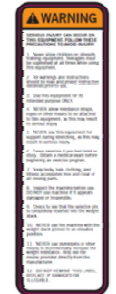

1

854-982
Bolt down



3

854-985
Pinch
hazard



1

862-360 Weight Stack



862-360 Weight Stack

12 lb	5.4 kg
24 lb	10.9 kg
36 lb	16.3 kg
48 lb	21.8 kg
60 lb	27.2 kg
72 lb	32.7 kg
92 lb	41.7 kg
112 lb	50.8 kg
132 lb	59.9 kg
152 lb	68.9 kg
172 lb	78 kg
192 lb	87.1 kg
212 lb	96.2 kg
232 lb	105.2 kg
252 lb	114.3 kg
272 lb	123.4 kg
292 lb	132.4 kg
312 lb	141.5 kg
332 lb	150.6 kg
352 lb	159.7 kg
372 lb	168.7 kg
392 lb	177.8 kg

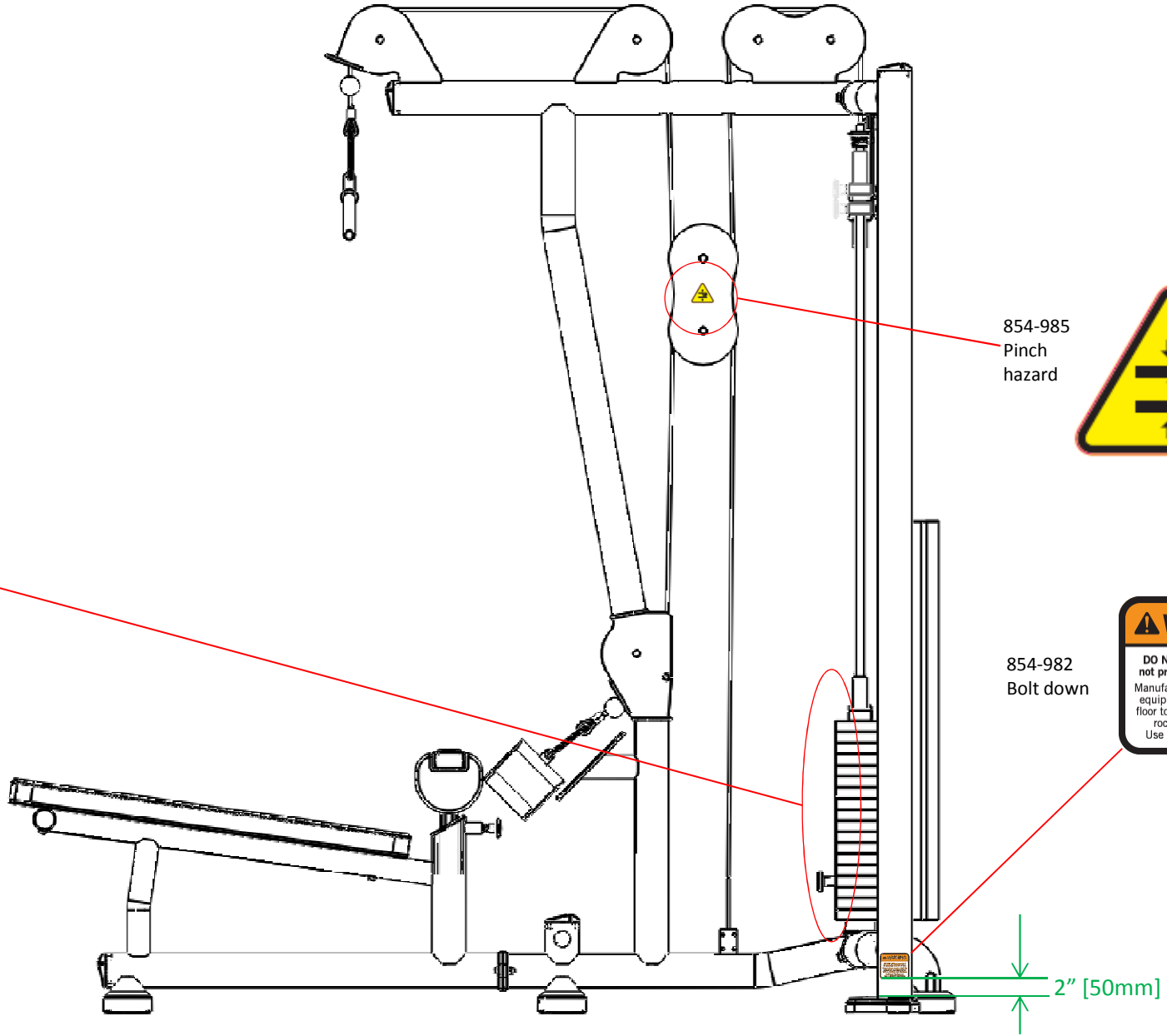

854-985
Pinch
hazard



WARNING
DO NOT USE equipment if not properly secured to floor. Manufacturer requires that this equipment be secured to the floor to stabilize and eliminate rocking or tipping over. Use a licensed contractor.

854-982
Bolt down

2" [50mm]

Side

854-985
Pinch
hazard

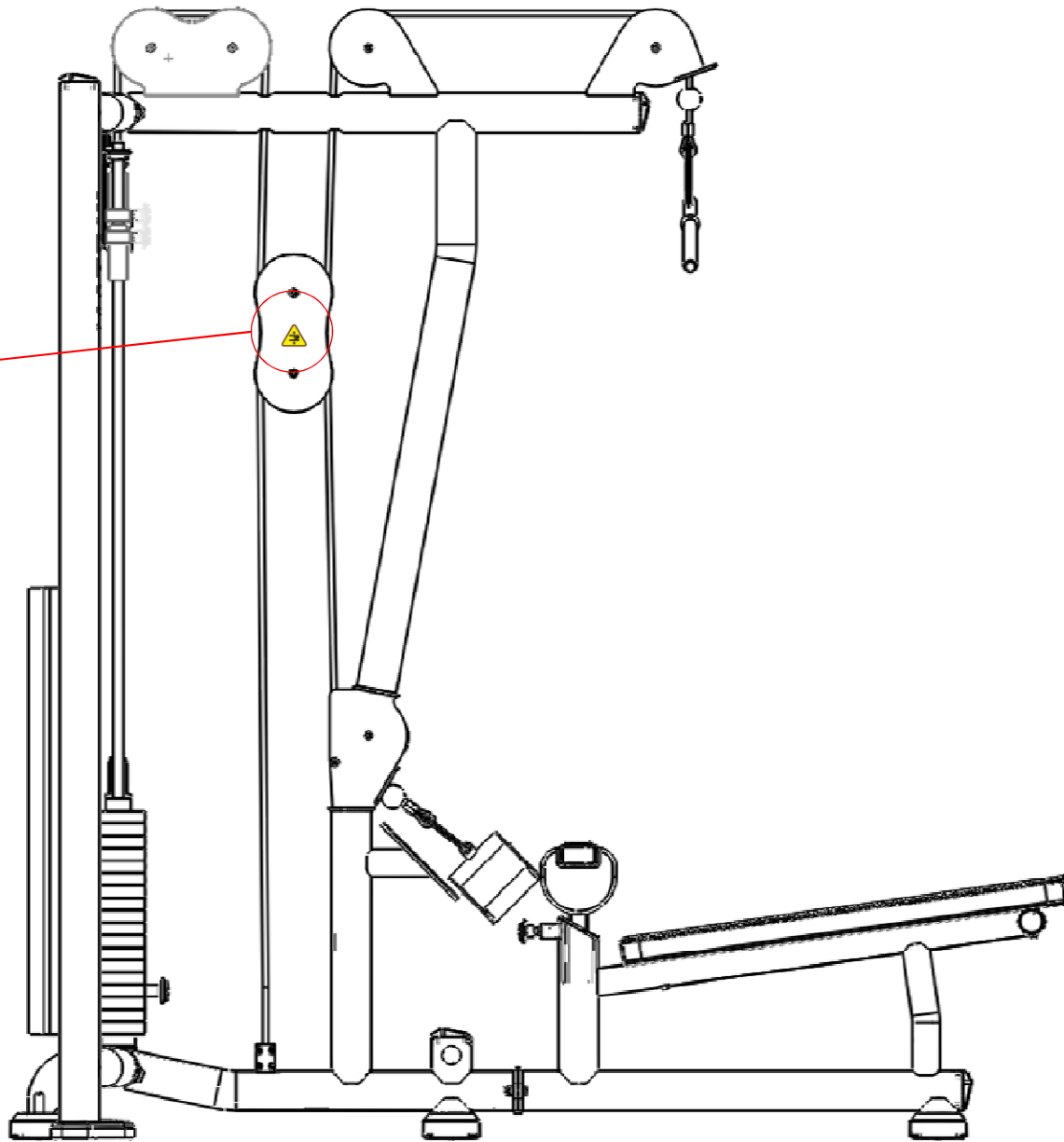

Front

MATRIX

854 - 044
280 mm Matrix

9" [229mm]

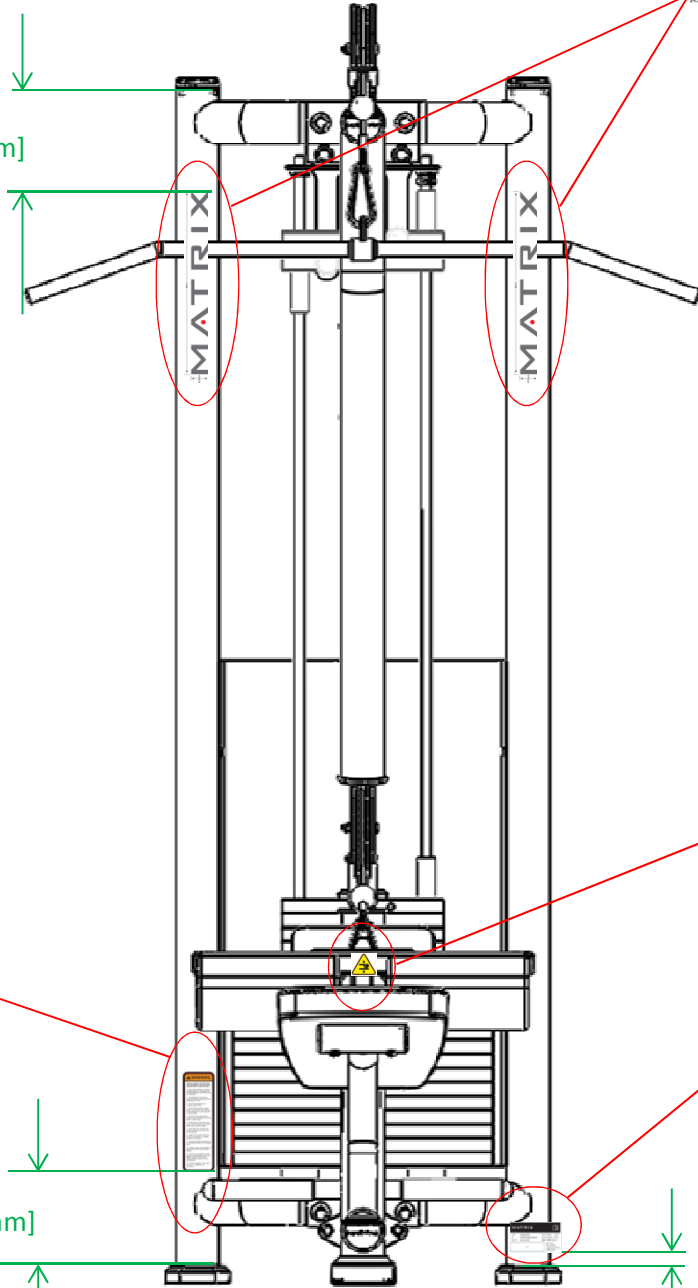

854-985
Pinch
hazard



862-040
Serial plate
Non - EN

MATRIX		
Model: XXXXXXXXXX	Max User Weight: XXX lbs	
S/N: XXXXXXXXXXXXXXXXXX	Max Training Weight: XXX lbs	
Mfg Date: XX-XX-XXXX	EN957-1, EN957-2 Class B	
Matrix Fitness 1600 Landmark Dr Cottage Grove, WI 53527 (800) 693-4063		
UPC		

WARNING

SEVERE INJURY CAN OCCUR ON THIS EQUIPMENT IF YOU DO NOT FOLLOW THESE PRECAUTIONS TO AVOID INJURY.

1. Never allow children or untrained persons to use this equipment. Always read the instructions and follow them carefully.
2. All warnings and instructions should be read and proper instructions followed prior to use.
3. Use this equipment for its intended purpose ONLY.
4. NEVER allow resistance drops, knees or other parts to be allowed to hit equipment, as this may result in serious injury.
5. NEVER use this equipment for support during climbing, as this may result in serious injury.
6. Clear exercise if you feel heat or fatigue. Obtain a medical exam before beginning an exercise program.
7. Keep neck, hair, clothing, and items accessories free and clear of all moving parts.
8. Inspect the machine before use. DO NOT use machine if it appears damaged or inoperative.
9. Check to see that the weight is properly inserted into the weight stack.
10. NEVER use the machine with the weight stack pinned in an elevated position.
11. NEVER use dumbbells or other weights to intentionally increase the weight resistance. Only use the manufacturer's weight from the manufacturer directly from the manufacturer.
12. DO NOT REMOVE THIS LABEL, REPLACE IF DAMAGED OR ILLEGIBLE.

854-987
Single
Station

8" [203mm]

1" [25mm]

Front

Matrix QC template

854 - 043
166mm Matrix

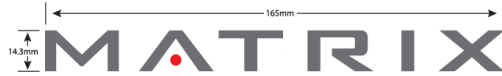

854 - 044
280 mm Matrix



854-857
Serial plate

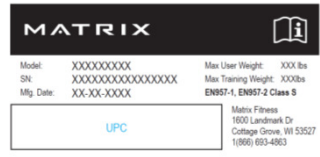

862-040
Serial plate
Non - EN



854-985
Pinch
hazard



854-986
Moving
hazard



Weight horn caps

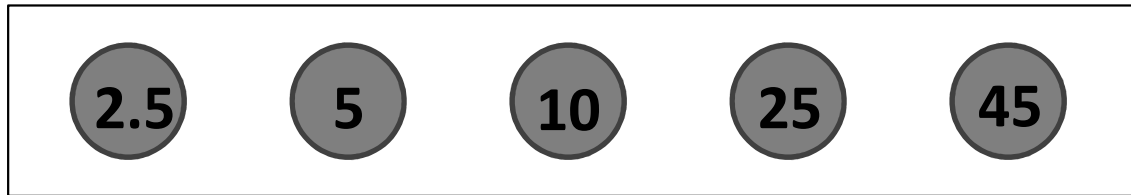

854-982
Bolt down



854-984
Sled L Press

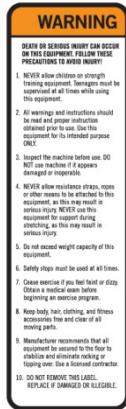

854-978
Oly bench

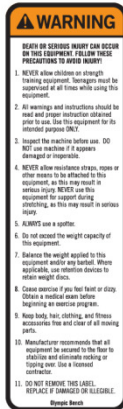

854-983
W bench

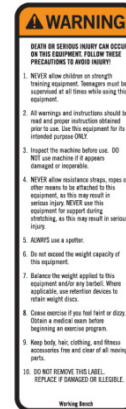

854-981
Smith
Machine



854-987
Single
Station

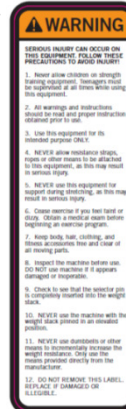

854-979
ADJ stop 1



854-980
ADJ stop 2

